

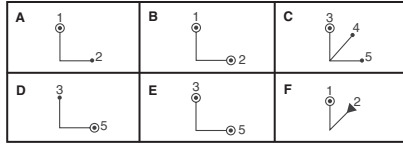

## Keylock Switches KO Series

Materials: • Housing and Cylinder: Die cast zinc alloy • Mounting nut and two keys

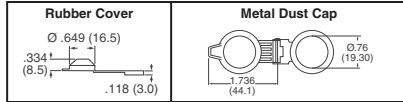

● = Detent Position    ○ = Keypull Possible    ▲ = Momentary

Series	Rated Voltage	Rated Current	Insulation Resistance
KO103	1A @ 125VAC; 0.5A @ 250VAC	200mA min.	200MΩ min.
KO106	1A @ 125VAC; 0.5A @ 250VAC	200mA min.	200MΩ min.
KO129	4A @ 125VAC; 2A @ 250VAC	200mA min.	200MΩ min.
KO130	4A @ 125VAC; 2A @ 250VAC	200mA min.	200MΩ min.

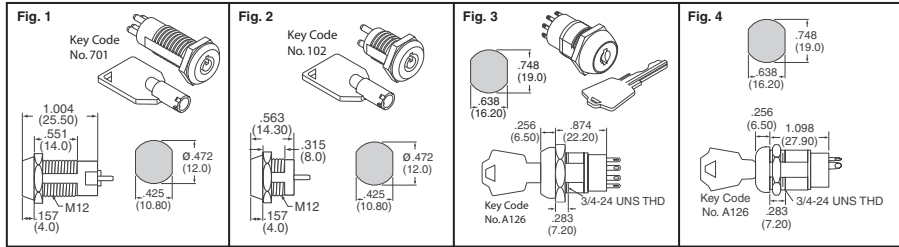

Fig.	Lock Configuration	No. of Poles	Key Pull Possible	Switch Type	Amp Rating @ 125 VAC	Termination	Digi-Key Part No.	Price Each	10	100	E-Switch Part No.
1A	90° Indexing	SPDT	1	On-On	1	Solder	EG2623-ND	5.21	4.65	4.01	KO103C701
1B	90° Indexing	SPDT	1 and 2	On-On	1	Solder	EG2624-ND	5.15	4.61	3.97	KO103D701
2B	90° Indexing	SPST	1 and 2	Off-On	1	Solder	EG2625-ND	2.50	2.24	1.93	KO106A102
3C	45°-45° Indexing	SP-3 pos.	3	On-On-On	4	Eyelet	EG2626-ND	9.77	8.72	7.52	KO130AA126
3C	45°-45° Indexing	DP-3 pos.	3	On-On-On	4	Eyelet	EG2627-ND	10.36	9.25	7.98	KO130BA126
3D	90° Indexing	DPDT	3	On-On	4	Eyelet	EG2628-ND	9.77	8.72	7.52	KO130QA126
3E	90° Indexing	SPDT	3 and 5	On-On	4	Eyelet	EG2629-ND	9.77	8.72	7.52	KO130RA126
4F	45° Indexing	SPDT	1	On-Mom	4	Eyelet	EG2630-ND	9.31	8.31	7.16	KO129E

Covers											
Rubber Cover for KO103 Series							EG2631-ND	.70	.63	.54	KOC1
Metal Dust Cap for KO130 Series							EG2632-ND	3.34	2.98	2.57	KOM4

Replacement Keys											
Replacement Key, Keycode 701							EG4405-ND	.89	.79	.68	KOKEY701
Replacement Key, Keycode A126							EG4406-ND	.89	.79	.68	KOKEYA126
Replacement Key, Keycode 102							EG4407-ND	.89	.79	.68	KOKEY102



## Keylock Switches



Features: • **SK series:** Short behind panel dimension - only 1.063" (27.0mm); Detent mechanism gives crisp, positive action for accurate switch setting • **CK series** High insulating material withstands over 15 kilovolts of electrostatic discharge, thus providing antistatic feature. Rugged, die cast housing designed for higher security requirements • **Specifications:** • Power Voltage: 3A @ 250V AC • Operating Temperature: -25°C ~ 70°C • Mechanical Life: 30,000 cycles minimum • Electrical Life: 10,000 cycles minimum • Materials: • Housing/Bushing: Zinc alloy with chrome plating for CKL series; Glass fiber reinforced PBT for CKM series

Fig.	Pos. 1	Pos. 2	Pos. 3	Key Removable Positions	Digi-Key Part No.	Price Each	1	25	100	NKK Part No.
<b>12mm Miniature Low Security (All same Keycodes)</b>										
1	On	None	On	1, 3	360-1935-ND	9.68	7.02	6.25		SK12AAW01-RO
	On	None	On	1	360-1936-ND	9.68	7.02	6.25		SK12BAW01-RO
	On	Off	On	1, 2, 3	360-1937-ND	9.98	7.26	6.58		SK13DAW01-RO
	On	Off	On	2	360-1938-ND	9.98	7.26	6.58		SK13EAW01-RO
	Replacement Key for SK12 Switches, Marked 1201					360-1010-ND	1.98	1.22	1.09	
Replacement Key for SK13 Switches, Marked 1301					360-2289-ND	1.98	1.22	1.09		AT4082
<b>16mm High Security Antistatic - Flat Key Version (10 Keycodes)</b>										
2	On	None	On	1, 3	360-1447-ND	9.53	6.90	6.14		CKM12AFW01
	On	None	On	1	360-1448-ND	9.53	6.90	6.14		CKM12BFW01
	On	Off	On	2	360-1449-ND	10.29	7.49	6.78		CKM13EFW01
<b>16mm High Security Antistatic - Tubular Key Version (25 Keycodes)</b>										
2	On	None	On	1, 3	360-1450-ND	9.53	6.90	6.14		CKM12ATW01
	On	None	On	1	360-1451-ND	9.53	6.90	6.14		CKM12BTW01
	On	Off	On	2	360-1452-ND	10.29	7.49	6.78		CKM13ETW01
<b>19mm High Security - Flat Key Version (25 Keycodes)</b>										
3	On	None	On	1, 3	360-1453-ND	9.67	7.01	6.24		CKL12AFW01
	On	None	On	1	360-1454-ND	9.67	7.01	6.24		CKL12BFW01
	On	Off	On	2	360-1455-ND	10.43	7.59	6.88		CKL13EFW01
<b>19mm High Security - Tubular Key Version (50 Keycodes)</b>										
3	On	None	On	1, 3	360-1456-ND	9.67	7.01	6.24		CKL12ATW01
	On	None	On	1	360-1457-ND	9.67	7.01	6.24		CKL12BTW01
	On	Off	On	2	360-1458-ND	10.43	7.59	6.88		CKL13ETW01

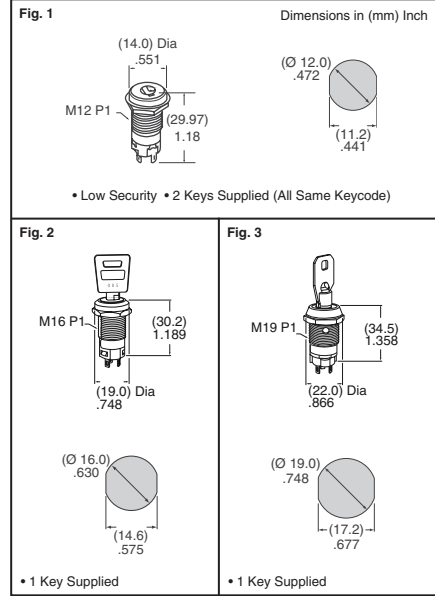

## Keylock Switchlocks



Authorized Distributor

Note: All Keylocks are supplied with 2 brass keys on a ring.

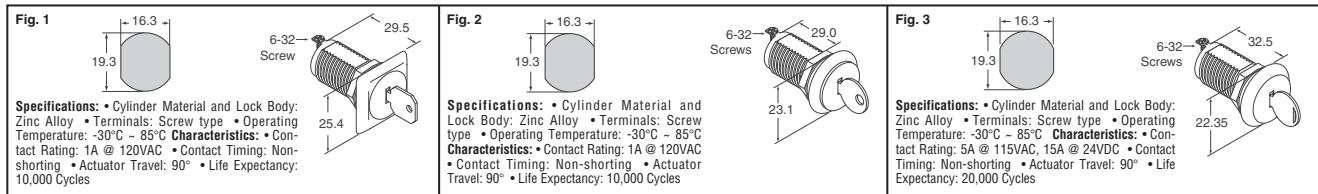

Fig.	Lock Configuration	Poles	Keypull Possible	Switch Type	Current	Terminal	Digi-Key Part No.	Price Each	1	10	25	50	Tyco Electronics Part No.
1	90° Indexing	SPST	1, 2	On-Off On-Off Off-Mom	1A	6-32 Screw	450-1003-ND	12.47	11.40	10.69	10.33		2SKF132AEL01
			1 only				450-1005-ND	12.23	11.19	10.49	10.14	2SKF131AEL01	
			1 only				450-1008-ND	17.18	15.71	14.73	14.24	2SKF231AEL01	
2	90° Indexing	SPST	1, 2	On-Off On-Off Off-Mom	1A	6-32 Screw	450-1004-ND	13.40	12.26	11.49	11.11		2SWK132AL101
			1 only				450-1006-ND	15.89	14.54	13.63	13.17	2SWK131AL101	
			1 only				450-1007-ND	11.78	10.77	10.10	9.76	2SWK231AL101	
3	90° Indexing	SPST	1, 2	On-Off	5A	6-32 Screw	450-1011-ND	15.06	13.77	12.91	12.48		SWK12F315
			2 only				450-1010-ND	15.06	13.77	12.91	12.48	SWK121F315	
			1 only				450-1009-ND	15.06	13.77	12.91	12.48	SWK123F315	

Free shipping on orders over £50! All prices are in British pound sterling and include duties.

uk.digikey.com — FREEPHONE: 0-800-587-0991 • 0-800-904-7786 — FREEFAX: 0-800-587-0992 • 0-800-904-7783

(UK091) 2053