

FSF and FST Series 5x20mm Miniature Fuses

Specifications: • Rated Voltage: 250VAC • Ambient Temperature Range: -55°C ~ 125°C • Tube Material: Glass • End Cap Material: Nickel plated copper alloy

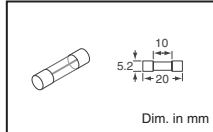

Current Rating (A)	Pre-Arcing Rating			
	1.5 x In (Min.)	2.1 x In (Max.)	2.75 x In (Max.)	10.0 x In (Max.)
FSF Series				
0.25 - 6.3 8 - 10	60 min. 30 min.	30 min. 30 min.	2 sec. 2 sec.	20 msec. 40 msec.
FST Series				
0.02 0.32 - 6.3 8 - 20	60 min. 60 min. 30 min.	120 sec. 120 sec.	10 sec. 10 sec.	300msec. 300 msec. 300 msec.

Rated Current (A)	Breaking Capacity @250VAC	Digi-Key Part No.	Pricing			Schurter Part No.
FSF Series — Fast Acting						
1	25	50				
0.25	35A	486-1230-ND	.65	13.10	23.59	0034.1510
0.315	35A	486-1231-ND	.65	13.10	23.59	0034.1511
0.4	35A	486-1232-ND	.65	13.10	23.59	0034.1512
0.5	35A	486-1233-ND	.17	3.27	5.88	0034.1513
1.0	35A	486-1234-ND	.17	3.27	5.88	0034.1516
1.6	35A	486-1235-ND	.17	3.27	5.88	0034.1518
2.0	35A	486-1236-ND	.17	3.27	5.88	0034.1519
2.5	35A	486-1237-ND	.17	3.27	5.88	0034.1520
3.15	35A	486-1238-ND	.17	3.27	5.88	0034.1521
4.0	10In.	486-1239-ND	.17	3.27	5.88	0034.1522
5.0	10In.	486-1240-ND	.17	3.27	5.88	0034.1523
6.3	10In.	486-1241-ND	.23	4.65	8.36	0034.1524
8.0	10In.	486-1242-ND	.23	4.65	8.36	0034.1525
10.0	10In.	486-1243-ND	.23	4.65	8.36	0034.1526
FST Series — Time Lag						
0.02	35A	486-1326-ND†	4.24	84.80	152.63	0034.3101
0.032	35A	486-1327-ND†	4.24	84.80	152.63	0034.3102
0.04	35A	486-1328-ND	4.24	84.80	152.63	0034.3103
0.05	35A	486-1329-ND	.38	7.51	13.53	0034.3104
0.063	35A	486-1330-ND	.38	7.51	13.53	0034.3105
0.08	35A	486-1331-ND	.38	7.51	13.53	0034.3106
0.1	35A	486-1332-ND	.38	7.51	13.53	0034.3107
0.125	35A	486-1333-ND	.38	7.51	13.53	0034.3108
0.16	35A	486-1334-ND	.23	4.57	8.23	0034.3109
0.2	35A	486-1335-ND	.23	4.57	8.23	0034.3110
0.25	35A	486-1214-ND	.38	7.66	13.79	0034.3111
0.315	35A	486-1215-ND	.23	4.57	8.23	0034.3112
0.4	35A	486-1216-ND	.23	4.57	8.23	0034.3113
0.5	35A	486-1217-ND	.23	4.57	8.23	0034.3114
0.63	35A	486-1336-ND	.23	4.57	8.23	0034.3115
0.8	35A	486-1337-ND	.23	4.57	8.23	0034.3116
1.0	35A	486-1338-ND	.23	4.57	8.23	0034.3117
1.25	35A	486-1339-ND	.23	4.57	8.23	0034.3118
1.4	35A	486-1340-ND†	.95	19.06	34.30	0034.3165
1.6	35A	486-1218-ND	.23	4.57	8.23	0034.3119
2.0	35A	486-1219-ND	.23	4.57	8.23	0034.3120
2.5	35A	486-1220-ND	.23	4.57	8.23	0034.3121
3.15	35A	486-1221-ND	.23	4.57	8.23	0034.3122
4.0	10In.	486-1222-ND	.23	4.57	8.23	0034.3123
5.0	10In.	486-1223-ND	.23	4.57	8.23	0034.3124
6.3	10In.	486-1224-ND	.23	4.57	8.23	0034.3125
8.0	10In.	486-1225-ND	.23	4.57	8.23	0034.3126
10	10In.	486-1226-ND	.23	4.57	8.23	0034.3127
12.5	125A	486-1227-ND†	.38	7.51	13.53	0034.3128
16	125A	486-1228-ND†	.38	7.51	13.53	0034.3129
20	125A	486-1229-ND†	.38	7.51	13.53	0034.3130

† Not VDE Approved

UMT 250 and USI 1206 Series Surface Mount Fuses

UMT 250 Series
Specifications: • Rated Voltage: 250VAC, 125VDC • Ambient Temperature Range: -55°C ~ 125°C • Housing Material: Ceramic • Terminal Material: Tin-plated copper alloy

USI 1206 Series
Specifications: • Rated Voltage: 32VAC, 63VDC • Ambient Temperature Range: -55°C ~ 90°C • Housing Material: Epoxy glass • Terminal Material: Tin-plated copper alloy

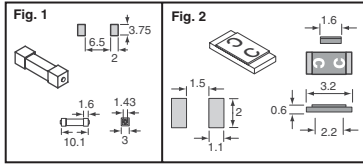

Series	Pre-Arcing Rating			
	1.25 x In (Min.)	2.0 x In (Max.)	10.0 x In (Min.)	10.0 x In (Max.)
UMT 250	60 min.	120 sec.	10 msec.	100 msec.
USI 1206	60 min.	120 sec.	1 msec.	10 msec.

Rated Current (A)	Breaking Capacity (A)	Digi-Key Part No.	Price Each			Tape and Reel† Pricing 1,000	Schurter Part No.
Fig. 1 — UMT 250 Series — 10.1mm x 3mm Time Lag							
1	25	50					
0.5	35@250VDC	486-1245-ND	.68	.55	.50	—	3403.0163.11
0.8	35@250VDC	486-1246-ND	.68	.55	.50	—	3403.0165.11
1.0	35@250VDC	486-1247-ND	.68	.55	.50	—	3403.0166.11
1.25	35@250VDC	486-1248-ND	.68	.55	.50	—	3403.0167.11
1.6	35@250VDC	486-1249-ND	.68	.55	.50	—	3403.0168.11
2.0	35@250VDC	486-1250-ND	.68	.55	.50	—	3403.0169.11

Rated Current (A)	Breaking Capacity (A)	Digi-Key Part No.	Price Each			Tape & Reel† Pricing 1,000	Schurter Part No.
			1	25	50		
2.5	35@250VDC	486-1251-ND	.68	.55	.50	—	3403.0170.11
3.15	35@250VDC	486-1252-ND	.68	.55	.50	—	3403.0171.11
4.0	35@250VDC	486-1253-ND	.68	.55	.50	—	3403.0172.11
5.0	100@250VDC	486-1139-ND†	.76	.61	.55	—	3403.0173.11
6.3	100@250VDC	486-1140-ND†	.76	.61	.55	—	3403.0174.11

Fig. 2 — USI 1206 Series — 3.2mm x 1.6mm Fast Acting

0.5	63@63VDC	486-1141-1-ND	.52	.45	.40	198.20	3413.0213.22
0.63	63@63VDC	486-1142-1-ND	.52	.45	.40	198.20	3413.0214.22
0.8	63@63VDC	486-1143-1-ND	.52	.45	.40	198.20	3413.0215.22
1.0	63@63VDC	486-1144-1-ND	.52	.45	.40	198.20	3413.0216.22
1.25	63@63VDC	486-1145-1-ND	.52	.45	.40	198.20	3413.0217.22
1.6	63@63VDC	486-1146-1-ND	.52	.45	.40	198.20	3413.0218.22
2.0	63@63VDC	486-1147-1-ND	.52	.45	.40	198.20	3413.0219.22
2.5	63@63VDC	486-1148-1-ND	.52	.45	.40	198.20	3413.0220.22
3.15	63@63VDC	486-1149-1-ND	.52	.45	.40	198.20	3413.0221.22
4.0	63@63VDC	486-1150-1-ND	.52	.45	.40	198.20	3413.0222.22
5.0	63@63VDC	486-1151-1-ND	.52	.45	.40	198.20	3413.0223.22
6.3	63@63VDC	486-1152-1-ND	.52	.45	.40	198.20	3413.0224.22

† VDE Approval Only ‡ For Tape and Reel part number, change 1-ND to 2-ND.

PCB and Panel Mount Fuseholders

Dim. in mm

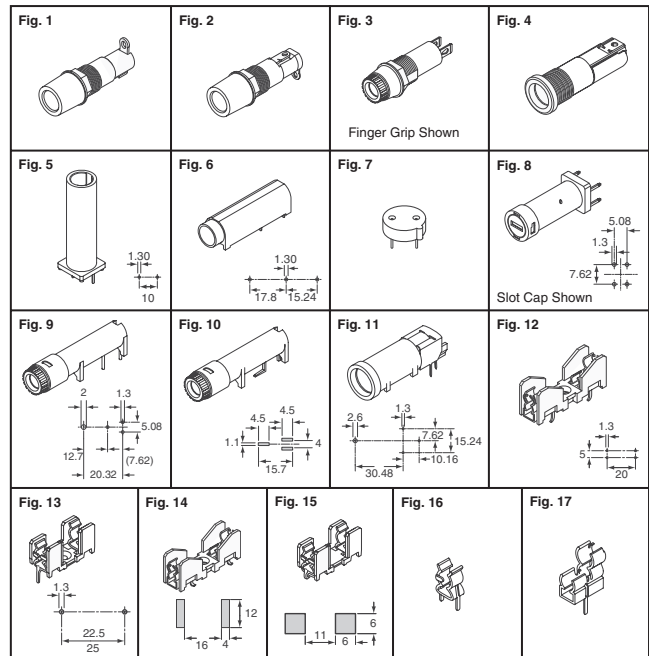

Fig.	Type	Fuse-Link (mm)	Rated Current (A)	Rated Voltage	Digi-Key Part No.	Price Each			Schurter Part No.
Panel Mount Types — IP40 Rating, Solder Terminals									
FEU (Grip) Series									
1	Holder	5x20 or 6.3x32	10	250	486-1167-ND	1.10	.88	.80	0031.1801
	Holder, Slot Cap	5x20	10	250	486-1168-ND	1.23	.99	.89	0031.1811
2	Holder	5x20 or 6.3x32	10	250	486-1164-ND	1.10	.88	.80	0031.1653
	Slot Knob Cap	5x20	10	250	486-1165-ND	.60	.49	.44	0031.1663
	Slot Knob Cap	6.3x32	10	250	486-1166-ND	.58	.47	.42	0031.1666
FIG1, FIG2 and FIG3 Series									
3	Holder, Slot Cap	5x20	10	250	486-1153-ND	1.84	1.48	1.33	3101.0010
	Holder, Finger Grip	5x20	10	250	486-1154-ND	1.84	1.48	1.33	3101.0015
	Holder, Slot Cap	5x20	10	250	486-1155-ND‡	1.84	1.48	1.33	3101.0020
	Holder, Finger Grip	5x20	10	250	486-1156-ND‡	1.84	1.48	1.33	3101.0025
	Holder, Slot Cap	5x20	10	250	486-1157-ND§	1.84	1.48	1.33	3101.0030
	Holder, Finger Grip	5x20	10	250	486-1158-ND	1.84	1.48	1.33	3101.0035
FUL Series									
4	Holder	5x20 or 6.3x32	16	500	486-1254-ND	4.04	3.24	2.91	0031.2307
	Slot Knob Cap	5x20	16	500	486-1255-ND	3.65	2.93	2.64	0031.2323
PCB Mount Types — Solder Terminals									
FAC Series — IP40 Rating									
5	Holder	5x20 or 6.3x32	10	250	486-1257-ND	1.33	1.06	.96	0031.3803
FAU Series — IP40 Rating									
6	Holder	5x20 or 6.3x32	10	250	486-1256-ND	1.11	.89	.80	0031.3573
FMS Series — IP30 Rating									
7	Holder	—	6.3	250	486-1244-ND†	.45	.36	.33	0031.7601

‡ Rear Panel Mount § Snap-In Type † Not VDE Approved

(Continued)

Free shipping on orders over £50! All prices are in British pound sterling and include duties.