



**RL181S Series: Features:** • Ferrite shield for low radiation • High Q • High reliability, high efficiency  
**Operating temperature:** -55°C ~ 105°C **Applications:** • Switch mode power supplies • DC-DC converters  
 • Desktop, notebook computers, servers • Digital TV, DVD, cable modems, DSS set-top boxes • Battery chargers • Output chokes • EMI filters

**RL187 Series: Features:** • High Q • High reliability, high efficiency • Winding covered with shrink tubing  
**Operating temperature:** -55°C ~ 105°C **Applications:** • Switch mode power supplies • DC-DC converters  
 • Desktop, notebook computers, servers • Digital TV, DVD, cable modems, DSS set-top boxes • Battery chargers • Output chokes • EMI filters

**RL262 Series: Features:** • High Q • High reliability, high efficiency • Winding covered with shrink tubing  
**Operating temperature:** -55°C ~ 105°C **Applications:** • Switch mode power supplies • DC-DC converters  
 • Desktop, notebook computers, servers • Digital TV, DVD, cable modems, DSS set-top boxes • Battery chargers • Output chokes • EMI filters

**RL622 Series: Features:** • High current capacity • Ferrite bobbin core • Low core loss • High reliability, high efficiency  
**Operating temperature:** -55°C ~ 105°C **Applications:** • Switch mode power supplies • DC-DC converters • Desktop, notebook computers, servers • Digital TV, DVD, cable modems, DSS set-top boxes • Battery chargers • Output chokes • EMI filters

**RL822 Series: Features:** • High current capacity • Ferrite bobbin core • Low core loss • High reliability, high efficiency  
**Operating temperature:** -55°C ~ 105°C **Applications:** • Switch mode power supplies • DC-DC converters • Desktop, notebook computers, servers • Digital TV, DVD, cable modems, DSS set-top boxes • Battery chargers • Output chokes • EMI filters

**RL824 Series: Features:** • High current capacity • Ferrite bobbin core • Low core loss • High reliability, high efficiency  
**Operating temperature:** -55°C ~ 105°C **Applications:** • Switch mode power supplies • DC-DC converters • Desktop, notebook computers, servers • Digital TV, DVD, cable modems, DSS set-top boxes • Battery chargers • Output chokes • EMI filters

**E**

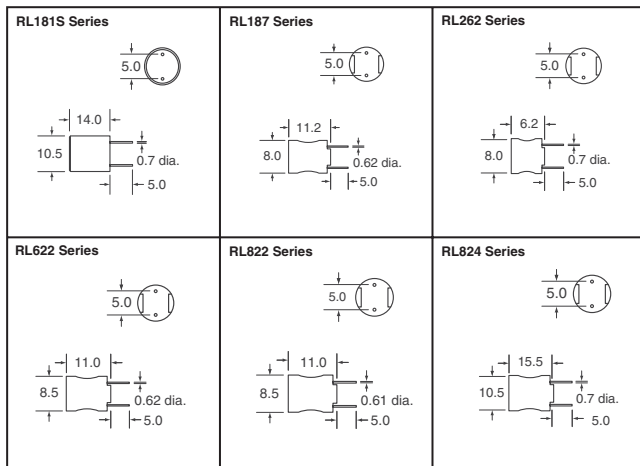

L (µH) ±5% @1kHz	Q (Min.) @50kHz	Test Freq. (kHz)	SRF (MHz) Min.	DCR (Ω) Max.	I, DC (mA)	Digi-Key Part No.	Price Each					J.W. Miller Part No.
RL181S Series							1	10	25	50	100	
1500	70	—	0.64	4.0	70	M10065-ND	1.44	1.08	.81	.72	.63	RL181S-152J-RC
3300	100	—	0.44	6.1	50	M10066-ND	1.44	1.08	.81	.72	.63	RL181S-332J-RC
5600	100	—	0.35	8.4	40	M10068-ND	1.44	1.08	.81	.72	.63	RL181S-562J-RC
15000	100	—	0.22	15.0	22	M10071-ND	1.44	1.08	.81	.72	.63	RL181S-153J-RC
18000	100	—	0.19	17.0	21	M10072-ND	1.44	1.08	.81	.72	.63	RL181S-183J-RC
33000	100	—	0.16	26.0	17	M10074-ND	1.44	1.08	.81	.72	.63	RL181S-333J-RC
39000	100	—	0.12	45.0	15	M10075-ND	1.44	1.08	.81	.72	.63	RL181S-393J-RC
47000	100	—	0.12	52.0	13	M10076-ND	1.44	1.08	.81	.72	.63	RL181S-473J-RC
100000	100	—	0.09	82.0	9	M10077-ND	1.44	1.08	.81	.72	.63	RL181S-104J-RC
RL187 Series												
100	80	796	5.3	2.0	200	M10038-ND	.86	.69	.52	.43	.35	RL187-101J-RC
330	80	796	2.3	4.0	200	M10041-ND	.86	.69	.52	.43	.35	RL187-331J-RC
390	80	796	2.1	4.0	200	M10042-ND	.86	.69	.52	.43	.35	RL187-391J-RC
470	80	796	1.9	4.0	200	M10043-ND	.86	.69	.52	.43	.35	RL187-471J-RC
560	80	796	1.7	4.0	200	M10044-ND	.86	.69	.52	.43	.35	RL187-561J-RC
820	80	796	1.4	6.0	200	M10046-ND	.86	.69	.52	.43	.35	RL187-821J-RC
1200	90	252	1.2	9.0	150	M10048-ND	.86	.69	.52	.43	.35	RL187-122J-RC
5600	90	252	0.5	18	50	M10055-ND	.86	.69	.52	.43	.35	RL187-562J-RC
6800	90	252	0.5	26	50	M10056-ND	.86	.69	.52	.43	.35	RL187-682J-RC
8200	90	252	0.4	26	50	M10057-ND	.86	.69	.52	.43	.35	RL187-822J-RC
18000	100	79.6	0.3	60	30	M10060-ND	.86	.69	.52	.43	.35	RL187-183J-RC
22000	100	79.6	0.3	80	30	M10061-ND	.86	.69	.52	.43	.35	RL187-223J-RC
27000	100	79.6	0.3	80	30	M10062-ND	.86	.69	.52	.43	.35	RL187-273J-RC

L (µH) ±5% @1kHz	Q (Min.) @50kHz	Test Freq. (kHz)	SRF (MHz) Min.	DCR (Ω) Max.	I, DC (mA)	Digi-Key Part No.	Price Each					J.W. Miller Part No.
RL262 Series							1	10	25	50	100	
470	60	796	3.2	5.0	100	M10031-ND	.86	.69	.52	.43	.35	RL262-471J-RC
2200	80	252	1.5	14.0	50	M10034-ND	.86	.69	.52	.43	.35	RL262-222J-RC
8200	80	252	0.6	45.0	30	M10035-ND	.86	.69	.52	.43	.35	RL262-822J-RC
10000	60	79.6	0.6	55.0	20	M10036-ND	.86	.69	.52	.43	.35	RL262-103J-RC
RL622 Series												
1.0	20	7.96	150	0.013	10	M9975-ND	.82	.66	.49	.41	.33	RL622-1R0K-RC
1.5	20	7.96	130	0.016	8.5	M9976-ND	.82	.66	.49	.41	.33	RL622-1R5K-RC
2.2	20	7.96	100	0.021	6.5	M9977-ND	.82	.66	.49	.41	.33	RL622-2R2K-RC
3.3	20	7.96	79	0.025	5.5	M9978-ND	.82	.66	.49	.41	.33	RL622-3R3K-RC
4.7	20	7.96	51	0.030	4.3	M9979-ND	.82	.66	.49	.41	.33	RL622-4R7K-RC
6.8	20	7.96	29	0.035	3.7	M9980-ND	.82	.66	.49	.41	.33	RL622-6R8K-RC
10	50	2.52	14	0.045	3.0	M9981-ND	.82	.66	.49	.41	.33	RL622-100K-RC
12	50	2.52	13	0.050	2.7	M9982-ND	.82	.66	.49	.41	.33	RL622-120K-RC
15	40	2.52	12	0.056	2.3	M9983-ND	.82	.66	.49	.41	.33	RL622-150K-RC
18	40	2.52	11	0.061	2.2	M9984-ND	.82	.66	.49	.41	.33	RL622-180K-RC
22	40	2.52	9.2	0.070	2.0	M9985-ND	.82	.66	.49	.41	.33	RL622-220K-RC
27	30	2.52	8.5	0.080	1.7	M9986-ND	.82	.66	.49	.41	.33	RL622-270K-RC
33	30	2.52	7.8	0.090	1.6	M9987-ND	.82	.66	.49	.41	.33	RL622-330K-RC
39	30	2.52	6.9	0.10	1.5	M9988-ND	.82	.66	.49	.41	.33	RL622-390K-RC
47	30	2.52	6.5	0.16	1.4	M9989-ND	.82	.66	.49	.41	.33	RL622-470K-RC
56	30	2.52	5.4	0.18	1.3	M9990-ND	.82	.66	.49	.41	.33	RL622-560K-RC
68	30	2.52	4.9	0.21	1.2	M9991-ND	.82	.66	.49	.41	.33	RL622-680K-RC
82	30	2.52	4.1	0.23	1.1	M9992-ND	.82	.66	.49	.41	.33	RL622-820K-RC
100	20	7.96	3.7	0.28	0.91	M9993-ND	.82	.66	.49	.41	.33	RL622-101K-RC
120	20	7.96	3.4	0.32	0.84	M9994-ND	.82	.66	.49	.41	.33	RL622-121K-RC
150	20	7.96	3.2	0.37	0.75	M9995-ND	.82	.66	.49	.41	.33	RL622-151K-RC
180	20	7.96	2.8	0.58	0.69	M9996-ND	.82	.66	.49	.41	.33	RL622-181K-RC
220	20	7.96	2.7	0.65	0.64	M9997-ND	.82	.66	.49	.41	.33	RL622-221K-RC
270	20	7.96	2.4	0.75	0.57	M9998-ND	.82	.66	.49	.41	.33	RL622-271K-RC
330	20	7.96	2.3	0.85	0.54	M9999-ND	.82	.66	.49	.41	.33	RL622-331K-RC
390	20	7.96	2.1	1.0	0.48	M10000-ND	.82	.66	.49	.41	.33	RL622-391K-RC
470	20	7.96	1.9	1.1	0.46	M10001-ND	.82	.66	.49	.41	.33	RL622-471K-RC
560	20	7.96	1.8	1.4	0.41	M10002-ND	.82	.66	.49	.41	.33	RL622-561K-RC
680	20	7.96	1.6	1.6	0.38	M10003-ND	.82	.66	.49	.41	.33	RL622-681K-RC
820	20	7.96	1.5	1.8	0.35	M10004-ND	.82	.66	.49	.41	.33	RL622-821K-RC
1000	50	0.252	1.3	2.9	0.29	M10005-ND	.82	.66	.49	.41	.33	RL622-102K-RC
1200	50	0.252	1.1	4.0	0.13	M10006-ND	.82	.66	.49	.41	.33	RL622-122K-RC
1500	20	0.252	1.0	6.1	0.08	M10007-ND	.82	.66	.49	.41	.33	RL622-152K-RC
1800	20	0.252	1.0	6.4	0.08	M10008-ND	.82	.66	.49	.41	.33	RL622-182K-RC
2200	20	0.252	0.9	6.8	0.08	M10009-ND	.82	.66	.49	.41	.33	RL622-222K-RC
2700	20	0.252	0.9	7.7	0.08	M10010-ND	.82	.66	.49	.41	.33	RL622-272K-RC
3300	20	0.252	0.7	9.0	0.08	M10011-ND	.82	.66	.49	.41	.33	RL622-332K-RC
4700	20	0.252	0.5	16.0	0.05	M10013-ND	.82	.66	.49	.41	.33	RL622-472K-RC
5600	20	0.252	0.4	18.0	0.05	M10014-ND	.82	.66	.49	.41	.33	RL622-562K-RC
6800	20	0.252	0.4	19.0	0.05	M10015-ND	.82	.66	.49	.41	.33	RL622-682K-RC
8200	20	0.252	0.3	21.0	0.05	M10016-ND	.82	.66	.49	.41	.33	RL622-822K-RC
10000	40	0.079	0.3	25.0	0.05	M10017-ND	.82	.66	.49	.41	.33	RL622-103K-RC
15000	40	0.079	0.2	37.0	0.04	M10019-ND	.82	.66	.49	.41	.33	RL622-153K-RC
18000	30	0.079	0.2	40.0	0.04	M10020-ND	.82	.66	.49	.41	.33	RL622-183K-RC
22000	30	0.079	0.1	56.0	0.03	M10021-ND	.82	.66	.49	.41	.33	RL622-223K-RC
39000	30	0.079	0.1	80.0	0.03	M10024-ND	.82	.66	.49	.41	.33	RL622-393K-RC
47000	20	0.079	0.1	99.0	0.03	M10025-ND	.82	.66	.49	.41	.33	RL622-473K-RC
56000	20	0.079	0.1	135.0	0.02	M10026-ND	.82	.66	.49	.41	.33	RL622-563K-RC
68000	20	0.079	0.1	150.0	0.02	M10027-ND	.82	.66	.49	.41	.33	RL622-683K-RC
82000	20	0.079	0.1	212.0	0.02	M10028-ND	.82	.66	.49	.41	.33	RL622-823K-RC
100000	20	0.025	0.1	235.0	0.02	M10029-ND	.82	.66	.49	.41	.33	RL622-104K-RC
RL822 Series												
4.7	—	—	51	0.030	2.27	M9959-ND	.86	.69	.52	.43	.35	RL822-4R7K-RC
15	—	—	12	0.058	1.75	M9961-ND	.86	.69	.52	.43	.35	RL822-150K-RC
47	—	—	6.5	0.17	0.79	M9963-ND	.86	.69	.52	.43	.35	RL822-470K-RC
56	—	—	5.4	0.20	0.76	M9964-ND	.86	.69	.52	.43	.35	RL822-560K-RC
100	—	—	3.7	0.28	0.58	M9966-ND	.86	.69	.52	.43	.35	RL822-101K-RC
470	—	—	1.9	1.37	0.25	M9970-ND	.86	.69	.52	.43	.35	RL822-471K-RC
560	—	—	1.8	1.53	0.23	M9971-ND	.86	.69	.52	.43	.35	RL822-561K-RC
680	—	—	1.6	2.00	0.21	M9972-ND	.86	.69	.52	.43	.35	RL822-681K-RC
820	—	—	1.5	2.70	0.18	M9973-ND	.86	.69	.52	.43	.35	RL822-821K-RC
RL824 Series												
15	—	—	25	0.065	1.93	M9944-ND	.94	.71	.54	.48	.42	RL824-150K-RC
120	—	—	2.6	0.19	0.94	M9947-ND	.94	.71	.54	.48	.42	RL824-121K-RC
330	—	—	1.5	0.50	0.56	M9950-ND	.94	.71	.54	.48	.42	RL824-331K-RC
390	—	—	1.4	0.56	0.52	M9951-ND	.94	.71	.54	.48	.42	RL824-391K-RC
680	—	—	1.1	0.79	0.44	M9953-ND	.94	.71	.54	.48	.42	RL824-681K-RC

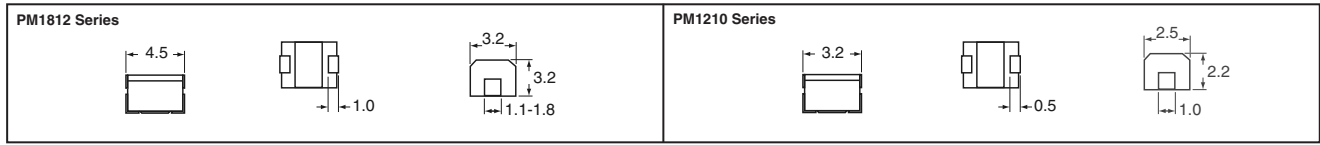

L (µH)	Q Min.	Test Frequency (MHz)	SRF (MHz) Max.	DCR (Ω) Max.	I <sub>dc</sub> (mA)	Digi-Key Part No.	Cut Tape Price Each			Digi-Key Part No.	Tape and Reel		J.W. Miller Part No.
							1	10	100		Qty.	Pricing	
<b>PM1812 Series 10%</b>													
0.10	28.00	25.20	300.00	0.18	800.00	M8526CT-ND	.33	.30	.25	M8526TR-ND	500	48.46	PM1812-R10K-RC
<b>PM1812 Series 5%</b>													
1.00	50.00	7.96	100.00	0.50	450.00	M8527CT-ND	.33	.30	.25	M8527TR-ND	500	48.46	PM1812-1R0J-RC
3.30	50.00	7.96	45.00	0.80	355.00	M8530CT-ND	.33	.30	.25	M8530TR-ND	500	48.46	PM1812-3R3J-RC
10.00	50.00	2.52	20.00	1.60	250.00	M8531CT-ND	.33	.30	.25	M8531TR-ND	500	48.46	PM1812-100J-RC
12.00	50.00	2.52	18.00	2.00	225.00	M8532CT-ND	.33	.30	.25	M8532TR-ND	500	48.46	PM1812-120J-RC
1000.00	30.00	0.796	2.00	2.00	40.00	M8539CT-ND	.33	.30	.25	M8539TR-ND	500	48.46	PM1812-102J-RC
<b>PM1210 Series 5%</b>													
1.00	28.00	7.96	120.00	0.70	400.00	M8540CT-ND	.33	.30	.25	M8540TR-ND	2,000	96.92/M	PM1210-1R0J-RC
1.50	28.00	7.96	85.00	0.85	370.00	M8541CT-ND	.33	.30	.25	M8541TR-ND	2,000	96.92/M	PM1210-1R5J-RC
2.20	30.00	7.96	75.00	1.00	320.00	M8542CT-ND	.33	.30	.25	M8542TR-ND	2,000	96.92/M	PM1210-2R2J-RC
4.70	30.00	7.96	50.00	1.70	220.00	M8543CT-ND	.33	.30	.25	M8543TR-ND	2,000	96.92/M	PM1210-4R7J-RC
5.60	30.00	7.96	47.00	1.80	200.00	M8544CT-ND	.33	.30	.25	M8544TR-ND	2,000	96.92/M	PM1210-5R6J-RC
10.00	30.00	2.52	36.00	2.50	150.00	M8545CT-ND	.33	.30	.25	M8545TR-ND	2,000	96.92/M	PM1210-100J-RC
12.00	30.00	2.52	33.00	2.80	140.00	M8546CT-ND	.33	.30	.25	M8546TR-ND	2,000	96.92/M	PM1210-120J-RC
15.00	30.00	2.52	30.00	3.20	130.00	M8547CT-ND	.33	.30	.25	M8547TR-ND	2,000	96.92/M	PM1210-150J-RC
33.00	30.00	2.52	17.00	5.60	70.00	M8548CT-ND	.33	.30	.25	M8548TR-ND	2,000	96.92/M	PM1210-330J-RC
47.00	30.00	2.52	15.00	7.00	60.00	M8549CT-ND	.33	.30	.25	M8549TR-ND	2,000	96.92/M	PM1210-470J-RC
68.00	30.00	2.52	12.00	9.00	50.00	M8550CT-ND	.33	.30	.25	M8550TR-ND	2,000	96.92/M	PM1210-680J-RC
82.00	30.00	2.52	11.00	10.00	45.00	M8551CT-ND	.33	.30	.25	—	—	—	PM1210-820J-RC
100.00	20.00	0.796	10.00	10.00	40.00	M8552CT-ND	.33	.30	.25	M8552TR-ND	2,000	96.92/M	PM1210-101J-RC
120.00	20.00	0.796	10.00	11.00	70.00	M8553CT-ND	.33	.30	.25	M8553TR-ND	2,000	96.92/M	PM1210-121J-RC
150.00	20.00	0.796	8.00	15.00	65.00	M8554CT-ND	.33	.30	.25	M8554TR-ND	2,000	96.92/M	PM1210-151J-RC
180.00	20.00	0.796	7.00	17.00	60.00	M8555CT-ND	.33	.30	.25	M8555TR-ND	2,000	96.92/M	PM1210-181J-RC
220.00	20.00	0.796	7.00	21.00	50.00	M8556CT-ND	.33	.30	.25	M8556TR-ND	2,000	96.92/M	PM1210-221J-RC



**Surface Mount High Power Inductors**  
PM7232S, PM12639S, PM12645S, PM12651S and PM13560S Series



Features: • Ideal for very high current DC/DC converter output inductors • Magnetically shielded for low radiation • High saturation current • Low DC resistance • Low Profile • Test Frequency: 100kHz • Operating Temperature: -40°C - 150°C

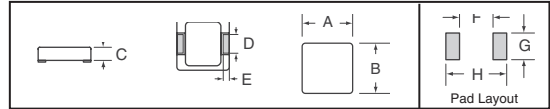

L (µH) ±20%	DCR Ω Max.	I <sub>rated</sub> (A)	Dimensions (mm)								Digi-Key Part No.	Cut Tape Price Each			Digi-Key Part No.	Tape and Reel		J.W. Miller Part No.
			A	B	C	D	E	F	G	H		1	10	100		Qty.	Pricing	
<b>PM7232S Series</b>																		
0.10	0.0011	22	7.2	6.6	3.2	3.5	1.3	3.0	4.0	7.5	M8494CT-ND	1.75	1.60	1.19	M8494TR-ND	1,500	740.52/M	PM7232S-R10M-RC
0.22	0.0017	17	7.2	6.6	3.2	3.5	1.3	3.0	4.0	7.5	M8495CT-ND	1.75	1.60	1.19	M8495TR-ND	1,500	740.52/M	PM7232S-R22M-RC
0.47	0.0030	15	7.2	6.6	3.2	3.5	1.3	3.0	4.0	7.5	M8496CT-ND	1.75	1.60	1.19	M8496TR-ND	1,500	740.52/M	PM7232S-R47M-RC
0.72	0.0080	12.5	7.2	6.6	3.2	3.5	1.3	3.0	4.0	7.5	M8497CT-ND	1.75	1.60	1.19	M8497TR-ND	1,500	740.52/M	PM7232S-R72M-RC
1.5	0.0095	9	7.2	6.6	3.2	3.5	1.3	3.0	4.0	7.5	M8498CT-ND	1.75	1.60	1.19	M8498TR-ND	1,500	740.52/M	PM7232S-1R5M-RC
<b>PM12639S Series</b>																		
1.2	0.0028	18.5	12.6	12.6	3.9	5.8	2.4	6.0	6.5	13.0	M8106CT-ND	2.27	2.06	1.54	—	—	—	PM12639S-1R2M-RC
<b>PM12645S Series</b>																		
1.2	0.0018	21	12.6	12.6	4.5	5.8	2.4	6.0	6.5	13.0	M8107CT-ND	1.84	1.68	1.25	M8107TR-ND	800	622.91	PM12645S-1R2M-RC
2.7	0.0044	15	12.6	12.6	4.5	5.8	2.4	6.0	6.5	13.0	M8109CT-ND	1.84	1.68	1.25	M8109TR-ND	800	622.91	PM12645S-2R7M-RC
<b>PM12651S Series</b>																		
4.7	0.0072	12	12.6	12.6	5.1	5.8	2.4	6.0	6.5	13.0	M8500CT-ND	1.84	1.68	1.25	M8500TR-ND	800	622.91	PM12645S-4R7M-RC
<b>PM13560S Series</b>																		
10	0.0149	7.5	13.0	12.6	5.6	5.8	2.4	6.4	6.5	13.4	M8501CT-ND	1.88	1.71	1.28	M8501TR-ND	500	397.49	PM13560S-6R0M-RC
10	0.0149	7.5	13.0	12.6	5.6	5.8	2.4	6.4	6.5	13.4	M8502CT-ND	1.88	1.71	1.28	M8502TR-ND	500	397.49	PM13560S-100M-RC

**Free shipping on orders over £50! All prices are in British pound sterling and include duties.**

uk.digikey.com — FREEPHONE: 0-800-587-0991 • 0-800-904-7786 — FREEFAX: 0-800-587-0992 • 0-800-904-7783

(UK091) 1443



Features: • Ceramic Core, Wire Wound for Superior Reliability • High Self-Resonant Frequency • Flat Top Surface for Automated Pick and Place

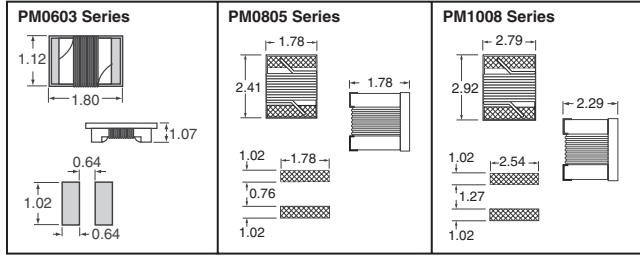

L (nH)	Tol.	Q Min.	L Test Freq. MHz	R, dc Max. Ω	I, dc Max. mA	Digi-Key Part No.	Cut Tape Price Each	T & R* Pricing	J.W. Miller Part No.		
PM0603 Series							1	10	100		
3.9	±0.3nH	22	250	0.08	700	M8489CT-ND	.28	.26	.22	84.95/M	PM0603-3N9-RC
10	±5%	30	250	0.15	700	M8484CT-ND	.28	.26	.22	84.95/M	PM0603-10N-RC
18	±5%	35	250	0.17	700	M8485CT-ND	.28	.26	.22	84.95/M	PM0603-18N-RC
27	±5%	40	250	0.23	700	M8486CT-ND	.28	.26	.22	84.95/M	PM0603-27N-RC
33	±5%	43	250	0.23	600	M8487CT-ND	.28	.26	.22	84.95/M	PM0603-33N-RC
39	±5%	43	250	0.25	600	M8488CT-ND	.28	.26	.22	84.95/M	PM0603-39N-RC
47	±5%	40	200	0.28	600	M8490CT-ND	.28	.26	.22	84.95/M	PM0603-47N-RC
82	±5%	35	150	0.54	400	M8491CT-ND	.28	.26	.22	84.95/M	PM0603-82N-RC
120	±5%	35	150	0.65	300	M8493CT-ND	.28	.26	.22	84.95/M	PM0603-120N-RC

\* For Tape and Reel part number, change CT-ND to TR-ND.

L	Tol. %	Q Min.	L Test Freq. MHz	R, dc Max. Ω	I, dc Max. mA	Digi-Key Part No.	Cut Tape Price Each	T & R* Pricing	J.W. Miller Part No.		
PM0805 Series							1	10	100		
6.8nH	20	50	250	0.11	600	M8452CT-ND	.29	.27	.22	87.12/M	PM0805-6N8M-RC
8.2nH	20	50	250	0.12	600	M8453CT-ND	.29	.27	.22	87.12/M	PM0805-8N2M-RC
12nH	20	50	250	0.15	600	M8454CT-ND	.29	.27	.22	87.12/M	PM0805-12NM-RC
22nH	20	55	250	0.22	500	M8455CT-ND	.29	.27	.22	87.12/M	PM0805-22NM-RC
27nH	20	55	250	0.25	500	M8456CT-ND	.29	.27	.22	87.12/M	PM0805-27NM-RC
33nH	20	60	250	0.27	500	M8457CT-ND	.29	.27	.22	87.12/M	PM0805-33NM-RC
39nH	20	60	250	0.29	500	M8458CT-ND	.29	.27	.22	87.12/M	PM0805-39NM-RC
47nH	20	60	200	0.31	500	M8459CT-ND	.29	.27	.22	87.12/M	PM0805-47NM-RC
.056µH	10	60	200	0.34	500	M8460CT-ND	.29	.27	.22	87.12/M	PM0805-56NK-RC
.068µH	10	60	200	0.38	500	M8461CT-ND	.29	.27	.22	87.12/M	PM0805-68NK-RC
.082µH	10	65	150	0.42	400	M8462CT-ND	.29	.27	.22	87.12/M	PM0805-82NK-RC
.10µH	10	65	150	0.46	400	M8463CT-ND	.29	.27	.22	87.12/M	PM0805-R10K-RC
.12µH	10	50	150	0.51	400	M8464CT-ND	.29	.27	.22	87.12/M	PM0805-R12K-RC
.22µH	10	50	100	0.70	400	M8466CT-ND	.29	.27	.22	87.12/M	PM0805-R22K-RC
PM1008 Series											
18nH	20	50	50	0.11	1000	M8467CT-ND	.29	.27	.22	—	PM1008-18NM-RC
27nH	20	55	50	0.13	1000	M8469CT-ND	.29	.27	.22	87.12/M	PM1008-27NM-RC
68nH	20	65	50	0.20	1000	M8470CT-ND	.29	.27	.22	87.12/M	PM1008-68NK-RC
82nH	10	60	50	0.22	1000	M8471CT-ND	.29	.27	.22	87.12/M	PM1008-82NK-RC
.33µH	10	45	25	1.05	450	M8472CT-ND	.29	.27	.22	87.12/M	PM1008-R33K-RC
.47µH	10	45	25	1.19	470	M8473CT-ND	.29	.27	.22	—	PM1008-R47K-RC
.68µH	10	45	25	1.47	400	M8474CT-ND	.29	.27	.22	87.12/M	PM1008-R68K-RC
.82µH	10	45	25	1.61	400	M8475CT-ND	.29	.27	.22	87.12/M	PM1008-R82K-RC
1.0µH	10	35	25	1.75	370	M8476CT-ND	.29	.27	.22	87.12/M	PM1008-R10K-RC
1.2µH	10	35	7.9	2.00	340	M8477CT-ND	.29	.27	.22	87.12/M	PM1008-R12K-RC
1.5µH	10	28	7.9	2.30	330	M8478CT-ND	.29	.27	.22	87.12/M	PM1008-R15K-RC
1.8µH	10	28	7.9	2.60	300	M8479CT-ND	.29	.27	.22	87.12/M	PM1008-R18K-RC
2.2µH	10	28	7.9	2.80	290	M8480CT-ND	.29	.27	.22	87.12/M	PM1008-R22K-RC
2.7µH	10	22	7.9	3.20	290	M8481CT-ND	.29	.27	.22	87.12/M	PM1008-R27K-RC
3.3µH	10	22	7.9	3.40	290	M8482CT-ND	.29	.27	.22	87.12/M	PM1008-R33K-RC
4.7µH	10	20	7.9	4.00	260	M8483CT-ND	.29	.27	.22	—	PM1008-R47K-RC

\* For Tape and Reel part number, change CT-ND to TR-ND.

## Surface Mount Power Inductors



### PM3308 Series

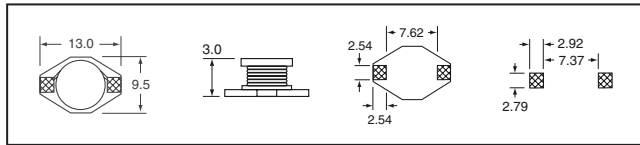

L ±20% (µH)	R, dc Max. Ω	I, sat. Amp	I, rms Amp	Digi-Key Part No.	Cut Tape Price Each	T & R* Pricing	J.W. Miller Part No.		
					1	10	100		
10	0.11	2.4	2.0	M8576CT-ND	1.23	1.12	.93	370.26	PM3308-100M-RC
22	0.23	1.6	1.3	M8577CT-ND	1.23	1.12	.93	370.26	PM3308-220M-RC
33	0.30	1.4	1.1	M8578CT-ND	1.23	1.12	.93	370.26	PM3308-330M-RC
47	0.39	1.0	0.8	M8579CT-ND	1.23	1.12	.93	370.26	PM3308-470M-RC
68	0.66	0.9	0.7	M8580CT-ND	1.23	1.12	.93	370.26	PM3308-680M-RC
330	2.7	0.4	0.3	M8581CT-ND	1.23	1.12	.93	370.26	PM3308-331M-RC
470	4.0	0.3	0.2	M8582CT-ND	1.23	1.12	.93	370.26	PM3308-471M-RC

\* For Tape and Reel part number, change CT-ND to TR-ND.

## Surface Mount Power Inductors



### PM3316 Series

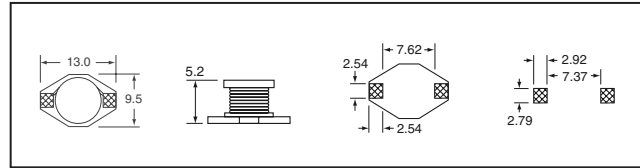

L ±20% (µH)	R, dc Max. Ω	I, sat. Amp	I, rms Amp	Digi-Key Part No.	Cut Tape Price Each	T & R* Pricing	J.W. Miller Part No.		
					1	10	100		
1.0	0.009	9.0	6.8	M8557CT-ND	1.20	1.08	.90	179.69	PM3316-1R0M-RC
1.5	0.010	8.0	6.4	M8558CT-ND	1.20	1.08	.90	179.69	PM3316-1R5M-RC
2.2	0.012	7.0	6.1	M8559CT-ND	1.20	1.08	.90	179.69	PM3316-2R2M-RC
3.3	0.10	2.0	2.1	M8566CT-ND	1.20	1.08	.90	179.69	PM3316-330M-RC
68	0.20	1.4	1.5	M8568CT-ND	1.20	1.08	.90	179.69	PM3316-680M-RC
100	0.28	1.2	1.3	M8569CT-ND	1.20	1.08	.90	179.69	PM3316-101M-RC
150	0.40	1.0	1.0	M8570CT-ND	1.20	1.08	.90	179.69	PM3316-151M-RC
330	1.02	0.6	0.6	M8572CT-ND	1.20	1.08	.90	179.69	PM3316-331M-RC
470	1.27	0.5	0.5	M8573CT-ND	1.20	1.08	.90	179.69	PM3316-471M-RC

\* For Tape and Reel part number, change CT-ND to TR-ND.

## Surface Mount Power Inductors



### PM3340 Series

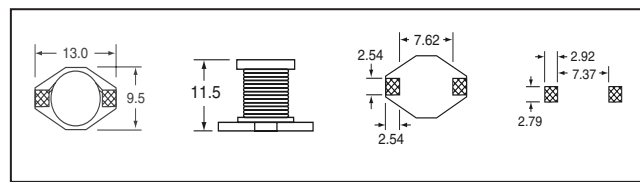

L ±20% (µH)	R, dc Max. Ω	I, sat. Amp	I, rms Amp	Digi-Key Part No.	Cut Tape Price Each	T & R* Pricing	J.W. Miller Part No.		
					1	10	100		
10	0.033	8.0	3.5	M8583CT-ND	1.27	1.15	.96	85.76	PM3340-100M-RC
15	0.042	7.0	3.0	M8584CT-ND	1.27	1.15	.96	85.76	PM3340-150M-RC
22	0.054	5.5	2.5	M8585CT-ND	1.27	1.15	.96	85.76	PM3340-220M-RC
33	0.08	4.0	2.0	M8586CT-ND	1.27	1.15	.96	85.76	PM3340-330M-RC
47	0.1	3.8	1.6	M8587CT-ND	1.27	1.15	.96	85.76	PM3340-470M-RC
68	0.17	3.0	1.2	M8588CT-ND	1.27	1.15	.96	85.76	PM3340-680M-RC
100	0.22	2.5	1.2	M8589CT-ND	1.27	1.15	.96	85.76	PM3340-101M-RC
150	0.34	2.0	0.9	M8590CT-ND	1.27	1.15	.96	85.76	PM3340-151M-RC
220	0.44	1.6	0.7	M8591CT-ND	1.27	1.15	.96	85.76	PM3340-221M-RC
330	0.7	1.2	0.6	M8592CT-ND	1.27	1.15	.96	85.76	PM3340-331M-RC
1000	2.0	0.8	0.1	M8593CT-ND	1.27	1.15	.96	85.76	PM3340-102M-RC

\* For Tape and Reel part number, change CT-ND to TR-ND.

## Surface Mount Power Inductors



### PM5022 Series

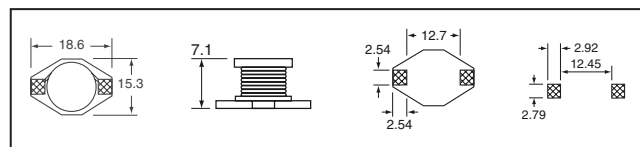

L ±20% (µH)	R, dc Max. Ω	I, sat. Amp	I, rms Amp	Digi-Key Part No.	Cut Tape Price Each	T & R* Pricing	J.W. Miller Part No.		
					1	10	100		
5.6	0.022	12	5.3	M8594CT-ND	.98	.89	.74	73.51	PM5022-5R6M-RC
10	0.032	10	4.3	M8597CT-ND	.98	.89	.74	73.51	PM5022-100M-RC
68	0.13	3.5	2.3	M8602CT-ND	.98	.89	.74	73.51	PM5022-680M-RC
100	0.19	3.0	1.8	M8603CT-ND	.98	.89	.74	73.51	PM5022-101M-RC
220	0.38	2.4	1.2	M8605CT-ND	.98	.89	.74	73.51	PM5022-221M-RC
470	0.85	1.4	0.82	M8607CT-ND	.98	.89	.74	73.51	PM5022-471M-RC
680	1.2	1.2	0.72	M8608CT-ND	.98	.89	.74	73.51	PM5022-681M-RC
1000	1.8	1.0	0.56	M8609CT-ND	.98	.89	.74	73.51	PM5022-102M-RC

\* For Tape and Reel part number, change CT-ND to TR-ND.

Free shipping on orders over £50! All prices are in British pound sterling and include duties.

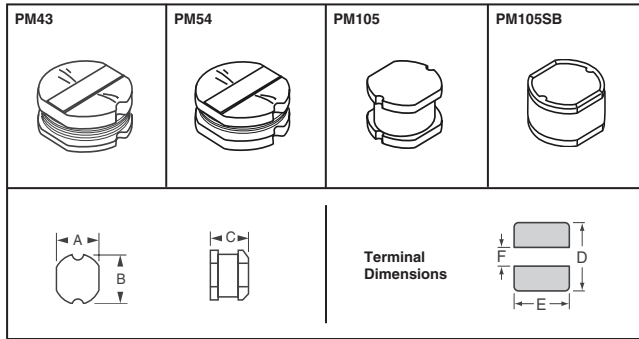

Dimensions (mm)						
Series	A	B	C	D Typ.	E Typ.	F Typ.
PM43	4.0 ±0.3	4.5 ±0.3	3.2 ±0.3	4.5	4.0	1.2
PM54	5.2 ±0.3	5.8 ±0.3	4.5 ±0.3	5.8	5.2	1.3
PM105	9.0 ±0.4	10.0 ±0.4	5.4 ±0.4	10.0	9.5	2.5
PM105/SB	9.2 ±0.4	10.0 ±0.4	5.0 ±0.5	10.0	9.5	2.5

L (µH)	Tol. %	Test Freq.	Max. DCR Ω	Rated I Amps	Digi-Key Part No.	Cut Tape Price Each			T & R* Pricing 1,500	J.W. Miller Part No.
						1	10	100		
<b>PM43 Series</b>										
10	20	2.5MHz	0.182	1.04	M8503CT-ND	1.05	.95	.79	315.82/M	PM43-100M-RC
22	20	2.5MHz	0.378	0.68	M8506CT-ND	1.05	.95	.79	315.82/M	PM43-220M-RC
33	10	2.5MHz	0.540	0.56	M8507CT-ND	1.05	.95	.79	315.82/M	PM43-330K-RC
56	10	2.5MHz	0.937	0.42	M8509CT-ND	1.05	.95	.79	315.82/M	PM43-560K-RC
68	10	2.5MHz	1.117	0.37	M8510CT-ND	1.05	.95	.79	315.82/M	PM43-680K-RC
<b>PM54 Series</b>										
10	20	2.5MHz	0.10	1.44	M8511CT-ND	1.05	.95	.79	315.82/M	PM54-100M-RC
12	20	2.5MHz	0.12	1.40	M8513CT-ND	1.05	.95	.79	315.82/M	PM54-120M-RC
18	20	2.5MHz	0.15	1.23	M8516CT-ND	1.05	.95	.79	315.82/M	PM54-180M-RC
22	20	2.5MHz	0.18	1.11	M8518CT-ND	1.05	.95	.79	315.82/M	PM54-220M-RC
27	20	2.5MHz	0.20	0.97	M8520CT-ND	1.05	.95	.79	315.82/M	PM54-270M-RC
33	15	2.5MHz	0.23	0.88	M8521CT-ND	1.05	.95	.79	315.82/M	PM54-330L-RC
39	15	2.5MHz	0.32	0.80	M8522CT-ND	1.05	.95	.79	315.82/M	PM54-390L-RC
47	15	2.5MHz	0.37	0.72	M8523CT-ND	1.05	.95	.79	315.82/M	PM54-470L-RC
68	10	2.5MHz	0.46	0.61	M8524CT-ND	1.05	.95	.79	315.82/M	PM54-680K-RC
82	10	2.5MHz	0.60	0.58	M8525CT-ND	1.05	.95	.79	315.82/M	PM54-820K-RC
100	10	1kHz	0.70	0.52	M8512CT-ND	1.05	.95	.79	315.82/M	PM54-101K-RC
150	10	1kHz	1.10	0.40	M8515CT-ND	1.05	.95	.79	315.82/M	PM54-151K-RC
180	10	1kHz	1.38	0.38	M8517CT-ND	1.05	.95	.79	315.82/M	PM54-181K-RC
220	10	1kHz	1.57	0.35	M8519CT-ND	1.05	.95	.79	315.82/M	PM54-221K-RC

\* For Tape and Reel part number, change CT-ND to TR-ND.

L (µH)	Tol. %	Test Freq.	Max. DCR Ω	Rated I Amps	Digi-Key Part No.	Cut Tape Price Each			T & R* Pricing 500	J.W. Miller Part No.
						1	10	100		
<b>PM105 Series</b>										
15	20	2.5MHz	0.08	2.27	M8414CT-ND	1.38	1.25	1.04	206.91	PM105-150M-RC
39	20	2.5MHz	0.14	1.37	M8417CT-ND	1.38	1.25	1.04	206.91	PM105-390M-RC
47	10	2.5MHz	0.17	1.28	M8418CT-ND	1.38	1.25	1.04	206.91	PM105-470K-RC
82	10	2.5MHz	0.25	1.00	M8421CT-ND	1.38	1.25	1.04	206.91	PM105-820K-RC
100	10	1kHz	0.35	0.97	M8422CT-ND	1.38	1.25	1.04	206.91	PM105-101K-RC
120	10	1kHz	0.40	0.89	M8423CT-ND	1.38	1.25	1.04	206.91	PM105-121K-RC
180	10	1kHz	0.63	0.72	M8425CT-ND	1.38	1.25	1.04	—	PM105-181K-RC
270	10	1kHz	0.97	0.57	M8427CT-ND	1.38	1.25	1.04	206.91	PM105-271K-RC
330	10	1kHz	1.15	0.52	M8428CT-ND	1.38	1.25	1.04	206.91	PM105-331K-RC
470	10	1kHz	1.48	0.42	M8429CT-ND	1.38	1.25	1.04	206.91	PM105-471K-RC
560	10	1kHz	1.90	0.33	M8430CT-ND	1.38	1.25	1.04	206.91	PM105-561K-RC
680	10	1kHz	2.25	0.28	M8431CT-ND	1.38	1.25	1.04	206.91	PM105-681K-RC
<b>PM105SB (Shielded) Series</b>										
10	20	2.5MHz	0.06	2.06	M8433CT-ND	1.07	.96	.81	160.08	PM105SB-100M-RC
15	20	2.5MHz	0.07	1.72	M8435CT-ND	1.07	.96	.81	160.08	PM105SB-150M-RC

L (µH)	Tol. %	Test Freq.	Max. DCR Ω	Rated I Amps	Digi-Key Part No.	Cut Tape Price Each			T & R* Pricing 500	J.W. Miller Part No.
						1	10	100		
27	20	2.5MHz	0.10	1.32	M8438CT-ND	1.07	.96	.81	160.08	PM105SB-270M-RC
33	15	2.5MHz	0.11	1.16	M8439CT-ND	1.07	.96	.81	160.08	PM105SB-330L-RC
47	15	2.5MHz	0.14	1.00	M8441CT-ND	1.07	.96	.81	143.75	PM105SB-470L-RC
82	15	2.5MHz	0.28	0.79	M8443CT-ND	1.07	.96	.81	160.08	PM105SB-820L-RC
100	10	1kHz	0.34	0.72	M8444CT-ND	1.07	.96	.81	160.08	PM105SB-101K-RC
120	10	1kHz	0.37	0.63	M8445CT-ND	1.07	.96	.81	—	PM105SB-121K-RC
150	10	1kHz	0.51	0.55	M8446CT-ND	1.07	.96	.81	—	PM105SB-151K-RC
330	10	1kHz	1.20	0.37	M8450CT-ND	1.07	.96	.81	160.08	PM105SB-331K-RC

\* For Tape and Reel part number, change CT-ND to TR-ND.

**Surface Mount High Current Toroid Inductors — PM2110 and PM2120 Series**

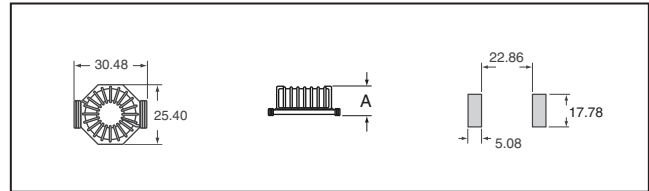

L (µH) @ 1kHz	I, dc (A)	L (µH) ±20% @ Rated I	DCR (Ω) Max.	Dim. A (mm) Max.	Digi-Key Part No.	Price Each			J.W. Miller Part No.
						1	10	25	
<b>PM2110 Series 20%</b>									
1.00	22.70	0.80	0.00	14.48	M8754-ND	1.98	1.49	1.33	PM2110-1R0M-RC
5.60	13.70	3.90	0.01	14.48	M8755-ND	1.98	1.49	1.33	PM2110-5R6M-RC
<b>PM2110 Series 10%</b>									
10.00	11.70	6.50	0.01	14.48	M8756-ND	1.98	1.49	1.33	PM2110-100K-RC
12.00	11.30	7.60	0.01	14.48	M8757-ND	1.98	1.49	1.33	PM2110-120K-RC
15.00	10.70	9.20	0.01	14.48	M8758-ND	1.98	1.49	1.33	PM2110-150K-RC
18.00	10.20	10.70	0.01	14.48	M8759-ND	1.98	1.49	1.33	PM2110-180K-RC
22.00	9.70	12.70	0.01	14.48	M8760-ND	1.98	1.49	1.33	PM2110-220K-RC
27.00	8.20	16.00	0.01	13.72	M8761-ND	1.98	1.49	1.33	PM2110-270K-RC
33.00	7.00	20.10	0.02	13.21	M8762-ND	1.98	1.49	1.33	PM2110-330K-RC
39.00	6.80	23.20	0.02	15.75	M8763-ND	1.98	1.49	1.33	PM2110-390K-RC
47.00	6.50	27.20	0.02	15.75	M8764-ND	1.98	1.49	1.33	PM2110-470K-RC
56.00	6.20	31.60	0.02	15.75	M8765-ND	1.98	1.49	1.33	PM2110-560K-RC
68.00	5.90	37.10	0.03	15.75	M8766-ND	1.98	1.49	1.33	PM2110-680K-RC
100.00	5.40	51.40	0.03	15.75	M8767-ND	1.98	1.49	1.33	PM2110-101K-RC
150.00	4.30	77.30	0.05	14.99	M8768-ND	1.98	1.49	1.33	PM2110-151K-RC
180.00	3.70	96.30	0.07	13.46	M8769-ND	1.98	1.49	1.33	PM2110-181K-RC
220.00	3.50	113.80	0.07	15.24	M8770-ND	1.98	1.49	1.33	PM2110-221K-RC
270.00	3.40	134.90	0.08	15.24	M8771-ND	1.98	1.49	1.33	PM2110-271K-RC
330.00	3.20	159.50	0.09	15.24	M8772-ND	1.98	1.49	1.33	PM2110-331K-RC
390.00	3.10	182.90	0.10	15.24	M8773-ND	1.98	1.49	1.33	PM2110-391K-RC
470.00	2.60	230.40	0.13	14.48	M8774-ND	1.98	1.49	1.33	PM2110-471K-RC
820.00	2.00	394.10	0.22	15.24	M8775-ND	1.98	1.49	1.33	PM2110-821K-RC
1000.00	1.90	463.70	0.24	15.24	M8776-ND	1.98	1.49	1.33	PM2110-102K-RC
<b>PM2120 Series 20%</b>									
2.20	19.70	1.80	0.00	20.83	M8777-ND	2.18	1.64	1.46	PM2120-2R2M-RC
4.70	16.60	3.70	0.01	20.83	M8778-ND	2.18	1.64	1.46	PM2120-4R7M-RC
5.60	15.60	4.20	0.01	20.83	M8779-ND	2.18	1.64	1.46	PM2120-5R6M-RC
6.80	14.70	5.00	0.01	20.83	M8780-ND	2.18	1.64	1.46	PM2120-6R8M-RC
<b>PM2120 Series 10%</b>									
10.00	13.90	7.20	0.01	20.83	M8781-ND	2.18	1.64	1.46	PM2120-100K-RC
12.00	12.70	8.30	0.01	20.83	M8782-ND	2.18	1.64	1.46	PM2120-120K-RC
15.00	12.20	10.20	0.01	20.83	M8783-ND	2.18	1.64	1.46	PM2120-150K-RC
18.00	11.80	12.00	0.01	20.83	M8784-ND	2.18	1.64	1.46	PM2120-180K-RC
22.00	11.00	14.20	0.01	20.83	M8785-ND	2.18	1.64	1.46	PM2120-220K-RC
27.00	10.40	16.90	0.01	20.83	M8786-ND	2.18	1.64	1.46	PM2120-270K-RC
33.00	10.10	20.30	0.01	20.83	M8787-ND	2.18	1.64	1.46	PM2120-330K-RC
39.00	9.60	23.30	0.01	20.83	M8788-ND	2.18	1.64	1.46	PM2120-390K-RC
47.00	8.20	29.20	0.02	20.07	M8789-ND	2.18	1.64	1.46	PM2120-470K-RC
56.00	7.90	33.90	0.02	20.07	M8790-ND	2.18	1.64	1.46	PM2120-560K-RC
68.00	6.70	42.20	0.03	19.56	M8791-ND	2.18	1.64	1.46	PM2120-680K-RC
82.00	6.40	49.50	0.03	22.10	M8792-ND	2.18	1.64	1.46	PM2120-820K-RC
100.00	6.10	58.70	0.04	22.10	M8793-ND	2.18	1.64	1.46	PM2120-101K-RC
120.00	5.80	68.10	0.04	22.10	M8794-ND	2.18	1.64	1.46	PM2120-121K-RC
150.00	5.50	82.50	0.04	22.10	M8795-ND	2.18	1.64	1.46	PM2120-151K-RC
180.00	5.30	96.20	0.05	21.08	M8796-ND	2.18	1.64	1.46	PM2120-181K-RC
220.00	5.00	113.70	0.05	21.08	M8797-ND	2.18	1.64	1.46	PM2120-221K-RC
330.00	3.60	183.40	0.10</						