



Frequency (MHz)	Digi-Key Part No.	Cut Tape Price Each			Tape & Reel Pricing* 2,000	Citizen Part No.
		1	10	50		
10.000000	300-7205-1-ND	2.45	2.29	1.97	914.76/M	CSX750FCC10.000M-UT
12.000000	300-7206-1-ND	2.45	2.29	1.97	914.76/M	CSX750FCC12.000M-UT
12.288000	300-7207-1-ND	2.45	2.29	1.97	914.76/M	CSX750FCC12.288M-UT
14.318180	300-7208-1-ND	2.45	2.29	1.97	914.76/M	CSX750FCC14.31818M-UT
14.745600	300-7209-1-ND	2.18	2.04	1.75	813.12/M	CSX750FCC14.7456M-UT
16.000000	300-7210-1-ND	2.45	2.29	1.97	914.76/M	CSX750FCC16.000M-UT
16.384000	300-7211-1-ND	2.45	2.29	1.97	914.76/M	CSX750FCC16.384M-UT
18.432000	300-7212-1-ND	2.45	2.29	1.97	914.76/M	CSX750FCC18.432M-UT
20.000000	300-7213-1-ND	2.18	2.04	1.75	813.12/M	CSX750FCC20.000M-UT
24.000000	300-7214-1-ND	2.45	2.29	1.97	914.76/M	CSX750FCC24.000M-UT
24.576000	300-7215-1-ND	2.18	2.04	1.75	813.12/M	CSX750FCC24.576M-UT
25.000000	300-7216-1-ND	2.45	2.29	1.97	914.76/M	CSX750FCC25.000M-UT
27.000000	300-7217-1-ND	2.18	2.04	1.75	813.12/M	CSX750FCC27.000M-UT
29.491200	300-7218-1-ND	2.45	2.29	1.97	914.76/M	CSX750FCC29.4912M-UT
32.000000	300-7219-1-ND	2.45	2.29	1.97	914.76/M	CSX750FCC32.000M-UT
32.768000	300-7220-1-ND	2.45	2.29	1.97	914.76/M	CSX750FCC32.768M-UT
33.333000	300-7221-1-ND	2.45	2.29	1.97	914.76/M	CSX750FCC33.333M-UT
35.328000	300-7222-1-ND	2.45	2.29	1.97	914.76/M	CSX750FCC35.328M-UT
40.000000	300-7223-1-ND	2.45	2.29	1.97	914.76/M	CSX750FCC40.000M-UT
44.000000	300-7224-1-ND	2.45	2.29	1.97	914.76/M	CSX750FCC44.000M-UT
45.000000	300-7225-1-ND	2.45	2.29	1.97	914.76/M	CSX750FCC45.000M-UT
49.152000	300-7226-1-ND	2.45	2.29	1.97	914.76/M	CSX750FCC49.152M-UT
50.000000	300-7227-1-ND	2.45	2.29	1.97	914.76/M	CSX750FCC50.000M-UT
60.000000	300-7228-1-ND	2.45	2.29	1.97	914.76/M	CSX750FCC60.000M-UT
66.666000	300-7229-1-ND	2.45	2.29	1.97	914.76/M	CSX750FCC66.666M-UT

**CSX750FJC**

40.000000	300-7253-1-ND	2.45	2.29	1.97	914.76/M	CSX750FJC40.000M-UT
44.000000	300-7254-1-ND	2.45	2.29	1.97	914.76/M	CSX750FJC44.000M-UT
45.000000	300-7255-1-ND	2.45	2.29	1.97	914.76/M	CSX750FJC45.000M-UT
49.152000	300-7256-1-ND	2.45	2.29	1.97	914.76/M	CSX750FJC49.152M-UT
50.000000	300-7257-1-ND	2.18	2.04	1.75	813.12/M	CSX750FJC50.000M-UT
60.000000	300-7258-1-ND	2.45	2.29	1.97	914.76/M	CSX750FJC60.000M-UT
66.666000	300-7259-1-ND	2.18	2.04	1.75	813.12/M	CSX750FJC66.666M-UT
80.000000	300-8191-1-ND	3.40	3.18	2.73	1270.50/M	CSX750FJC80.000M-UT
80.000000	300-8231-1-ND	2.86	2.67	2.29	1067.22/M	CSX750FJC80.000M-UT

\* For Tape and Reel part number, change 1-ND to 2-ND.

## CSX-750A Series High Frequency Ceramic Surface Mount Clock Oscillators

**Specifications:**  
 • **CSX750AC:** 10TTL/30pF, OE, 5.0V operation type • **CSX750AB:** 15pF, OE, 3.3V operation type  
 • **Nominal Frequency:** CSX750AC/AB 70.0 – 140.0MHz • **Operating Temperature:** -40°C – 85°C • **Supply Voltage:** CSX750AC 5.0 ±0.5V, CSX750AB 3.3 ±0.3V • **Frequency Stability:** B: ±50ppm(-20°C – 70°C) • **Current Consumption:** 50mA Max (CSX750AC), 30mA Max (CSX750AB) • **Duty Cycle:** 40% – 60% (TTL level), 45% – 55% (CMOS level)

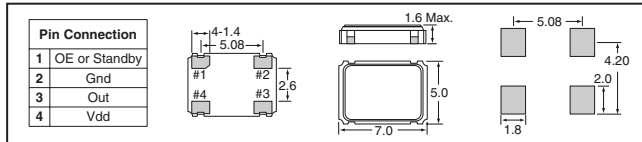

Frequency (MHz)	Digi-Key Part No.	Cut Tape Price Each			Tape & Reel Pricing 2,000	Citizen Part No.
		1	10	50		
106.250	300-8154-1-ND	3.00	2.45	2.18	1524.60/M	CSX750ABB106.250MTR
106.250	300-8148-1-ND	3.00	2.45	2.18	1524.60/M	CSX750ACB106.250MTR
133.330	300-8150-1-ND	3.00	2.45	2.18	—	CSX750ACB133.330MTR

## CSX-750V Series Voltage Controlled Crystal Oscillators

**Specifications:**  
 • **Supply Voltage:** CSX-750VJ: 5.0V ±0.5; CSX-750VK: 3.3V ±0.3 • **Frequency Stability:** ±50ppm • **Pullability:** CSX-750VJ: ±100ppm; CSX-750VK: ±90ppm • **Output Current:** 10mA • **Operating Temperature:** -20°C – 70°C • **Duty Cycle:** 45% Min., 55% Max.

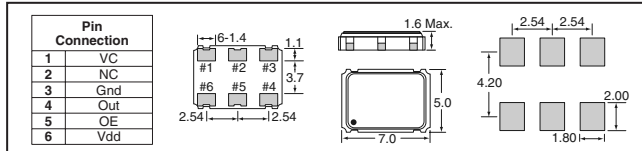

Frequency (MHz)	Digi-Key Part No.	Cut Tape Price Each			Tape & Reel Pricing 2,000	Citizen Part No.
		1	10	50		
4.096	300-8173-1-ND	3.00	2.45	2.18	—	CSX750VKB4.096M-UT
4.096	300-8157-1-ND	3.00	2.45	2.18	—	CSX750VJB4.096M-UT
8.000	300-8174-1-ND	3.00	2.45	2.18	1524.60/M	CSX750VKB8.000M-UT
8.000	300-8158-1-ND	3.00	2.45	2.18	1524.60/M	CSX750VJB8.000M-UT
8.192	300-8175-1-ND	3.00	2.45	2.18	—	CSX750VKB8.192M-UT

Frequency (MHz)	Digi-Key Part No.	Cut Tape Price Each			Digi-Key Part No.	Tape & Reel Pricing 2,000	Citizen Part No.
		1	10	50			
12.288	300-8160-1-ND	3.00	2.45	2.18	—	—	CSX750VJB12.288M-UT
12.352	300-8177-1-ND	3.00	2.45	2.18	—	—	CSX750VKB12.352M-UT
12.352	300-8161-1-ND	3.00	2.45	2.18	300-8161-2-ND	1524.60/M	CSX750VJB12.352M-UT
13.500	300-8178-1-ND	5.99	4.91	4.36	300-8178-2-ND	2032.80/M	CSX750VKB13.500M-UT
13.500	300-8162-1-ND	5.99	4.91	4.36	300-8162-2-ND	2032.80/M	CSX750VJB13.500M-UT
16.384	300-8163-1-ND	3.00	2.45	2.18	300-8163-2-ND	1524.60/M	CSX750VJB16.384M-UT
19.440	300-8164-1-ND	3.00	2.45	2.18	300-8164-2-ND	1524.60/M	CSX750VJB19.440M-UT
24.704	300-8167-1-ND	3.00	2.45	2.18	300-8167-2-ND	1524.60/M	CSX750VJB24.704M-UT
25.000	300-8168-1-ND	3.00	2.45	2.18	—	—	CSX750VJB25.000M-UT
32.000	300-8186-1-ND	3.00	2.45	2.18	300-8186-2-ND	1524.60/M	CSX750VKB32.000M-UT
32.000	300-8170-1-ND	3.00	2.45	2.18	—	—	CSX750VJB32.000M-UT
32.768	300-8171-1-ND	3.00	2.45	2.18	—	—	CSX750VJB32.768M-UT
35.328	300-8188-1-ND	3.00	2.45	2.18	300-8188-2-ND	1524.60/M	CSX750VKB35.328M-UT
35.328	300-8172-1-ND	3.00	2.45	2.18	—	—	CSX750VJB35.328M-UT

## CMX309FLC Series Oscillators

**Specifications:**  
 • **Frequency Tolerance:** ±100ppm (-20°C – 70°C) • **Operating Temperature:** -40°C – 85°C • **Storage Temperature:** -55°C – 125°C • **Supply Voltage:** 5V ±0.5V • **Supply Current:** 23mA Max. • **Duty @ TTL Level (1.4V):** 45% – 55% • **Duty @ CMOS Level (VDD/2):** 40% – 60% • **Output Voltage:** -0.4V (VOH) Min. • **Output Load:** 0.4V (VOL) Max. • **Output Load TTL:** 10TTL Max. • **Output Load CMOS:** 50pF Max. • **Rise Time TTL:** 8ns Max. • **Fall Time TTL:** 8ns Max. • **Rise Time CMOS:** 8ns Max. • **Fall Time CMOS:** 8ns Max. • **Start-up Time:** 4ms Max. • **Output Enable-Voltage:** 2V (VIH) Min. • **Output Enable-Voltage:** 0.8V (VIL) Max. • **Disable Current:** 12mA Max. • **Aging (First Year):** ±5ppm Max.

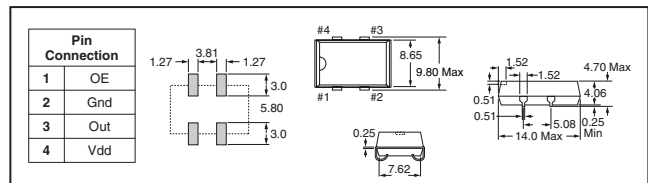

Frequency (MHz)	Digi-Key Part No.	Cut Tape Price Each			Digi-Key Part No.	Tape & Reel Pricing 1,000	Citizen Part No.
		1	10	50			
1.54400	300-7001-1-ND	2.18	2.04	1.31	—	—	CMX309FLC1.544MT
3.07200	300-7006-1-ND	2.18	2.04	1.31	300-7006-2-ND	964.13	CMX309FLC3.072MT
3.579545	300-7007-1-ND	2.18	2.04	1.31	300-7007-2-ND	964.13	CMX309FLC3.579545MT
6.14400	300-7014-1-ND	2.18	2.04	1.31	300-7014-2-ND	964.13	CMX309FLC6.144MT
8.19200	300-7017-1-ND	2.18	2.04	1.31	300-7017-2-ND	964.13	CMX309FLC8.192MT
9.83040	300-7018-1-ND	2.18	2.04	1.31	—	—	CMX309FLC9.8304MT
11.00000	300-7021-1-ND	2.18	2.04	1.31	300-7021-2-ND	964.13	CMX309FLC11.000MT
11.28960	300-7023-1-ND	2.18	2.04	1.31	300-7023-2-ND	964.13	CMX309FLC11.2896MT
12.35200	300-7026-1-ND	2.18	2.04	1.31	300-7026-2-ND	964.13	CMX309FLC12.352MT
13.50000	300-7027-1-ND	2.18	2.04	1.31	300-7027-2-ND	964.13	CMX309FLC13.500MT
14.31818	300-7028-1-ND	2.18	2.04	1.31	300-7028-2-ND	964.13	CMX309FLC14.31818MT
16.38400	300-7034-1-ND	2.18	2.04	1.31	300-7034-2-ND	964.13	CMX309FLC16.384MT
16.66600	300-7035-1-ND	2.18	2.04	1.31	300-7035-2-ND	964.13	CMX309FLC16.666MT
18.00000	300-7037-1-ND	2.18	2.04	1.31	300-7037-2-ND	964.13	CMX309FLC18.000MT
18.43200	300-7038-1-ND	2.18	2.04	1.31	300-7038-2-ND	964.13	CMX309FLC18.432MT
19.66800	300-7039-1-ND	2.18	2.04	1.31	—	—	CMX309FLC19.668MT
24.00000	300-7042-1-ND	2.18	2.04	1.31	300-7042-2-ND	964.13	CMX309FLC24.000MT
25.17500	300-7045-1-ND	2.18	2.04	1.31	—	—	CMX309FLC25.175MT
27.00000	300-7046-1-ND	2.18	2.04	1.31	300-7046-2-ND	964.13	CMX309FLC27.000MT
28.32200	300-7047-1-ND	2.18	2.04	1.31	—	—	CMX309FLC28.322MT
28.63636	300-7048-1-ND	2.18	2.04	1.31	—	—	CMX309FLC28.63636MT
29.498928	300-7049-1-ND	2.18	2.04	1.31	—	—	CMX309FLC29.498928MT
30.00000	300-7050-1-ND	2.18	2.04	1.31	—	—	CMX309FLC30.000MT

**RoHS Compliant**

2.45760	300-8584-1-ND	1.91	1.78	1.15	—	—	CMX309FLC2.4576M-UT
3.68640	300-8587-1-ND	1.91	1.78	1.15	300-8587-2-ND	843.61	CMX309FLC3.6864M-UT
4.00000	300-8588-1-ND	1.91	1.78	1.15	—	—	CMX309FLC4.000M-UT
4.91520	300-8590-1-ND	1.91	1.78	1.15	300-8590-2-ND	843.61	CMX309FLC4.9152M-UT
6.00000	300-8592-1-ND	2.18	2.04	1.31	—	—	CMX309FLC6.000M-UT
6.14400	300-8593-1-ND	2.18	2.04	1.31	—	—	CMX309FLC6.144M-UT
7.37280	300-8594-1-ND	2.18	2.04	1.31	—	—	CMX309FLC7.3728M-UT
8.00000	300-8595-1-ND	1.91	1.78	1.15	300-8595-2-ND	843.61	CMX309FLC8.000M-UT
8.19200	300-8596-1-ND	1.91	1.78	1.15	—	—	CMX309FLC8.192M-UT
9.83040	300-8597-1-ND	1.91	1.78	1.15	—	—	CMX309FLC9.8304M-UT
13.50000	300-8603-1-ND	2.18	2.04	1.31	—	—	CMX309FLC13.500M-UT
14.31818	300-8604-1-ND	1.91	1.78	1.15	300-8604-2-ND	843.61	CMX309FLC14.31818M-UT
15.36000	300-8606-1-ND	2.18	2.04	1.31	—	—	CMX309FLC15.360M-UT
16.38400	300-8608-1-ND	1.91	1.78	1.15	—	—	CMX309FLC16.384M-UT
17.734475	300-8609-1-ND	2.18	2.04	1.31	300-8609-2-ND	964.13	CMX309FLC17.734475M-UT
18.00000	300-8610-1-ND	2.18	2.04	1.31	—	—	CMX309FLC18.000M-UT
18.43200	300-8611-1-ND	1.91	1.78	1.15	—	—	CMX309FLC18.432M-UT
22.11840	300-8614-1-ND	1.91	1.78	1.15	300-8614-2-ND	843.61	CMX309FLC22.1184M-UT
24.00000	300-8615-1-ND	1.91	1.78	1.15	—	—	CMX309FLC24.000M-UT
27.00000	300-8619-1-ND	1.91	1.78	1.15	—	—	CMX309FLC27.000M-UT
28.32200	300-8620-1-ND	1.91	1.78	1.15	30		

## CMX309FBC Series Oscillators

### Specifications:

- Frequency Tolerance:  $\pm 100$ ppm (-20°C ~ 70°C)
- Operating Temperature: -40°C ~ 85°C
- Storage Temperature: -55°C ~ 125°C
- Supply Voltage: 3.3V  $\pm 0.3$ V
- Supply Current: 9mA Max.
- Duty @ CMOS Level (VDD/2): 40% ~ 60%
- Output Voltage: -0.4V (VOH) Min.
- Output Voltage: 0.4V (VOL) Max.
- Rise Time CMOS: 6ns Max.
- Fall Time CMOS: 6ns Max.
- Start-up Time: 4ms Max.
- Output Enable-Voltage: 2V (VIH) Min.
- Output Enable-Voltage: 0.8V (VIL) Max.
- Disable Current: 5mA Max.
- Aging (First Year):  $\pm 5$ ppm Max.

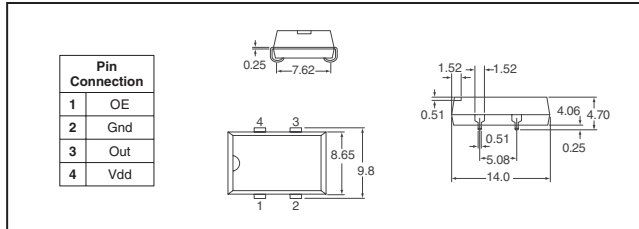

Frequency (MHz)	Digi-Key Part No.	Cut Tape Price Each	Digi-Key Part No.	Tape & Reel Pricing 1,000	Citizen Part No.
1.54400	300-2101-1-ND	2.04 1.91 1.23	300-2101-2-ND	903.87	CMX309FBC1.544MTR
1.84320	300-2102-1-ND	2.04 1.91 1.23	—	—	CMX309FBC1.8432MTR
2.00000	300-2103-1-ND	2.04 1.91 1.23	300-2103-2-ND	903.87	CMX309FBC2.000MTR
2.45760	300-2105-1-ND	2.04 1.91 1.23	—	—	CMX309FBC2.4576MTR
3.68640	300-2106-1-ND	2.04 1.91 1.23	—	—	CMX309FBC3.6864MTR
4.00000	300-2107-1-ND	2.04 1.91 1.23	300-2107-2-ND	903.87	CMX309FBC4.000MTR
5.00000	300-2108-1-ND	2.04 1.91 1.23	300-2108-2-ND	903.87	CMX309FBC5.000MTR
8.00000	300-2109-1-ND	2.04 1.91 1.23	—	—	CMX309FBC8.000MTR
8.19200	300-2110-1-ND	2.04 1.91 1.23	—	—	CMX309FBC8.192MTR
9.83040	300-2111-1-ND	2.04 1.91 1.23	—	—	CMX309FBC9.8304MTR
14.74560	300-2118-1-ND	2.04 1.91 1.23	300-2118-2-ND	903.87	CMX309FBC14.7456MTR
16.00000	300-2119-1-ND	2.04 1.91 1.23	—	—	CMX309FBC16.000MTR
16.38400	300-2120-1-ND	2.04 1.91 1.23	300-2120-2-ND	903.87	CMX309FBC16.384MTR
18.43200	300-2121-1-ND	2.04 1.91 1.23	—	—	CMX309FBC18.432MTR
20.00000	300-2122-1-ND	2.04 1.91 1.23	—	—	CMX309FBC20.000MTR
24.00000	300-2123-1-ND	2.04 1.91 1.23	300-2123-2-ND	903.87	CMX309FBC24.000MTR

### RoHS Compliant

1.00000	300-8366-1-ND	1.91 1.78 1.15	—	—	CMX309FBC1.000M-UT
1.84320	300-8368-1-ND	1.91 1.78 1.15	300-8368-2-ND	843.61	CMX309FBC1.8432M-UT
2.00000	300-8369-1-ND	1.91 1.78 1.15	—	—	CMX309FBC2.000M-UT
2.45760	300-8371-1-ND	1.91 1.78 1.15	—	—	CMX309FBC2.4576M-UT
3.68640	300-8372-1-ND	1.91 1.78 1.15	300-8372-2-ND	843.61	CMX309FBC3.6864M-UT
5.00000	300-8374-1-ND	1.91 1.78 1.15	—	—	CMX309FBC5.000M-UT
8.00000	300-8375-1-ND	1.91 1.78 1.15	300-8375-2-ND	843.61	CMX309FBC8.000M-UT
8.19200	300-8376-1-ND	1.91 1.78 1.15	300-8376-2-ND	843.61	CMX309FBC8.192M-UT
9.83040	300-8377-1-ND	1.91 1.78 1.15	—	—	CMX309FBC9.8304M-UT
14.31818	300-8383-1-ND	1.91 1.78 1.15	—	—	CMX309FBC14.31818M-UT
14.74560	300-8384-1-ND	1.91 1.78 1.15	300-8384-2-ND	843.61	CMX309FBC14.7456M-UT
16.00000	300-8385-1-ND	1.91 1.78 1.15	300-8385-2-ND	843.61	CMX309FBC16.000M-UT
16.38400	300-8386-1-ND	1.91 1.78 1.15	—	—	CMX309FBC16.384M-UT
18.43200	300-8387-1-ND	1.91 1.78 1.15	—	—	CMX309FBC18.432M-UT
24.00000	300-8389-1-ND	1.91 1.78 1.15	—	—	CMX309FBC24.000M-UT
25.00000	300-8391-1-ND	1.91 1.78 1.15	—	—	CMX309FBC25.000M-UT

## CMX309HWC Series Oscillators

- Specifications: • Frequency Tolerance:  $\pm 100$ ppm (-20°C ~ 70°C) • Operating Temperature: -40°C ~ 85°C
- Storage Temperature: -55°C ~ 125°C • Supply Voltage: 5V  $\pm 0.5$ V • Supply Current: 35mA Max. • Duty @ TTL Level (1.4V): 45% ~ 55% • Duty @ CMOS Level (VDD/2): 40% ~ 60% • Output Voltage: -0.5V (VOH) Min. • Output Voltage: 0.5V (VOL) Max. • Output Load TTL: 10TTL Max. • Output Load CMOS: 50pF Max. • Rise Time TTL: 5ns Max. • Fall Time TTL: 5ns Max. • Rise Time CMOS: 7ns Max. • Fall Time CMOS: 7ns Max. • Start-up Time: 10ms Max. • Output Enable-Voltage: 2V (VIH) Min. • Output Enable-Voltage: 0.8V (VIL) Max. • Disable Current: 28mA Max. • Aging (First Year):  $\pm 5$ ppm Max.

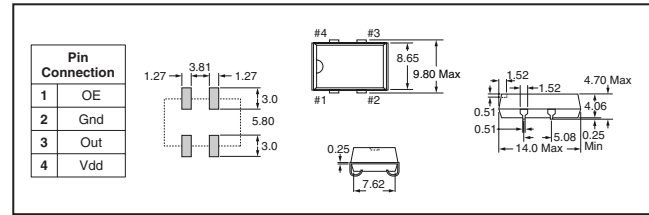

Frequency (MHz)	Digi-Key Part No.	Cut Tape Price Each	Digi-Key Part No.	Tape & Reel Pricing 1,000	Citizen Part No.
32.7680	300-7102-1-ND	2.18 2.04 1.31	300-7102-2-ND	964.13	CMX309HWC32.768MT
33.3333	300-7104-1-ND	2.18 2.04 1.31	—	—	CMX309HWC33.3333MT
44.2368	300-7108-1-ND	2.18 2.04 1.31	300-7108-2-ND	964.13	CMX309HWC44.2368MT
49.1520	300-7110-1-ND	2.18 2.04 1.31	—	—	CMX309HWC49.152MT
50.0000	300-7111-1-ND	2.32 2.16 1.39	300-7111-2-ND	1024.39	CMX309HWC50.000MT
53.1250	300-7112-1-ND	2.18 2.04 1.31	300-7112-2-ND	964.13	CMX309HWC53.125MT
60.0000	300-7113-1-ND	2.18 2.04 1.31	300-7113-2-ND	964.13	CMX309HWC60.000MT
66.6667	300-7116-1-ND	2.18 2.04 1.31	—	—	CMX309HWC66.6667MT

### RoHS Compliant

32.0000	300-8624-1-ND	1.91 1.78 1.15	300-8624-2-ND	843.61	CMX309HWC32.000M-UT
32.7680	300-8625-1-ND	1.91 1.78 1.15	—	—	CMX309HWC32.768M-UT
33.0000	300-8626-1-ND	1.91 1.78 1.15	—	—	CMX309HWC33.000M-UT
48.0000	300-8629-1-ND	1.91 1.78 1.15	300-8629-2-ND	843.61	CMX309HWC48.000M-UT
50.0000	300-8631-1-ND	1.91 1.78 1.15	—	—	CMX309HWC50.000M-UT

## CMX309HBC Series Oscillators

- Specifications: • Frequency Tolerance:  $\pm 100$ ppm (-20°C ~ 70°C) • Operating Temperature: -40°C ~ 85°C • Storage Temperature: -55°C ~ 125°C • Supply Voltage: 3.3V  $\pm 0.3$ V • Duty Cycle @ CMOS Level: 40% ~ 60% • Output Voltage: -0.4V (VOH) Min. • Output Voltage: 0.4V (VOL) Max. • Rise Time CMOS: 6ns Max. • Fall Time CMOS: 6ns Max. • Start-up Time: 10ms Max. • Output Enable-Voltage: 2.4V (VIH) Min. • Output Enable-Voltage: 0.6V (VIL) Max. • Output Load CMOS: 30pF Max. • Disable Current: 15mA Max. • Aging (First Year):  $\pm 5$ ppm Max.

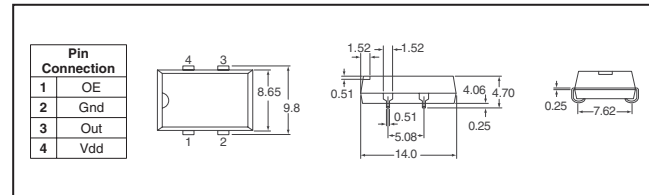

Frequency (MHz)	Digi-Key Part No.	Cut Tape Price Each	Digi-Key Part No.	Tape & Reel Pricing 1,000	Citizen Part No.
32.0000	300-2200-1-ND	2.04 1.91 1.23	300-2200-2-ND	903.87	CMX309HBC32.000MTR
32.7680	300-2201-1-ND	2.04 1.91 1.23	300-2201-2-ND	903.87	CMX309HBC32.768MTR
33.0000	300-2202-1-ND	2.04 1.91 1.23	300-2202-2-ND	903.87	CMX309HBC33.000MTR
33.3333	300-2203-1-ND	2.04 1.91 1.23	300-2203-2-ND	903.87	CMX309HBC33.3333MTR
36.8640	300-2204-1-ND	2.04 1.91 1.23	300-2204-2-ND	903.87	CMX309HBC36.864MTR
53.1250	300-2208-1-ND	2.04 1.91 1.23	300-2208-2-ND	903.87	CMX309HBC53.125MTR

### RoHS Compliant

32.0000	300-8393-1-ND	1.91 1.78 1.15	—	—	CMX309HBC32.000M-UT
32.7680	300-8394-1-ND	1.91 1.78 1.15	300-8394-2-ND	843.61	CMX309HBC32.768M-UT
33.0000	300-8395-1-ND	1.91 1.78 1.15	—	—	CMX309HBC33.000M-UT
33.3333	300-8396-1-ND	1.91 1.78 1.15	300-8396-2-ND	843.61	CMX309HBC33.3333M-UT
40.0000	300-8398-1-ND	1.91 1.78 1.15	300-8398-2-ND	843.61	CMX309HBC40.000M-UT
48.0000	300-8399-1-ND	1.91 1.78 1.15	300-8399-2-ND	843.61	CMX309HBC48.000M-UT

Free shipping on orders over £50! All prices are in British pound sterling and include duties.

uk.digikey.com — FREEPHONE: 0-800-587-0991 • 0-800-904-7786 — FREEFAX: 0-800-587-0992 • 0-800-904-7783

(UK091) 1321