

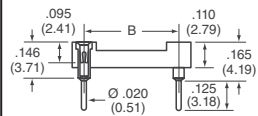

Dual-In-Line Sockets – Open Frame (Screw Machined)

Solder Tail



Most popular line of standard low profile IC-Sockets. Open frame design leaves space beneath IC for improved heat dissipation, easier PCB cleaning and inspection. **Insertion Characteristics:** 4-finger standard

Wire Wrap

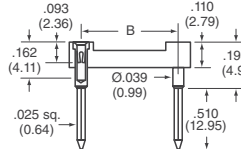

Solderless wire wrap terminals are firmly locked in the insulator body to withstand torque of wrapping tool. Length of terminal for three-level wrapping. **Insertion Characteristics:** 4-finger standard

Low Profile

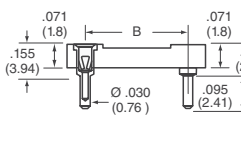

"Ultra low profile" Dual-in-line sockets are equipped with specially designed contacts allowing .095" (2.41mm) height above PCB. Special short contact requires .075" (1.91mm) insertion depth only. Solder tail diameter .030" (.76mm). **Insertion Characteristics:** 4-finger short contact

No. of Pins	Dimensions – Inch (mm)			Digi-Key Part No.	Price Each			Mill-Max Part No.
	A	B	C		1	10	100	
Solder Tail (Gold)								
Sleeve (Pin) – 200µ Sn/Pb; Contact (Clip) – 30µ Au								
8	0.4 (10.16)	0.3 (7.62)	0.4 (10.16)	ED3308-ND	.47	.33	.27	110-93-308-41-001000
14	0.7 (17.78)	0.3 (7.62)	0.4 (10.16)	ED3314-ND	.82	.57	.46	110-93-314-41-001000
16	0.8 (20.30)	0.3 (7.62)	0.4 (10.16)	ED3316-ND	.94	.65	.53	110-93-316-41-001000
18	0.9 (22.86)	0.3 (7.62)	0.4 (10.16)	ED3318-ND	1.05	.73	.59	110-93-318-41-001000
20	1.0 (25.40)	0.3 (7.62)	0.4 (10.16)	ED3320-ND	1.17	.82	.66	110-93-320-41-001000
24	1.2 (30.48)	0.3 (7.62)	0.4 (10.16)	ED3324-ND	1.41	.98	.79	110-93-324-41-001000
28	1.4 (35.56)	0.3 (7.62)	0.4 (10.16)	ED3328-ND	1.64	1.14	.92	110-93-328-41-001000
22	1.1 (27.94)	0.4 (10.16)	0.5 (12.70)	ED3422-ND	1.29	.90	.73	110-93-422-41-001000
24	1.2 (30.48)	0.4 (10.16)	0.5 (12.70)	ED3424-ND	1.41	.98	.79	110-93-424-41-001000
28	1.4 (35.56)	0.4 (10.16)	0.5 (12.70)	ED3628-ND	1.41	.98	.79	110-93-628-41-001000
28	1.4 (35.56)	0.6 (15.24)	0.7 (17.78)	ED3628-ND	1.64	1.14	.92	110-93-628-41-001000
32	1.6 (40.64)	0.6 (15.24)	0.7 (17.78)	ED3632-ND	1.87	1.30	1.05	110-93-632-41-001000
40	2.0 (50.80)	0.6 (15.24)	0.7 (17.78)	ED3640-ND	2.34	1.63	1.32	110-93-640-41-001000
48	2.4 (60.96)	0.6 (15.24)	0.7 (17.78)	ED3648-ND	2.81	1.95	1.58	110-93-648-41-001000
50	2.5 (63.50)	0.9 (22.86)	1.0 (25.40)	ED3950-ND	2.93	2.03	1.64	110-93-950-41-001000
64	3.2 (81.28)	0.9 (22.86)	1.0 (25.40)	ED3964-ND	3.75	2.60	2.10	110-93-964-41-001000
Sleeve (Pin) – 200µ Sn; Contact (Clip) – 30µ Au – RoHS Compliant								
8	0.4 (10.16)	0.3 (7.62)	0.4 (10.16)	ED90032-ND	.48	.34	.27	110-43-308-41-001000
14	0.7 (17.78)	0.3 (7.62)	0.4 (10.16)	ED90033-ND	.84	.59	.47	110-43-314-41-001000
16	0.8 (20.30)	0.3 (7.62)	0.4 (10.16)	ED90034-ND	.96	.67	.54	110-43-316-41-001000
18	0.9 (22.86)	0.3 (7.62)	0.4 (10.16)	ED90035-ND	1.08	.75	.61	110-43-318-41-001000
20	1.0 (25.40)	0.3 (7.62)	0.4 (10.16)	ED90036-ND	1.20	.84	.68	110-43-320-41-001000
24	1.2 (30.48)	0.3 (7.62)	0.4 (10.16)	ED90037-ND	1.44	1.00	.81	110-43-324-41-001000
28	1.4 (35.56)	0.3 (7.62)	0.4 (10.16)	ED90038-ND	1.68	1.17	.94	110-43-328-41-001000
22	1.1 (27.94)	0.4 (10.16)	0.5 (12.70)	ED90039-ND	1.32	.92	.74	110-43-422-41-001000
24	1.2 (30.48)	0.4 (10.16)	0.5 (12.70)	ED90040-ND	1.44	1.00	.81	110-43-424-41-001000
28	1.4 (35.56)	0.4 (10.16)	0.5 (12.70)	ED90041-ND	1.44	1.00	.81	110-43-624-41-001000
28	1.4 (35.56)	0.6 (15.24)	0.7 (17.78)	ED90042-ND	1.68	1.17	.94	110-43-628-41-001000
32	1.6 (40.64)	0.6 (15.24)	0.7 (17.78)	ED90043-ND	1.92	1.33	1.08	110-43-632-41-001000
40	2.0 (50.80)	0.6 (15.24)	0.7 (17.78)	ED90044-ND	2.40	1.67	1.35	110-43-640-41-001000
48	2.4 (60.96)	0.6 (15.24)	0.7 (17.78)	ED90045-ND	2.87	2.00	1.61	110-43-648-41-001000
50	2.5 (63.50)	0.9 (22.86)	1.0 (25.40)	ED90046-ND	3.00	2.08	1.68	110-43-950-41-001000
64	3.2 (81.28)	0.9 (22.86)	1.0 (25.40)	ED90047-ND	3.83	2.66	2.15	110-43-964-41-001000
Sleeve (Pin) – 10µ Au; Contact (Clip) – 30µ Au								
8	0.4 (10.16)	0.3 (7.62)	0.4 (10.16)	ED56083-ND	.65	.46	.37	110-13-308-41-001000
14	0.7 (17.78)	0.3 (7.62)	0.4 (10.16)	ED56143-ND	1.15	.80	.65	110-13-314-41-001000
16	0.8 (20.30)	0.3 (7.62)	0.4 (10.16)	ED56163-ND	1.31	.91	.74	110-13-316-41-001000
18	0.9 (22.86)	0.3 (7.62)	0.4 (10.16)	ED56183-ND	1.47	1.02	.83	110-13-318-41-001000
20	1.0 (25.40)	0.3 (7.62)	0.4 (10.16)	ED56203-ND	1.63	1.14	.92	110-13-320-41-001000
24	1.2 (30.48)	0.3 (7.62)	0.4 (10.16)	ED56243-ND	1.96	1.36	1.10	110-13-324-41-001000
28	1.4 (35.56)	0.3 (7.62)	0.4 (10.16)	ED56283-ND	2.29	1.59	1.29	110-13-328-41-001000
24	1.2 (30.48)	0.6 (15.24)	0.7 (17.78)	ED56246-ND	1.96	1.36	1.10	110-13-624-41-001000
28	1.4 (35.56)	0.6 (15.24)	0.7 (17.78)	ED56286-ND	2.29	1.59	1.29	110-13-628-41-001000
32	1.6 (40.64)	0.6 (15.24)	0.7 (17.78)	ED56326-ND	2.61	1.82	1.47	110-13-632-41-001000
40	2.0 (50.80)	0.6 (15.24)	0.7 (17.78)	ED56406-ND	3.27	2.27	1.83	110-13-640-41-001000
64	3.2 (81.28)	0.9 (22.86)	1.0 (25.40)	ED56464-ND	5.23	3.63	2.93	110-13-964-41-001000
Solder Tail (Tin)								
Sleeve (Pin) – 200µ Sn; Contact (Clip) – 200µ Sn/Pb								
8	0.4 (10.16)	0.3 (7.62)	0.4 (10.16)	ED3108-ND	.35	.25	.20	110-99-308-41-001000
14	0.7 (17.78)	0.3 (7.62)	0.4 (10.16)	ED3114-ND	.61	.43	.35	110-99-314-41-001000
16	0.8 (20.30)	0.3 (7.62)	0.4 (10.16)	ED3116-ND	.70	.49	.40	110-99-316-41-001000
18	0.9 (22.86)	0.3 (7.62)	0.4 (10.16)	ED3118-ND	.78	.55	.44	110-99-318-41-001000
20	1.0 (25.40)	0.3 (7.62)	0.4 (10.16)	ED3120-ND	.87	.61	.49	110-99-320-41-001000
24	1.2 (30.48)	0.3 (7.62)	0.4 (10.16)	ED3124-ND	1.05	.73	.59	110-99-324-41-001000
28	1.4 (35.56)	0.3 (7.62)	0.4 (10.16)	ED3128-ND	1.22	.85	.69	110-99-328-41-001000
22	1.1 (27.94)	0.4 (10.16)	0.5 (12.70)	ED3524-ND	1.05	.73	.59	110-99-424-41-001000
24	1.2 (30.48)	0.4 (10.16)	0.5 (12.70)	ED3724-ND	1.05	.73	.59	110-99-624-41-001000
28	1.4 (35.56)	0.4 (10.16)	0.5 (12.70)	ED3728-ND	1.22	.85	.69	110-99-628-41-001000
32	1.6 (40.64)	0.6 (15.24)	0.7 (17.78)	ED3732-ND	1.39	.97	.79	110-99-632-41-001000
40	2.0 (50.80)	0.6 (15.24)	0.7 (17.78)	ED3740-ND	1.74	1.21	.98	110-99-640-41-001000
48	2.4 (60.96)	0.6 (15.24)	0.7 (17.78)	ED3748-ND	2.09	1.45	1.18	110-99-648-41-001000
64	3.2 (81.28)	0.9 (22.86)	1.0 (25.40)	ED3764-ND	2.79	1.94	1.57	110-99-964-41-001000
Sleeve (Pin) – 200µ Sn; Contact (Clip) – 200µ Sn – RoHS Compliant								
8	0.4 (10.16)	0.3 (7.62)	0.4 (10.16)	ED90048-ND	.37	.26	.21	110-44-308-41-001000
14	0.7 (17.78)	0.3 (7.62)	0.4 (10.16)	ED90049-ND	.65	.45	.37	110-44-314-41-001000
16	0.8 (20.30)	0.3 (7.62)	0.4 (10.16)	ED90050-ND	.74	.52	.42	110-44-316-41-001000
18	0.9 (22.86)	0.3 (7.62)	0.4 (10.16)	ED90051-ND	.83	.58	.47	110-44-318-41-001000
20	1.0 (25.40)	0.3 (7.62)	0.4 (10.16)	ED90052-ND	.93	.65	.52	110-44-320-41-001000
24	1.2 (30.48)	0.3 (7.62)	0.4 (10.16)	ED90053-ND	1.11	.77	.63	110-44-324-41-001000
28	1.4 (35.56)	0.3 (7.62)	0.4 (10.16)	ED90054-ND	1.30	.90	.73	110-44-328-41-001000
24	1.2 (30.48)	0.4 (10.16)	0.5 (12.70)	ED90055-ND	1.11	.77	.63	110-44-424-41-001000
24	1.2 (30.48)	0.6 (15.24)	0.7 (17.78)	ED90056-ND	1.11	.77	.63	110-44-624-41-001000
28	1.4 (35.56)	0.6 (15.24)	0.7 (17.78)	ED90057-ND	1.30	.90	.73	110-44-628-41-001000

No. of Pins	Dimensions – Inch (mm)			Digi-Key Part No.	Price Each			Mill-Max Part No.
	A	B	C		1	10	100	
32	1.6 (40.64)	0.6 (15.24)	0.7 (17.78)	ED90058-ND	1.48	1.03	.83	110-44-632-41-001000
40	2.0 (50.80)	0.6 (15.24)	0.7 (17.78)	ED90059-ND	1.85	1.29	1.04	110-44-640-41-001000
48	2.4 (60.96)	0.6 (15.24)	0.7 (17.78)	ED90060-ND	2.22	1.55	1.25	110-44-648-41-001000
64	3.2 (81.28)	0.9 (22.86)	1.0 (25.40)	ED90061-ND	2.96	2.06	1.66	110-44-964-41-001000
Wire Wrap								
Sleeve (Pin) – 200µ Sn/Pb; Contact (Clip) – 30µ Au								
8	0.4 (10.16)	0.3 (7.62)	0.4 (10.16)	ED4308-ND	1.41	.98	.79	123-93-308-41-001000
14	0.7 (17.78)	0.3 (7.62)	0.4 (10.16)	ED4314-ND	2.46	1.71	1.38	123-93-314-41-001000
16	0.8 (20.30)	0.3 (7.62)	0.4 (10.16)	ED4316-ND	2.82	1.96	1.58	123-93-316-41-001000
18	0.9 (22.86)	0.3 (7.62)	0.4 (10.16)	ED4318-ND	3.17	2.20	1.78	123-93-318-41-001000
20	1.0 (25.40)	0.3 (7.62)	0.4 (10.16)	ED4320-ND	3.38	2.35	1.90	123-93-320-41-001000
24	1.2 (30.48)	0.3 (7.62)	0.4 (10.16)	ED4324-ND	4.38	3.04	2.46	123-93-324-41-001000
28	1.4 (35.56)	0.3 (7.62)	0.4 (10.16)	ED4328-ND	5.06	3.51	2.84	123-93-328-41-001000
24	1.2 (30.48)	0.4 (10.16)	0.5 (12.70)	ED4424-ND	4.38	3.04	2.46	123-93-424-41-001000
24	1.2 (30.48)	0.6 (15.24)	0.7 (17.78)	ED4624-ND	4.38	3.04	2.46	123-93-624-41-001000
28	1.4 (35.56)	0.6 (15.24)	0.7 (17.78)	ED4628-ND	5.06	3.51	2.84	123-93-628-41-001000
32	1.6 (40.64)	0.6 (15.24)	0.7 (17.78)	ED4632-ND	5.73	3.98	3.21	123-93-632-41-001000
40	2.0 (50.80)	0.6 (15.24)	0.7 (17.78)	ED4640-ND	6.48	4.49	3.63	123-93-640-41-001000
48	2.4 (60.96)	0.6 (15.24)	0.7 (17.78)	ED4648-ND	8.			



IC Sockets

With Integral Decoupling Capacitor Machine Screw Contact

Special Features/Applications:

- To eliminate noise at the source before it can reach the chip
- Advantages for uses such as high speed logic and memory applications
- To eliminate long leads as potential sources of noise because capacitor leads are connected directly to the ground and voltage pin of the socket

Technical Data: • Insulator body material: glass filled polyester UL94V-0 • Pin: screw machined Socket with integral glass encapsulated ceramic capacitor 0.1µF, 50VDC

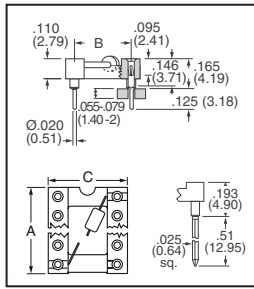

No. of Pins	Dimensions – Inch (mm)			Digi-Key Part No.	Pricing			Mill-Max Part No.
	A	B	C		1	10	100	
Tin Plated, Solder Tab								
14	0.7 (17.78)	0.3 (7.62)	0.4 (10.16)	ED2101-ND	2.24	19.46	157.19	110-93-314-41-801000
16	0.8 (20.32)	0.3 (7.62)	0.4 (10.16)	ED2102-ND	2.37	20.54	165.88	110-93-316-41-801000
18	0.9 (22.86)	0.3 (7.62)	0.4 (10.16)	ED2103-ND	2.82	24.42	197.28	110-93-318-41-801000
20	1.0 (25.40)	0.3 (7.62)	0.4 (10.16)	ED2104-ND	2.59	22.46	181.43	110-93-320-41-801000
24	1.2 (30.48)	0.3 (7.62)	0.4 (10.16)	ED2106-ND	2.98	25.82	208.57	110-93-324-41-801000
24	1.2 (30.48)	0.6 (15.24)	0.7 (17.78)	ED2105-ND	3.43	29.71	239.97	110-93-624-41-801000
28	1.4 (35.56)	0.6 (15.24)	0.7 (17.78)	ED2107-ND	3.41	29.54	238.60	110-93-628-41-801000
40	2.0 (50.80)	0.6 (15.24)	0.7 (17.78)	ED2108-ND	5.46	47.32	392.22	110-93-640-41-801000
Tin Plated, Solder Tab – RoHS Compliant								
14	0.7 (17.78)	0.3 (7.62)	0.4 (10.16)	ED90182-ND	2.35	20.39	164.66	110-43-314-41-801000
16	0.8 (20.32)	0.3 (7.62)	0.4 (10.16)	ED90183-ND	3.06	26.48	213.90	110-43-316-41-801000
18	0.9 (22.86)	0.3 (7.62)	0.4 (10.16)	ED90184-ND	3.30	28.56	230.67	110-43-318-41-801000
20	1.0 (25.40)	0.3 (7.62)	0.4 (10.16)	ED90185-ND	2.98	25.79	208.26	110-43-320-41-801000
24	1.2 (30.48)	0.3 (7.62)	0.4 (10.16)	ED90186-ND	3.38	29.29	236.62	110-43-324-41-801000
24	1.2 (30.48)	0.6 (15.24)	0.7 (17.78)	ED90187-ND	3.58	30.99	250.34	110-43-624-41-801000
28	1.4 (35.56)	0.6 (15.24)	0.7 (17.78)	ED90188-ND	3.83	33.16	267.27	110-43-628-41-801000
40	2.0 (50.80)	0.6 (15.24)	0.7 (17.78)	ED90189-ND	5.71	49.43	399.29	110-43-640-41-801000
Gold Plated, Solder Tab								
14	0.7 (17.78)	0.3 (7.62)	0.4 (10.16)	ED2109-ND	2.61	22.67	183.10	110-13-314-41-801000
16	0.8 (20.32)	0.3 (7.62)	0.4 (10.16)	ED2110-ND	3.06	26.48	213.90	110-13-316-41-801000
18	0.9 (22.86)	0.3 (7.62)	0.4 (10.16)	ED2111-ND	3.30	28.56	230.67	110-13-318-41-801000
20	1.0 (25.40)	0.3 (7.62)	0.4 (10.16)	ED2112-ND	3.10	26.88	217.10	110-13-320-41-801000
24	1.2 (30.48)	0.3 (7.62)	0.4 (10.16)	ED2114-ND	3.86	33.39	269.70	110-13-324-41-801000
24	1.2 (30.48)	0.6 (15.24)	0.7 (17.78)	ED2113-ND	4.04	35.01	282.81	110-13-624-41-801000
28	1.4 (35.56)	0.6 (15.24)	0.7 (17.78)	ED2115-ND	4.39	37.98	306.75	110-13-628-41-801000
40	2.0 (50.80)	0.6 (15.24)	0.7 (17.78)	ED2116-ND	6.44	55.80	450.67	110-13-640-41-801000
3-Level Tin Plated Wire-Wrap								
14	0.7 (17.78)	0.3 (7.62)	0.4 (10.16)	ED2117-ND	3.67	31.86	257.35	123-93-314-41-801000
16	0.8 (20.32)	0.3 (7.62)	0.4 (10.16)	ED2118-ND	4.03	34.94	282.20	123-93-316-41-801000
18	0.9 (22.86)	0.3 (7.62)	0.4 (10.16)	ED2119-ND	4.34	37.62	303.85	123-93-318-41-801000
20	1.0 (25.40)	0.3 (7.62)	0.4 (10.16)	ED2120-ND	4.52	39.19	316.51	123-93-320-41-801000
24	1.2 (30.48)	0.6 (15.24)	0.7 (17.78)	ED2121-ND	5.19	44.96	363.16	123-93-624-41-801000
28	1.4 (35.56)	0.6 (15.24)	0.7 (17.78)	ED2122-ND	6.11	53.01	428.11	123-93-628-41-801000
40	2.0 (50.80)	0.6 (15.24)	0.7 (17.78)	ED2123-ND	7.58	65.71	530.71	123-93-640-41-801000
3-Level Tin Plated Wire-Wrap – RoHS Compliant								
14	0.7 (17.78)	0.3 (7.62)	0.4 (10.16)	ED90190-ND	3.88	33.67	271.99	123-43-314-41-801000
16	0.8 (20.32)	0.3 (7.62)	0.4 (10.16)	ED90191-ND	4.27	37.02	298.97	123-43-316-41-801000
18	0.9 (22.86)	0.3 (7.62)	0.4 (10.16)	ED90192-ND	4.61	39.94	322.61	123-43-318-41-801000
20	1.0 (25.40)	0.3 (7.62)	0.4 (10.16)	ED90193-ND	4.81	41.68	336.63	123-43-320-41-801000
24	1.2 (30.48)	0.6 (15.24)	0.7 (17.78)	ED90194-ND	5.53	47.95	387.25	123-43-624-41-801000
28	1.4 (35.56)	0.6 (15.24)	0.7 (17.78)	ED90195-ND	6.52	56.50	456.31	123-43-628-41-801000
40	2.0 (50.80)	0.6 (15.24)	0.7 (17.78)	ED90196-ND	8.13	70.48	569.29	123-43-640-41-801000

Dual-In-Line Sockets – Low Profile Open Frame

- Dip Sockets with reduced height: only .122" (3.10mm) above PCB
- Hi-Rel, 4-finger #30 clip

Plating: Sleeve (Pin) – 200µ" Sn/Pb; (RoHS Compliant: 200µ" Sn), Contact (Clip) – 30µ" Au

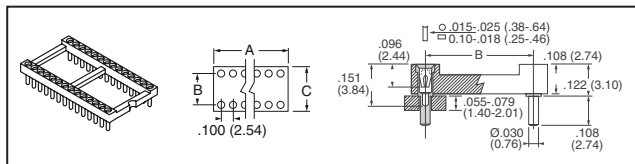

No. of Pins	Dimensions – Inch (mm)			Digi-Key Part No.	Pricing			Mill-Max Part No.
	A	B	C		1	10	100	
Vacuum Pads Top Surface Only								
8	0.4 (10.16)	0.3 (7.62)	0.4 (10.16)	ED2128-ND	.54	4.72	38.12	163.35
14	0.7 (17.78)	0.3 (7.62)	0.4 (10.16)	ED2129-ND	.95	8.27	66.78	286.19
16	0.8 (20.32)	0.3 (7.62)	0.4 (10.16)	ED2130-ND	1.09	9.44	76.23	326.70
18	0.9 (22.86)	0.3 (7.62)	0.4 (10.16)	ED2131-ND	1.23	10.63	85.83	367.86
20	1.0 (25.40)	0.3 (7.62)	0.4 (10.16)	ED2132-ND	1.57	13.59	109.77	470.45
Vacuum Pad Top Surface Only – RoHS Compliant								
8	0.4 (10.16)	0.3 (7.62)	0.4 (10.16)	ED90236-ND	.83	7.23	58.39	250.25
14	0.7 (17.78)	0.3 (7.62)	0.4 (10.16)	ED90237-ND	1.26	10.93	88.27	378.32
16	0.8 (20.32)	0.3 (7.62)	0.4 (10.16)	ED90238-ND	1.40	12.15	98.18	420.79
18	0.9 (22.86)	0.3 (7.62)	0.4 (10.16)	ED90239-ND	1.55	13.58	109.77	470.45
20	1.0 (25.40)	0.3 (7.62)	0.4 (10.16)	ED90240-ND	1.63	14.14	114.19	489.40
Vacuum Pads Top and Bottom								
24	1.2 (30.48)	0.6 (15.24)	0.7 (17.78)	ED2133-ND	1.57	13.59	109.77	470.45
28	1.4 (35.56)	0.6 (15.24)	0.7 (17.78)	ED2134-ND	1.83	15.86	128.07	548.86
32	1.6 (40.64)	0.6 (15.24)	0.7 (17.78)	ED2135-ND	2.09	18.12	146.36	627.26
40	2.0 (50.80)	0.6 (15.24)	0.7 (17.78)	ED2136-ND	2.50	21.71	175.33	751.41
Vacuum Pads Top and Bottom – RoHS Compliant								
24	1.2 (30.48)	0.6 (15.24)	0.7 (17.78)	ED90241-ND	1.91	16.52	133.40	571.73
28	1.4 (35.56)	0.6 (15.24)	0.7 (17.78)	ED90242-ND	2.18	18.90	152.61	654.05
32	1.6 (40.64)	0.6 (15.24)	0.7 (17.78)	ED90243-ND	2.45	21.26	171.67	735.03
40	2.0 (50.80)	0.6 (15.24)	0.7 (17.78)	ED90244-ND	2.89	25.01	202.01	865.76

Shrink Dip Sockets – Solder Tail – Open Frame

- High density Dual-in-Line Sockets for devices featuring .070" (1.78mm) lead spacing
- Four-finger beryllium copper contacts meet high vibration and shock requirements

Insertion Characteristics: 4-finger standard

Plating: Sleeve (Pin) – 200µ" Sn/Pb; (RoHS Compliant: 200µ" Sn), Contact (Clip) – 30µ" Au

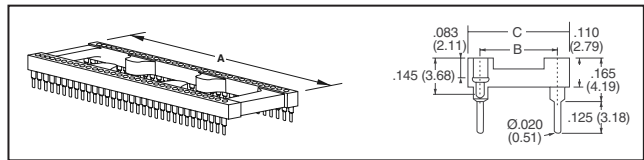

No. of Pins	Dimensions – Inch (mm)			Digi-Key Part No.	Pricing			Mill-Max Part No.
	A	B	C		1	10	100	
RoHS Compliant								
16	0.572 (14.53)	0.3 (7.62)	0.39 (9.91)	ED22163-ND	2.31	16.01	129.29	554.08
28	0.992 (25.20)	0.4 (10.16)	0.49 (12.45)	ED22284-ND	3.66	25.35	204.75	877.52
30	1.062 (26.97)	0.4 (10.16)	0.49 (12.45)	ED22304-ND	3.89	26.99	218.02	934.36
48	1.692 (42.98)	0.4 (10.16)	0.49 (12.45)	ED22484-ND	5.79	40.18	324.59	1391.09
20	0.712 (18.08)	0.6 (15.24)	0.69 (17.53)	ED22206-ND	2.71	18.76	151.55	649.48
28	0.992 (25.20)	0.6 (15.24)	0.69 (17.53)	ED22286-ND	3.66	25.35	204.75	877.52
40	1.412 (35.86)	0.6 (15.24)	0.69 (17.53)	ED22406-ND	4.89	33.86	273.51	1172.20
42	1.482 (37.64)	0.6 (15.24)	0.69 (17.53)	ED22426-ND	5.11	35.45	286.32	1227.09
48	1.692 (42.98)	0.6 (15.24)	0.69 (17.53)	ED22486-ND	5.79	40.18	324.59	1391.09
52	1.832 (46.53)	0.6 (15.24)	0.69 (17.53)	ED22526-ND	6.25	43.36	350.20	1500.86
56	1.972 (50.09)	0.6 (15.24)	0.69 (17.53)	ED22566-ND	6.71	46.51	375.66	1609.98
64	2.252 (57.20)	0.6 (15.24)	0.69 (17.53)	ED22646-ND	7.62	52.85	426.89	1829.52
68	2.392 (60.76)	0.6 (15.24)	0.69 (17.53)	ED22686-ND	8.07	55.99	452.20	1937.98
64	2.252 (57.20)	0.75 (19.05)	0.84 (21.34)	ED22647-ND	7.30	50.59	408.59	1751.11
RoHS Compliant								
16	0.572 (14.53)	0.3 (7.62)	0.39 (9.91)	ED90222-ND	2.41	16.68	134.77	577.61
28	0.992 (25.20)	0.4 (10.16)	0.49 (12.45)	ED90223-ND	3.83	26.50	214.05	917.37
30	1.062 (26.97)	0.4 (10.16)	0.49 (12.45)	ED90224-ND	4.07	28.22	227.93	976.83
48	1.692 (42.98)	0.4 (10.16)	0.49 (12.45)	ED90225-ND	6.07	42.07	339.83	1456.43
20	0.712 (18.08)	0.6 (15.24)	0.69 (17.53)	ED90226-ND	2.82	19.57	158.10	677.58
28	0.992 (25.20)	0.6 (15.24)	0.69 (17.53)	ED90227-ND	3.83	26.50	214.05	917.37
40	1.412 (35.86)	0.6 (15.24)	0.69 (17.53)	ED90228-ND	5.11	35.43	286.17	1226.43
42	1.482 (37.64)	0.6 (15.24)	0.69 (17.53)	ED90229-ND	5.35	37.09	299.58	1283.93
48	1.692 (42.98)	0.6 (15.24)	0.69 (17.53)	ED90230-ND	6.07	42.07	339.83	1456.43
52	1.832 (46.53)	0.6 (15.24)	0.69 (17.53)	ED90231-ND	6.55	45.38	366.51	1570.77
56	1.972 (50.09)	0.6 (15.24)	0.69 (17.53)	ED90232-ND	7.03	48.70	393.35	1685.77
64	2.252 (57.20)	0.6 (15.24)	0.69 (17.53)	ED90233-ND	7.99	55.34	447.01	1915.77