

MIL Style RV6 – 1/2 Watt Carbon Potentiometers

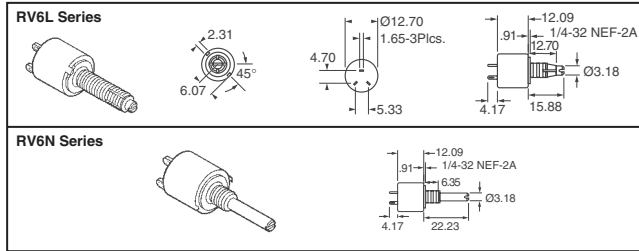

Specifications: • Resistance Tolerance: ±10% through 500K, ±20% from 1Meg • Resistance Taper: Linear • Power Rating: .5 Watts @ 70°C • Dielectric Strength: 750V RMS • Working Voltage: 350VDC maximum, but power not to exceed rating • Operating Temperature: -65°C ~ 125°C • Mechanical Rotation: 295° QPL listed under MIL R 94 Specifications. Metal housing, stainless steel shaft • Hardware included

Resistance Code Chart

Code (Value)	Code (Value)	Code (Value)	Code (Value)	Code (Value)
101 (100)	102 (1K)	103 (10K)	104 (100K)	105 (1Meg)
251 (250)	252 (2.5K)	253 (25K)	254 (250K)	505 (5Meg)
501 (500)	502 (5K)	503 (50K)	504 (500K)	

Resistance Range (Ω)	Digi-Key† Part No.	1	10	50	100	250	Precision Part No.
100-5Meg	RV6L□□□C-ND	11.83	10.92	8.19	5.28	4.85	RV6LAYSA(Code)A
100-1Meg	RV6N□□□C-ND	10.73	9.90	7.43	4.79	4.39	RV6NAYSJ(Code)A

† For complete number, substitute corresponding code (from Resistance Code Chart) for □□□.

Wirewound Precision Ten-Turn 2 Watt Potentiometers

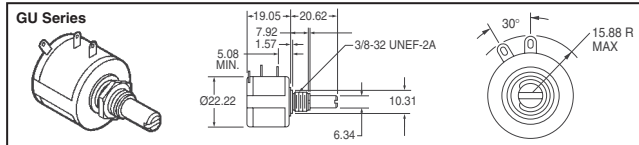

Specifications: • Resistance Tolerance: ±5% • Electrical/Mechanical Rotation: 3600° ± 10° 0° • Effective Rotation: 3600° nominal • Dielectric Strength: 1000 VAC for 60 seconds at ATM • Working Voltage: 500 volts maximum • Power rating: 2 watt at 70°C • Shaft Length and Size: 13/16" (20.64mm) FMS screwdriver slotted, stainless steel • Bushing Style: 5/16" (7.95mm) • Temperature Coefficient: ± 20 PPM/°C • Hardware included

Resistance Code Chart

Code (Value)	Code (Value)	Code (Value)
101 (100)	202 (2K)	253 (25K)
201 (200)	502 (5K)	503 (50K)
501 (500)	103 (10K)	104 (100K)
102 (1K)	203 (20K)	

Resistance Range (Ω)	Digi-Key† Part No.	1	10	50	100	250	Precision Part No.
100-100K	GU□□□1S26-ND	17.88	14.76	13.86	13.32	12.18	GU(Code)1S26

† For complete number, substitute corresponding code (from Resistance Code Chart) for □□□.

Type SPR Washable 1/2 Watt Carbon Potentiometers

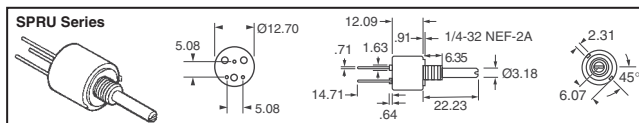

Specifications: • Resistance Tolerance: ±10% through 500K, ±20% from 1Meg ~ 5Meg • Resistance Taper: Linear • Power Rating: .5 Watts @ 70°C • Dielectric Strength: 750V RMS • Working Voltage: 350VDC maximum, but power not to exceed rating • Operating Temperature: -65°C ~ 125°C • Mechanical Rotation: 295° • Hardware included

Meets or exceeds MIL R 94 Specifications. Metal housing, stainless steel shaft.

Resistance Code Chart

Code (Value)	Code (Value)	Code (Value)	Code (Value)
101 (100)	252 (2.5K)	503 (50K)	105 (1Meg)
251 (250)	502 (5K)	104 (100K)	255 (2.5Meg)
501 (500)	103 (10K)	254 (250K)	505 (5Meg)
102 (1K)	253 (25K)	504 (500K)	

Resistance Range (Ω)	Digi-Key† Part No.	1	10	50	100	250	Precision Part No.
100-5Meg	SPRU□□□C-ND	8.66	7.83	6.66	5.53	4.83	SPRU(Code)1S28

† For complete number, substitute corresponding code (from Resistance Code Chart) for □□□.

MIL Style – 2 Watt Carbon Potentiometers

RV4L, RV4N, RV4NJ-(Linear Taper Single Element)

KA (Logarithmic Taper Single Element)

KB (Reverse Logarithmic Taper Single Element)

KU (High Life* Linear Taper Single Element)

*Rotational Life: 100,000 cycles

KKK (Logarithmic Taper Dual Element)

KKB (Reverse Logarithmic Taper Dual Element)

KKU (Linear Taper Dual Element)

Specifications:

• Resistance Tolerance: ±10% through 500K, ±20% from 1Meg

• Power Rating: 2 Watts @ 70°C, Derate to 0 Watt @ 120°C

• Dielectric Strength: 900V RMS

• Working Voltage: 500 volts, but power not to exceed rating

• Operating Temperature: -65°C ~ 125°C

• Mechanical Rotation: 314° QPL listed under MIL R 94 Specifications. Metal housing, stainless steel shaft. • Hardware included

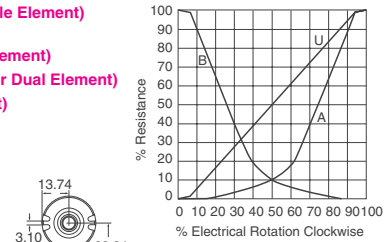

U = Linear Taper
A = Logarithmic Taper
B = Reverse Logarithmic Taper

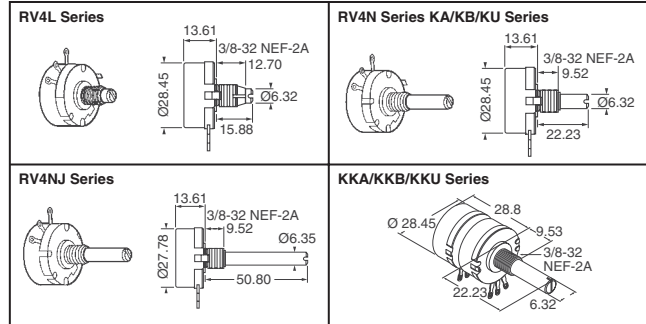

RV4L SERIES (LINEAR)				KA SERIES (LOG TAPER)	
Code (Value)	Code (Value)	Code (Value)	Code (Value)	Code (Value)	Code (Value)
500 (50)	102 (1K)	153 (15K)	104 (100K)	502 (5K)	104 (100K)
101 (100)	252 (2.5K)	253 (25K)	254 (250K)	103 (10K)	254 (250K)
251 (250)	502 (5K)	353 (35K)	504 (500K)	253 (25K)	504 (500K)
501 (500)	103 (10K)	503 (50K)	105 (1Meg)	503 (50K)	105 (1Meg)

RV4N SERIES (LINEAR)				RV4NJ SERIES (LINEAR)	
Code (Value)	Code (Value)	Code (Value)	Code (Value)	Code (Value)	Code (Value)
500 (50)	501 (500)	502 (5K)	253 (25K)	254 (250K)	502 (5K)
101 (100)	102 (1K)	752 (7.5K)	353 (35K)	504 (500K)	101 (100)
151 (150)	152 (1.5K)	103 (10K)	503 (50K)	105 (1Meg)	251 (250)
251 (250)	252 (2.5K)	153 (15K)	104 (100K)		102 (1K)
					252 (2.5K)

KB SERIES (REV LOG)		KKA SERIES (DUAL LOG)		KKB SERIES (DUAL REV LOG)		KKU SERIES (DUAL LINEAR)
Code (Value)	Code (Value)	Code (Value)	Code (Value)	Code (Value)	Code (Value)	Code (Value)
102 (1K)	104 (100K)	102 (1K)	104 (100K)	102 (1K)	104 (100K)	
502 (5K)	254 (250K)	502 (5K)	254 (250K)	502 (5K)	254 (250K)	
103 (10K)	504 (500K)	103 (10K)	504 (500K)	103 (10K)	504 (500K)	102 (1K)
253 (25K)	105 (1Meg)	253 (25K)	105 (1Meg)	253 (25K)	105 (1Meg)	502 (5K)
503 (50K)		503 (50K)		503 (50K)		103 (10K)

Resistance Range (Ω)	Digi-Key† Part No.	1	10	50	100	250	Precision Part No.
50-1Meg	RV4L□□□C-ND	8.37	7.57	6.44	5.35	4.67	RV4LAYSA(Code)A
50-1Meg	RV4N□□□C-ND	8.01	7.24	6.16	5.12	4.47	RV4NAYSJ(Code)A
50-1Meg	RV4NJ□□□C-ND	8.01	7.24	6.16	5.12	4.47	RV4NAYSJ(Code)A
5K-1Meg	KA□□□1S28-ND	11.44	10.34	8.80	7.31	6.38	KA(Code)1S28
5K	KU5021S28-HL-ND	11.54	10.44	8.88	7.38	6.44	KU5021S28-HL
1K-1Meg	KB□□□1S28-ND	11.44	10.34	8.80	7.31	6.38	KB(Code)1S28
1K-1Meg	KKA□□□1S28-ND	32.42	29.31	24.94	20.71	18.09	KKA(Code)1S28
1K-1Meg	KKB□□□1S28-ND	32.42	29.31	24.94	20.71	18.09	KKB(Code)1S28
1K-10K	KKU□□□1S28-ND	26.18	23.67	20.14	16.72	14.61	KKU(Code)1S28

† For complete number, substitute corresponding code (from Resistance Code Chart) for □□□.

Model 15 Turns Counting Dial

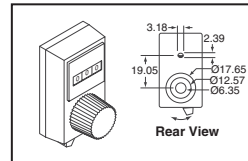

E15-1-11-ND: The left digit indicates the number of complete revolutions of the turning knob and the right two digits indicate the percent of a revolution. The unit registers a total count of 999.
E15-2-11-ND: The left two digits indicate the number of complete revolutions of the turning knob and the right two digits indicate the percent of a revolution. The unit registers a total count of 9999.

Description	Digi-Key Part No.	Price Each	Precision Part No.
Digital Dial (3 Digit/10 turn)	E15-1-11-ND	30.15	E15-1-11
Digital Dial (4 Digit/100 turn)	E15-2-11-ND	34.62	E15-2-11

More Product Available Online: www.digikey.com