

CTS Wirewound Potentiometers - 5 Watt

Series 026

SPECIFICATIONS: Resistance Range: 50 - 25KΩ Resistance Tolerance: ±20% Power Rating Watts: 5 Watts @ 25°C Derated to No Load @ 105°C Voltage Rating: Operating maximum 500VDC Shaft Information: 1" FMS x 250" (25.40mm FMS x 6.35mm) Diameter, Metal, Plain Round Angle of Rotation: 300° ±5° Bushing Information: Diameter: EIA Std. 3/8"-32, UNEF-2A Thread Length: 3/8" ± 1/64" (9.52mm ± .40mm) Terminal Information: Solder Lug, Formed to Rear Locating Lug: Left Side, Terminals Down

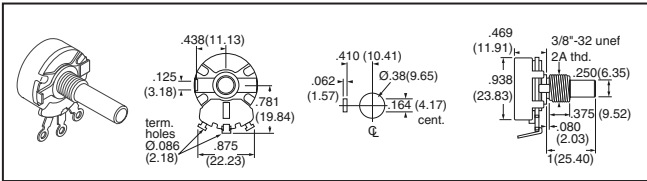

| Res. Ω | Digi-Key Part No. | Price Each | | | | CTS Part No. |
|--------|-------------------|------------|------|------|------|-----------------|
| | | 1 | 10 | 50 | 100 | |
| 5 | CT2150-ND | 3.61 | 3.36 | 2.79 | 2.52 | 026TB32R5A0B1A1 |
| 10 | CT2151-ND | 3.61 | 3.36 | 2.79 | 2.52 | 026TB32R100B1A1 |
| 25 | CT2152-ND | 3.61 | 3.36 | 2.79 | 2.52 | 026TB32R250B1A1 |
| 50 | CT2153-ND | 3.61 | 3.36 | 2.79 | 2.52 | 026TB32R500B1A1 |
| 100 | CT2154-ND | 3.61 | 3.36 | 2.79 | 2.52 | 026TB32R101B1A1 |
| 250 | CT2155-ND | 3.61 | 3.36 | 2.79 | 2.52 | 026TB32R251B1A1 |
| 500 | CT2156-ND | 3.61 | 3.36 | 2.79 | 2.52 | 026TB32R501B1A1 |
| 1K | CT2157-ND | 3.61 | 3.36 | 2.79 | 2.52 | 026TB32R102B1A1 |
| 5K | CT2158-ND | 3.61 | 3.36 | 2.79 | 2.52 | 026TB32R502B1A1 |
| 10K | CT2159-ND | 3.61 | 3.36 | 2.79 | 2.52 | 026TB32R103B1A1 |
| 25K | CT2160-ND | 3.61 | 3.36 | 2.79 | 2.52 | 026TB32R253B1A1 |

RoHS Compliant

Carbon Potentiometers - 1/4 Watt

Series 270

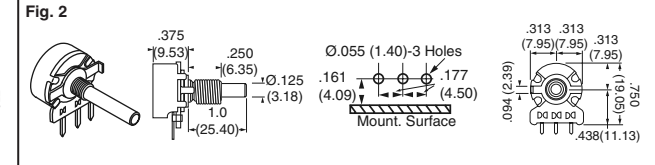
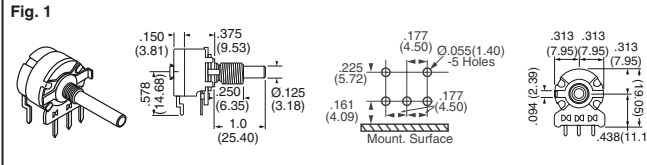

SPECIFICATIONS: Resistance Range: 500Ω through 1MΩ Resistance Tolerance: ±20% Power Rating Watts: 1/4 Watt through 100K, 1/5 Watt above 100K Voltage Rating: Operating Maximum: 500VDC Mechanical Rotation: 300° ±5° Available Power Switch: Type: Rotary Rating: 3A @ 125VAC (UL Approved)

Effective Rotation: Without Switch 300° (Approx.), with Switch 290° (Approx.) Resistance Taper: Linear, Logarithmic Locating Lug: Left Side, Terminals Down Bushing Information: Length: 1/4" (6.35mm), Thread Size: 1/4"-32, diameter: 1/4" (6.35mm) Shaft Information: Length: 1" (25.40mm) including bushing, Diameter: .125" (3.18mm)

| Digi-Key Part No. | Price Each | | | | |
|-----------------------|------------|------|------|------|------|
| | 1 | 10 | 50 | 100 | 250 |
| CT2223-ND - CT2233-ND | 3.48 | 3.24 | 2.69 | 2.43 | 2.16 |
| CT2201-ND - CT2211-ND | 2.71 | 2.52 | 2.10 | 1.89 | 1.68 |
| CT2212-ND - CT2222-ND | 3.53 | 3.28 | 2.73 | 2.46 | 2.19 |
| CT2234-ND - CT2244-ND | 2.77 | 2.58 | 2.15 | 1.94 | 1.72 |

| Linear Taper with Switch Fig. 1 | | | Linear Taper without Switch Fig. 2 | | | Logarithmic Taper with Switch Fig. 1 | | | Logarithmic Taper without Switch Fig. 2 | | |
|---------------------------------|-------------------|-----------------|------------------------------------|-------------------|-----------------|--------------------------------------|-------------------|-----------------|---|-------------------|-----------------|
| Res. Ω | Digi-Key Part No. | CTS Part No. | Res. Ω | Digi-Key Part No. | CTS Part No. | Res. Ω | Digi-Key Part No. | CTS Part No. | Res. Ω | Digi-Key Part No. | CTS Part No. |
| 500 | CT2223-ND | 270X232A501B1B1 | 500 | CT2201-ND | 270X232A501B1A1 | 500 | CT2212-ND | 270X232A501B2B1 | 500 | CT2234-ND | 270X232A501B2A1 |
| 1K | CT2224-ND | 270X232A102B1B1 | 1K | CT2202-ND | 270X232A102B1A1 | 1K | CT2213-ND | 270X232A102B2B1 | 1K | CT2235-ND | 270X232A102B2A1 |
| 2.5K | CT2225-ND | 270X232A252B1B1 | 2.5K | CT2203-ND | 270X232A252B1A1 | 2.5K | CT2214-ND | 270X232A252B2B1 | 2.5K | CT2236-ND | 270X232A252B2A1 |
| 5K | CT2226-ND | 270X232A502B1B1 | 5K | CT2204-ND | 270X232A502B1A1 | 5K | CT2215-ND | 270X232A502B2B1 | 5K | CT2237-ND | 270X232A502B2A1 |
| 10K | CT2227-ND | 270X232A103B1B1 | 10K | CT2205-ND | 270X232A103B1A1 | 10K | CT2216-ND | 270X232A103B2B1 | 10K | CT2238-ND | 270X232A103B2A1 |
| 25K | CT2228-ND | 270X232A253B1B1 | 25K | CT2206-ND | 270X232A253B1A1 | 25K | CT2217-ND | 270X232A253B2B1 | 25K | CT2239-ND | 270X232A253B2A1 |
| 50K | CT2229-ND | 270X232A503B1B1 | 50K | CT2207-ND | 270X232A503B1A1 | 50K | CT2218-ND | 270X232A503B2B1 | 50K | CT2240-ND | 270X232A503B2A1 |
| 100K | CT2230-ND | 270X232A104B1B1 | 100K | CT2208-ND | 270X232A104B1A1 | 100K | CT2219-ND | 270X232A104B2B1 | 100K | CT2241-ND | 270X232A104B2A1 |
| 250K | CT2231-ND | 270X232A254B1B1 | 250K | CT2209-ND | 270X232A254B1A1 | 250K | CT2220-ND | 270X232A254B2B1 | 250K | CT2242-ND | 270X232A254B2A1 |
| 500K | CT2232-ND | 270X232A504B1B1 | 500K | CT2210-ND | 270X232A504B1A1 | 500K | CT2221-ND | 270X232A504B2B1 | 500K | CT2243-ND | 270X232A504B2A1 |
| 1MEG | CT2233-ND | 270X232A105B1B1 | 1MEG | CT2211-ND | 270X232A105B1A1 | 1MEG | CT2222-ND | 270X232A105B2B1 | 1MEG | CT2244-ND | 270X232A105B2A1 |

RoHS Compliant

Carbon Potentiometers - 1/8 Watt

Series 296

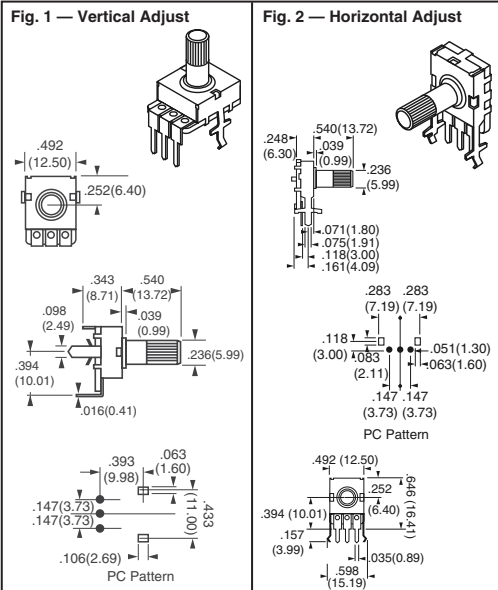

SPECIFICATIONS:

Resistance Range: 500Ω - 1MΩ Resistance tolerance: ±20% Power Rating Watts: 0.15 Watts @ 40°C derated to no load @ 85°C Voltage Rating: Across End Terminals: 250VDC Rotational Torque: 20-144gcm Angle of Rotation: Total rotation: 300° ±5°, Effective Rotation: 280° (Approximately) Stops: 0.57 N-m Minimum Stop Strength Shaft Information: Length: 13.72mm Beyond Cover, Style: Knurled, Diameter: 6mm. Mounting Information: P.C. Board Mounting

| Fig. | Res. Ω | Description | Digi-Key Part No. | Price Each | | | | CTS Part No. |
|------|------------|-------------|-------------------|------------|------|------|-------------|--------------|
| | | | | 1 | 10 | 50 | 100 | |
| 1 | 500 | Vertical | CT2261-ND | 1.51 | 1.26 | 1.05 | .84 | 296UD501B1N |
| | 1K | Vertical | CT2262-ND | 1.51 | 1.26 | 1.05 | .84 | 296UD102B1N |
| | 2.5K | Vertical | CT2263-ND | 1.51 | 1.26 | 1.05 | .84 | 296UD252B1N |
| | 5K | Vertical | CT2264-ND | 1.51 | 1.26 | 1.05 | .84 | 296UD502B1N |
| | 10K | Vertical | CT2265-ND | 1.51 | 1.26 | 1.05 | .84 | 296UD103B1N |
| | 25K | Vertical | CT2266-ND | 1.51 | 1.26 | 1.05 | .84 | 296UD253B1N |
| | 50K | Vertical | CT2267-ND | 1.51 | 1.26 | 1.05 | .84 | 296UD503B1N |
| | 100K | Vertical | CT2268-ND | 2.01 | 1.68 | 1.40 | 1.12 | 296UD104B1N |
| | 250K | Vertical | CT2269-ND | 1.51 | 1.26 | 1.05 | .84 | 296UD254B1N |
| | 500K | Vertical | CT2270-ND | 1.51 | 1.26 | 1.05 | .84 | 296UD504B1N |
| 1MEG | Vertical | CT2271-ND | 1.51 | 1.26 | 1.05 | .84 | 296UD105B1N | |
| 2 | 500 | Horizontal | CT2250-ND | 1.51 | 1.26 | 1.05 | .84 | 296XD501B1N |
| | 1K | Horizontal | CT2251-ND | 1.51 | 1.26 | 1.05 | .84 | 296XD102B1N |
| | 2.5K | Horizontal | CT2252-ND | 1.51 | 1.26 | 1.05 | .84 | 296XD252B1N |
| | 5K | Horizontal | CT2253-ND | 2.01 | 1.68 | 1.40 | 1.12 | 296XD502B1N |
| | 10K | Horizontal | CT2254-ND | 1.51 | 1.26 | 1.05 | .84 | 296XD103B1N |
| | 25K | Horizontal | CT2255-ND | 1.51 | 1.26 | 1.05 | .84 | 296XD253B1N |
| | 50K | Horizontal | CT2256-ND | 1.51 | 1.26 | 1.05 | .84 | 296XD503B1N |
| | 100K | Horizontal | CT2257-ND | 1.51 | 1.26 | 1.05 | .84 | 296XD104B1N |
| | 250K | Horizontal | CT2258-ND | 1.51 | 1.26 | 1.05 | .84 | 296XD254B1N |
| | 500K | Horizontal | CT2259-ND | 1.51 | 1.26 | 1.05 | .84 | 296XD504B1N |
| 1MEG | Horizontal | CT2260-ND | 1.51 | 1.26 | 1.05 | .84 | 296XD105B1N | |

RoHS Compliant

More Product Available Online: www.digkey.com

Toll-Free: 1-800-344-4539 • Phone 218-681-6674 • Fax: 218-681-3380

(T091) 1943

MIL Style RV6 – 1/2 Watt Carbon Potentiometers

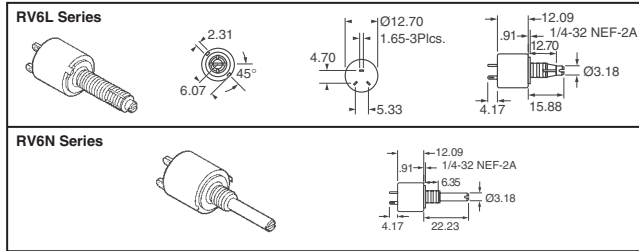

Specifications: • Resistance Tolerance: ±10% through 500K, ±20% from 1Meg • Resistance Taper: Linear • Power Rating: .5 Watts @ 70°C • Dielectric Strength: 750V RMS • Working Voltage: 350VDC maximum, but power not to exceed rating • Operating Temperature: -65°C ~ 125°C • Mechanical Rotation: 295° QPL listed under MIL R 94 Specifications. Metal housing, stainless steel shaft • Hardware included

Resistance Code Chart

| Code (Value) | Code (Value) | Code (Value) | Code (Value) | Code (Value) |
|--------------|--------------|--------------|--------------|--------------|
| 101 (100) | 102 (1K) | 103 (10K) | 104 (100K) | 105 (1Meg) |
| 251 (250) | 252 (2.5K) | 253 (25K) | 254 (250K) | 505 (5Meg) |
| 501 (500) | 502 (5K) | 503 (50K) | 504 (500K) | |

| Resistance Range (Ω) | Digi-Key† Part No. | 1 | 10 | 50 | 100 | 250 | Precision Part No. |
|----------------------|--------------------|-------|-------|------|------|------|--------------------|
| 100-5Meg | RV6L□□□C-ND | 11.83 | 10.92 | 8.19 | 5.28 | 4.85 | RV6LAYSA(Code)A |
| 100-1Meg | RV6N□□□C-ND | 10.73 | 9.90 | 7.43 | 4.79 | 4.39 | RV6NAYSJ(Code)A |

† For complete number, substitute corresponding code (from Resistance Code Chart) for □□□.

Wirewound Precision Ten-Turn 2 Watt Potentiometers

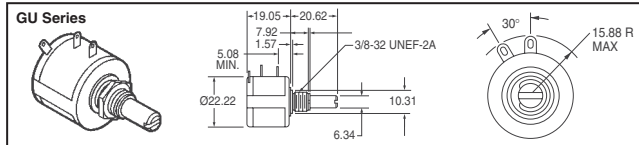

Specifications: • Resistance Tolerance: ±5% • Electrical/Mechanical Rotation: 3600° ± 10° 0° • Effective Rotation: 3600° nominal • Dielectric Strength: 1000 VAC for 60 seconds at ATM • Working Voltage: 500 volts maximum • Power rating: 2 watt at 70°C • Shaft Length and Size: 13/16" (20.64mm) FMS screwdriver slotted, stainless steel • Bushing Style: 5/16" (7.95mm) • Temperature Coefficient: ± 20 PPM/°C • Hardware included

Resistance Code Chart

| Code (Value) | Code (Value) | Code (Value) |
|--------------|--------------|--------------|
| 101 (100) | 202 (2K) | 253 (25K) |
| 201 (200) | 502 (5K) | 503 (50K) |
| 501 (500) | 103 (10K) | 104 (100K) |
| 102 (1K) | 203 (20K) | |

| Resistance Range (Ω) | Digi-Key† Part No. | 1 | 10 | 50 | 100 | 250 | Precision Part No. |
|----------------------|--------------------|-------|-------|-------|-------|-------|--------------------|
| 100-100K | GU□□□1S26-ND | 17.88 | 14.76 | 13.86 | 13.32 | 12.18 | GU(Code)1S26 |

† For complete number, substitute corresponding code (from Resistance Code Chart) for □□□.

Type SPR Washable 1/2 Watt Carbon Potentiometers

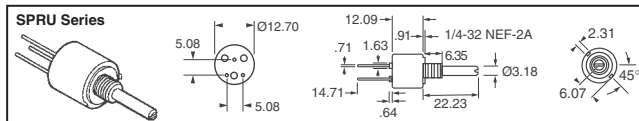

Specifications: • Resistance Tolerance: ±10% through 500K, ±20% from 1Meg ~ 5Meg • Resistance Taper: Linear • Power Rating: .5 Watts @ 70°C • Dielectric Strength: 750V RMS • Working Voltage: 350VDC maximum, but power not to exceed rating • Operating Temperature: -65°C ~ 125°C • Mechanical Rotation: 295° • Hardware included

Meets or exceeds MIL R 94 Specifications. Metal housing, stainless steel shaft.

Resistance Code Chart

| Code (Value) | Code (Value) | Code (Value) | Code (Value) |
|--------------|--------------|--------------|--------------|
| 101 (100) | 252 (2.5K) | 503 (50K) | 105 (1Meg) |
| 251 (250) | 502 (5K) | 104 (100K) | 255 (2.5Meg) |
| 501 (500) | 103 (10K) | 254 (250K) | 505 (5Meg) |
| 102 (1K) | 253 (25K) | 504 (500K) | |

| Resistance Range (Ω) | Digi-Key† Part No. | 1 | 10 | 50 | 100 | 250 | Precision Part No. |
|----------------------|--------------------|------|------|------|------|------|--------------------|
| 100-5Meg | SPRU□□□C-ND | 8.66 | 7.83 | 6.66 | 5.53 | 4.83 | SPRU(Code)1S28 |

† For complete number, substitute corresponding code (from Resistance Code Chart) for □□□.

MIL Style – 2 Watt Carbon Potentiometers

RV4L, RV4N, RV4NJ-(Linear Taper Single Element)

KA (Logarithmic Taper Single Element)

KB (Reverse Logarithmic Taper Single Element)

KU (High Life* Linear Taper Single Element)

*Rotational Life: 100,000 cycles

KKK (Logarithmic Taper Dual Element)

KKB (Reverse Logarithmic Taper Dual Element)

KKU (Linear Taper Dual Element)

Specifications:

• Resistance Tolerance: ±10% through 500K, ±20% from 1Meg

• Power Rating: 2 Watts @ 70°C, Derate to 0 Watt @ 120°C

• Dielectric Strength: 900V RMS

• Working Voltage: 500 volts, but power not to exceed rating

• Operating Temperature: -65°C ~ 125°C

• Mechanical Rotation: 314° QPL listed under MIL R 94 Specifications. Metal housing, stainless steel shaft. • Hardware included

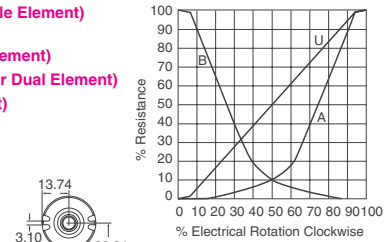

U = Linear Taper
A = Logarithmic Taper
B = Reverse Logarithmic Taper

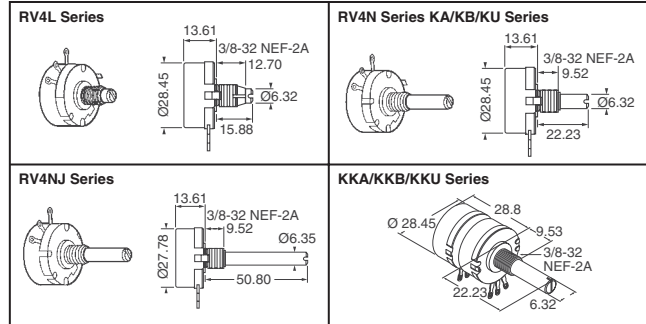

| RV4L SERIES (LINEAR) | | | | KA SERIES (LOG TAPER) | |
|----------------------|--------------|--------------|--------------|-----------------------|--------------|
| Code (Value) | Code (Value) | Code (Value) | Code (Value) | Code (Value) | Code (Value) |
| 500 (50) | 102 (1K) | 153 (15K) | 104 (100K) | 502 (5K) | 104 (100K) |
| 101 (100) | 252 (2.5K) | 253 (25K) | 254 (250K) | 103 (10K) | 254 (250K) |
| 251 (250) | 502 (5K) | 353 (35K) | 504 (500K) | 253 (25K) | 504 (500K) |
| 501 (500) | 103 (10K) | 503 (50K) | 105 (1Meg) | 503 (50K) | 105 (1Meg) |

| RV4N SERIES (LINEAR) | | | | RV4NJ SERIES (LINEAR) | |
|----------------------|--------------|--------------|--------------|-----------------------|--------------|
| Code (Value) | Code (Value) | Code (Value) | Code (Value) | Code (Value) | Code (Value) |
| 500 (50) | 501 (500) | 502 (5K) | 253 (25K) | 254 (250K) | 502 (5K) |
| 101 (100) | 102 (1K) | 752 (7.5K) | 353 (35K) | 504 (500K) | 101 (100) |
| 151 (150) | 152 (1.5K) | 103 (10K) | 503 (50K) | 105 (1Meg) | 251 (250) |
| 251 (250) | 252 (2.5K) | 153 (15K) | 104 (100K) | | 102 (1K) |
| | | | | | 252 (2.5K) |

| KB SERIES (REV LOG) | | KKA SERIES (DUAL LOG) | | KKB SERIES (DUAL REV LOG) | | KKU SERIES (DUAL LINEAR) |
|---------------------|--------------|-----------------------|--------------|---------------------------|--------------|--------------------------|
| Code (Value) | Code (Value) | Code (Value) | Code (Value) | Code (Value) | Code (Value) | Code (Value) |
| 102 (1K) | 104 (100K) | 102 (1K) | 104 (100K) | 102 (1K) | 104 (100K) | |
| 502 (5K) | 254 (250K) | 502 (5K) | 254 (250K) | 502 (5K) | 254 (250K) | |
| 103 (10K) | 504 (500K) | 103 (10K) | 504 (500K) | 103 (10K) | 504 (500K) | 102 (1K) |
| 253 (25K) | 105 (1Meg) | 253 (25K) | 105 (1Meg) | 253 (25K) | 105 (1Meg) | 502 (5K) |
| 503 (50K) | | 503 (50K) | | 503 (50K) | | 103 (10K) |

| Resistance Range (Ω) | Digi-Key† Part No. | 1 | 10 | 50 | 100 | 250 | Precision Part No. |
|----------------------|--------------------|-------|-------|-------|-------|-------|--------------------|
| 50-1Meg | RV4L□□□C-ND | 8.37 | 7.57 | 6.44 | 5.35 | 4.67 | RV4LAYSA(Code)A |
| 50-1Meg | RV4N□□□C-ND | 8.01 | 7.24 | 6.16 | 5.12 | 4.47 | RV4NAYSJ(Code)A |
| 50-1Meg | RV4NJ□□□C-ND | 8.01 | 7.24 | 6.16 | 5.12 | 4.47 | RV4NAYSJ(Code)A |
| 5K-1Meg | KA□□□1S28-ND | 11.44 | 10.34 | 8.80 | 7.31 | 6.38 | KA(Code)1S28 |
| 5K | KU5021S28-HL-ND | 11.54 | 10.44 | 8.88 | 7.38 | 6.44 | KU5021S28-HL |
| 1K-1Meg | KB□□□1S28-ND | 11.44 | 10.34 | 8.80 | 7.31 | 6.38 | KB(Code)1S28 |
| 1K-1Meg | KKA□□□1S28-ND | 32.42 | 29.31 | 24.94 | 20.71 | 18.09 | KKA(Code)1S28 |
| 1K-1Meg | KKB□□□1S28-ND | 32.42 | 29.31 | 24.94 | 20.71 | 18.09 | KKB(Code)1S28 |
| 1K-10K | KKU□□□1S28-ND | 26.18 | 23.67 | 20.14 | 16.72 | 14.61 | KKU(Code)1S28 |

† For complete number, substitute corresponding code (from Resistance Code Chart) for □□□.

Model 15 Turns Counting Dial

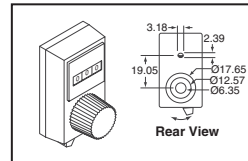

E15-1-11-ND: The left digit indicates the number of complete revolutions of the turning knob and the right two digits indicate the percent of a revolution. The unit registers a total count of 999.
E15-2-11-ND: The left two digits indicate the number of complete revolutions of the turning knob and the right two digits indicate the percent of a revolution. The unit registers a total count of 9999.

| Description | Digi-Key Part No. | Price Each | Precision Part No. |
|---------------------------------|-------------------|------------|--------------------|
| Digital Dial (3 Digit/10 turn) | E15-1-11-ND | 30.15 | E15-1-11 |
| Digital Dial (4 Digit/100 turn) | E15-2-11-ND | 34.62 | E15-2-11 |

More Product Available Online: www.digikey.com