

Threaded Standoffs

- Brass: ASTM-B16
- Plating: Zinc (ASTM B633)
- Aluminum: QQ-A-225/3, Alloy 2011-T3
- Plating: Clear Iridite (Mil-C-5541)

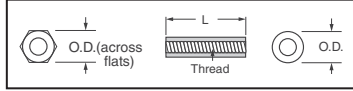

Note: Spacers over 1.000 long are tapped .375 deep each end.

Thread	O.D.	"L" Length (Inch)	Hex Thread Part No.	Pricing		Round Thread Part No.	Pricing	
				10	100		10	100
Aluminum								
2-56	.156	.187	1797AK-ND	5.55	45.60	1801AK-ND	5.22	42.90
		.250	1797BK-ND	5.96	48.90	1801BK-ND	5.16	42.60
		.312	1797CK-ND	6.20	51.00	1801CK-ND	5.58	46.10
		.375	1797DK-ND	6.39	52.55	1801DK-ND	6.45	53.10
4-40	.187	.250	1891K-ND	3.36	20.45	2025K-ND	3.33	20.05
		.375	1892K-ND	3.95	23.80	2026K-ND	3.85	23.60
		.500	1893K-ND	4.35	27.80	2027K-ND	4.24	25.70
		.625	1894K-ND	4.47	30.25	2028K-ND	4.39	28.15
		.750	1895K-ND	4.96	33.95	2029K-ND	4.89	32.60
		.875	1896K-ND	5.45	37.55	2030K-ND	5.35	35.15
1.000	1897K-ND	5.98	49.10	2031K-ND	5.98	49.10		
4-40	.250	.250	2201K-ND	3.25	20.15	3478K-ND	2.95	17.30
		.375	2202K-ND	3.64	22.15	3479K-ND	3.26	20.15
		.500	2203K-ND	4.03	24.50	3480K-ND	3.67	21.70
		.625	1808K-ND	4.34	26.90	1839K-ND	3.98	31.90
		.750	2204K-ND	4.29	29.25	3481K-ND	4.47	26.90
		.875	1809K-ND	4.89	40.50	1846K-ND	4.82	39.60
		1.000	2205K-ND	5.45	45.05	3482K-ND	5.32	43.85
		1.500	2206K-ND	9.29	76.25	3483K-ND	8.99	73.85
		2.000	2207K-ND	10.72	88.30	3484K-ND	10.41	85.50
		6-32	.250	.250	2208K-ND	3.25	20.15	3485K-ND
.375	2209K-ND			3.64	22.15	3486K-ND	3.26	20.15
.500	2210K-ND			4.03	24.50	3487K-ND	3.67	21.70
.625	1813K-ND			4.59	27.40	1847K-ND	4.36	31.40
.750	2211K-ND			4.29	29.25	3488K-ND	4.47	26.90
.875	1816K-ND			4.57	31.00	1848K-ND	4.30	29.40
1.000	2212K-ND			5.45	45.05	3489K-ND	5.32	43.85
1.250	1818K-ND			8.23	67.60	1853K-ND	8.06	66.35
1.500	2213K-ND			9.29	76.25	3490K-ND	8.99	73.85
1.750	1819K-ND			9.70	79.80	1855K-ND	9.54	78.50
2.000	2214K-ND			10.72	88.30	3491K-ND	10.41	85.50
2.250	1820K-ND			11.90	97.80	1856K-ND	11.58	95.20
2.500	1825K-ND			12.08	107.10	1857K-ND	11.79	104.50
8-32	.250			.250	2215K-ND	3.25	20.15	3492K-ND
		.375	2216K-ND	3.64	22.15	3493K-ND	3.26	20.15
		.500	2217K-ND	4.03	24.50	3494K-ND	3.67	21.70
		.625	1827K-ND	4.44	31.90	1858K-ND	3.98	24.75
		.750	2218K-ND	4.19	34.30	3495K-ND	4.47	26.90
		.875	1828K-ND	5.21	42.75	1859K-ND	4.33	29.05
		1.000	2219K-ND	5.45	45.05	3496K-ND	5.32	43.85
		1.500	2220K-ND	9.29	76.25	3497K-ND	10.44	84.25
2.000	2221K-ND	10.72	88.30	3498K-ND	10.41	85.50		
8-32	.375	.375	1926AK-ND	4.80	39.60	2315AK-ND	7.10	61.90
		.500	1926BK-ND	5.03	41.20	2315BK-ND	7.97	65.50
		.625	1926CK-ND	6.58	54.00	2315CK-ND	8.59	70.60
		.750	1926DK-ND	7.64	62.75	2315DK-ND	9.21	75.70
		1.000	1926EK-ND	8.61	74.01	2315EK-ND	10.20	87.99
Brass								
2-56	.156	.187	1798AK-ND	6.76	55.65	1802AK-ND	6.39	52.70
		.250	1798BK-ND	8.07	66.35	1802BK-ND	6.87	56.45
		.312	1798CK-ND	9.71	79.85	1802CK-ND	7.12	58.65
		.375	1798DK-ND	10.45	86.10	1802DK-ND	7.12	58.65
4-40	.187	.250	1450K-ND	4.67	26.90	1547K-ND	4.69	24.80
		.375	1803K-ND	5.47	30.85	1864K-ND	5.40	37.40
		.500	1656K-ND	5.61	36.45	1657K-ND	5.55	35.80
		.625	1804K-ND	6.82	49.15	1865K-ND	6.80	42.15
		.750	1656AK-ND	7.71	46.60	1657AK-ND	7.51	45.40
		.875	1805K-ND	9.46	60.30	1866K-ND	9.44	58.20
1.000	1656BK-ND	9.94	60.30	1657BK-ND	9.86	57.80		
4-40	.250	.250	1450AK-ND	4.36	24.95	1547AK-ND	5.02	36.05
		.375	1450BK-ND	5.46	28.85	1547BK-ND	5.88	42.15
		.500	1450CK-ND	5.52	36.25	1547CK-ND	6.27	51.45
		.625	1829K-ND	7.46	49.00	1867K-ND	7.08	58.20
		.750	1450DK-ND	8.53	57.25	1547DK-ND	7.93	65.30
		.875	1830K-ND	9.08	59.50	1876K-ND	8.94	73.50
		1.000	1450EK-ND	9.61	63.29	1547EK-ND	4.11	24.80
		1.500	1831K-ND	16.88	149.60	1877K-ND	16.49	143.30
		2.000	1832K-ND	17.30	153.40	1878K-ND	19.98	173.70
		6-32	.250	.250	1451AK-ND	4.36	24.95	1548AK-ND
.375	1451BK-ND			5.46	28.85	1548BK-ND	4.76	26.90
.500	1451CK-ND			5.52	36.25	1548CK-ND	5.55	34.85
.625	1451DK-ND			7.46	49.00	1548DK-ND	6.07	46.60
.750	1451EK-ND			7.32	55.60	1548EK-ND	6.60	54.32
.875	1833K-ND			9.08	59.50	1879K-ND	8.51	58.05
1.000	1635K-ND			9.61	57.80	1548FK-ND	8.84	56.90
1.250	1636K-ND			12.51	102.85	1881K-ND	12.27	101.05
1.500	1637K-ND			14.46	118.80	1882K-ND	16.38	145.05
1.750	1638K-ND			17.10	151.45	1883K-ND	16.59	146.95
2.000	1639K-ND	17.30	153.40	1884K-ND	16.74	148.30		

Thread	O.D.	"L" Length (Inch)	Hex Thread Part No.	Pricing		Round Thread Part No.	Pricing	
				10	100		10	100
6-32	.250	2.250	1642K-ND	17.66	156.40	1885K-ND	17.17	151.90
		2.500	1643K-ND	18.17	160.75	1886K-ND	17.66	156.40
8-32	.250	.250	1474AK-ND	4.36	27.80	1692AK-ND	5.26	43.20
		.375	1474BK-ND	5.46	28.85	1692BK-ND	5.51	45.40
		.500	1474CK-ND	5.52	36.25	1692CK-ND	7.02	57.75
		.625	1834K-ND	7.46	49.00	1877K-ND	8.03	65.85
		.750	1474DK-ND	8.53	57.25	1692DK-ND	9.51	78.15
		.875	1836K-ND	9.77	62.90	1888K-ND	9.10	75.05
		1.000	1474EK-ND	8.23	56.24	1692EK-ND	8.40	78.36
		1.500	1837K-ND	16.88	149.60	1889K-ND	16.38	145.05
		2.000	1838K-ND	17.30	153.40	1899K-ND	17.60	156.05
		8-32	.375	.375	1452AK-ND	9.84	79.35	1549AK-ND
.500	1452BK-ND			9.85	80.90	1549BK-ND	11.14	91.65
.625	1452CK-ND			14.62	117.95	1549CK-ND	14.23	115.00
.750	1452DK-ND			13.84	111.65	1549DK-ND	15.60	125.95
1.000	1452EK-ND			16.45	141.44	1549EK-ND	16.97	158.25

◆ RoHS Compliant

1/4" Hex Threaded Standoff Kit

Aluminum - Assortment of 1500 pieces in 1/4", 3/8", 1/2", 3/4" and 1" lengths with thread sizes of 4-40, 6-32 and 8-32. 100 pieces of each size complete with cabinet.

STH-22KIT-ND (RoHS Compliant) \$738.15

Male/Female .250" Hex Threaded Standoffs

- Brass: ASTM-B16
- Plating: Nickel (QQ-N-290)

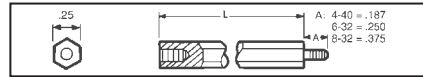

- Aluminum: QQ-Q-225/3
- Plating: Clear Iridite (Mil-C-5541)

Length (Inch)	4-40 Thread Part No.	Pricing		6-32 Thread Part No.	Pricing		8-32 Thread Part No.	Pricing	
		10	100		10	100		10	100
Aluminum									
.250	8714K-ND*	3.77	26.80	8717K-ND*	4.18	29.80	—	—	—
.375	8400K-ND†	4.28	30.35	8413K-ND†	4.43	31.55	8426K-ND†	5.13	41.60
.500	8401K-ND	5.22	42.40	8414K-ND	4.49	31.80	8427K-ND	5.22	42.40
.625	8402K-ND	5.62	45.45	8415K-ND	4.96	40.10	8428K-ND	5.62	45.45
.750	8403K-ND	5.71	46.35	8416K-ND	5.00	40.60	8429K-ND	5.98	48.55
.875	8404K-ND	6.20	50.35	8417K-ND	5.44	44.15	8430K-ND	6.64	53.90
1.000	8405K-ND	6.56	53.20	8418K-ND	5.71	46.35	8431K-ND	7.05	57.15
1.125	8406K-ND	8.03	65.00	8419K-ND	5.89	47.75	8432K-ND	9.45	77.85
1.250	8407K-ND	8.12	65.90	8420K-ND	6.29	51.00	8433K-ND	9.79	80.50
1.375	8408K-ND	9.51	78.25	8421K-ND	7.14	57.90	8434K-ND	10.57	86.95
1.500	8409K-ND	9.73	79.95	8422K-ND	8.16	66.35	8435K-ND	10.68	87.90
1.625	8410K-ND	10.01	82.40	8423K-ND	8.29	67.20	8436K-ND	10.79	88.60
1.750	8411K-ND	10.24	84.15	8424K-ND	8.89	70.60	8437K-ND	10.90	89.85
2.000	8412K-ND	10.57	86.95	8425K-ND	8.87	72.15	8438K-ND	11.02	90.65
Brass									
.250	8713K-ND*	5.43	38.55	8716K-ND*	5.30	37.60	—	—	—
.375	7200K-ND†	5.25	42.50	7210K-ND†	5.41	44.00	7220K-ND†	6.29	50.90
.500	1944K-ND	6.85	55.60	1952K-ND	5.91	47.95	1957K-ND	6.36	51.45
.625	1945K-ND	6.96	56.30	1953K-ND	7.51	60.80	1958K-ND	8.84	71.65
.750	1946K-ND	8.28	67.20	1954K-ND	7.89	64.10	1959K-ND	9.28	75.50
.875	7201K-ND	8.39	68.10	7211K-ND	9.06	73.50	7221K-ND	10.16	82.40
1.000	1947K-ND	9.28	75.50	1644K-ND	9.33</				