

# CTS Wirewound Potentiometers - 5 Watt

Series 026

**SPECIFICATIONS:** Resistance Range: 50 - 25KΩ Resistance Tolerance: ±20% Power Rating Watts: 5 Watts @ 25°C Derated to No Load @ 105°C Voltage Rating: Operating maximum 500VDC Shaft Information: 1" FMS x 250" (25.40mm FMS x 6.35mm) Diameter, Metal, Plain Round Angle of Rotation: 300° ±5° Bushing Information: Diameter: EIA Std. 3/8"-32, UNEF-2A Thread Length: 3/8" ± 1/64" (9.52mm ± 0.40mm) Terminal Information: Solder Lug, Formed to Rear Locating Lug: Left Side, Terminals Down

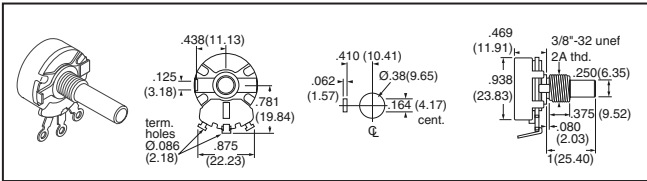

Res. Ω	Digi-Key Part No.	Price Each				CTS Part No.
		1	10	50	100	
5	CT2150-ND	3.61	3.36	2.79	2.52	026TB32R5A0B1A1
10	CT2151-ND	3.61	3.36	2.79	2.52	026TB32R100B1A1
25	CT2152-ND	3.61	3.36	2.79	2.52	026TB32R250B1A1
50	CT2153-ND	3.61	3.36	2.79	2.52	026TB32R500B1A1
100	CT2154-ND	3.61	3.36	2.79	2.52	026TB32R101B1A1
250	CT2155-ND	3.61	3.36	2.79	2.52	026TB32R251B1A1
500	CT2156-ND	3.61	3.36	2.79	2.52	026TB32R501B1A1
1K	CT2157-ND	3.61	3.36	2.79	2.52	026TB32R102B1A1
5K	CT2158-ND	3.61	3.36	2.79	2.52	026TB32R502B1A1
10K	CT2159-ND	3.61	3.36	2.79	2.52	026TB32R103B1A1
25K	CT2160-ND	3.61	3.36	2.79	2.52	026TB32R253B1A1

RoHS Compliant

# Carbon Potentiometers - 1/4 Watt

Series 270

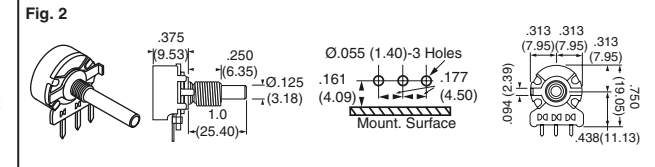
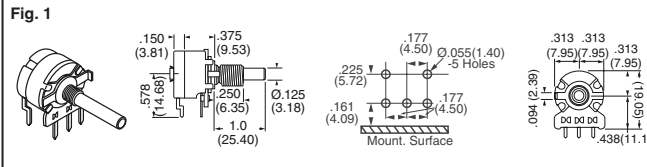

**SPECIFICATIONS:** Resistance Range: 500Ω through 1MΩ Resistance Tolerance: ±20% Power Rating Watts: 1/4 Watt through 100K, 1/5 Watt above 100K Voltage Rating: Operating Maximum: 500VDC Mechanical Rotation: 300° ±5° Available Power Switch: Type: Rotary Rating: 3A @ 125VAC (UL Approved)

Effective Rotation: Without Switch 300° (Approx.), with Switch 290° (Approx.) Resistance Taper: Linear, Logarithmic Locating Lug: Left Side, Terminals Down Bushing Information: Length: 1/4" (6.35mm), Thread Size: 1/4"-32, diameter: 1/4" (6.35mm) Shaft Information: Length: 1" (25.40mm) including bushing, Diameter: .125" (3.18mm)

Digi-Key Part No.	Price Each				
	1	10	50	100	250
CT2223-ND - CT2233-ND	3.48	3.24	2.69	2.43	2.16
CT2201-ND - CT2211-ND	2.71	2.52	2.10	1.89	1.68
CT2212-ND - CT2222-ND	3.53	3.28	2.73	2.46	2.19
CT2234-ND - CT2244-ND	2.77	2.58	2.15	1.94	1.72

Linear Taper with Switch Fig. 1			Linear Taper without Switch Fig. 2			Logarithmic Taper with Switch Fig. 1			Logarithmic Taper without Switch Fig. 2		
Res. Ω	Digi-Key Part No.	CTS Part No.	Res. Ω	Digi-Key Part No.	CTS Part No.	Res. Ω	Digi-Key Part No.	CTS Part No.	Res. Ω	Digi-Key Part No.	CTS Part No.
500	CT2223-ND	270X232A501B1B1	500	CT2201-ND	270X232A501B1A1	500	CT2212-ND	270X232A501B2B1	500	CT2234-ND	270X232A501B2A1
1K	CT2224-ND	270X232A102B1B1	1K	CT2202-ND	270X232A102B1A1	1K	CT2213-ND	270X232A102B2B1	1K	CT2235-ND	270X232A102B2A1
2.5K	CT2225-ND	270X232A252B1B1	2.5K	CT2203-ND	270X232A252B1A1	2.5K	CT2214-ND	270X232A252B2B1	2.5K	CT2236-ND	270X232A252B2A1
5K	CT2226-ND	270X232A502B1B1	5K	CT2204-ND	270X232A502B1A1	5K	CT2215-ND	270X232A502B2B1	5K	CT2237-ND	270X232A502B2A1
10K	CT2227-ND	270X232A103B1B1	10K	CT2205-ND	270X232A103B1A1	10K	CT2216-ND	270X232A103B2B1	10K	CT2238-ND	270X232A103B2A1
25K	CT2228-ND	270X232A253B1B1	25K	CT2206-ND	270X232A253B1A1	25K	CT2217-ND	270X232A253B2B1	25K	CT2239-ND	270X232A253B2A1
50K	CT2229-ND	270X232A503B1B1	50K	CT2207-ND	270X232A503B1A1	50K	CT2218-ND	270X232A503B2B1	50K	CT2240-ND	270X232A503B2A1
100K	CT2230-ND	270X232A104B1B1	100K	CT2208-ND	270X232A104B1A1	100K	CT2219-ND	270X232A104B2B1	100K	CT2241-ND	270X232A104B2A1
250K	CT2231-ND	270X232A254B1B1	250K	CT2209-ND	270X232A254B1A1	250K	CT2220-ND	270X232A254B2B1	250K	CT2242-ND	270X232A254B2A1
500K	CT2232-ND	270X232A504B1B1	500K	CT2210-ND	270X232A504B1A1	500K	CT2221-ND	270X232A504B2B1	500K	CT2243-ND	270X232A504B2A1
1MEG	CT2233-ND	270X232A105B1B1	1MEG	CT2211-ND	270X232A105B1A1	1MEG	CT2222-ND	270X232A105B2B1	1MEG	CT2244-ND	270X232A105B2A1

RoHS Compliant

# Carbon Potentiometers - 1/8 Watt

Series 296

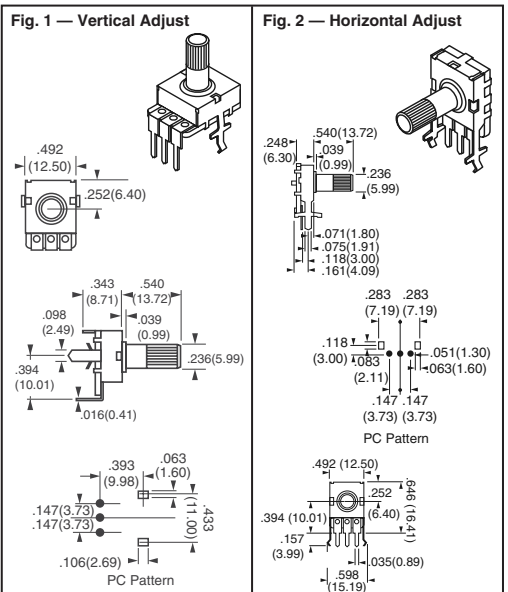

**SPECIFICATIONS:**

Resistance Range: 500Ω - 1MΩ Resistance tolerance: ±20% Power Rating Watts: 0.15 Watts @ 40°C derated to no load @ 85°C Voltage Rating: Across End Terminals: 250VDC Rotational Torque: 20-144gcm Angle of Rotation: Total rotation: 300° ±5°, Effective Rotation: 280° (Approximately) Stops: 0.57 N-m Minimum Stop Strength Shaft Information: Length: 13.72mm Beyond Cover, Style: Knurled, Diameter: 6mm. Mounting Information: P.C. Board Mounting

Fig.	Res. Ω	Description	Digi-Key Part No.	Price Each				CTS Part No.
				1	10	50	100	
1	500	Vertical	CT2261-ND	1.51	1.26	1.05	.84	296UD501B1N
	1K	Vertical	CT2262-ND	1.51	1.26	1.05	.84	296UD102B1N
	2.5K	Vertical	CT2263-ND	1.51	1.26	1.05	.84	296UD252B1N
	5K	Vertical	CT2264-ND	1.51	1.26	1.05	.84	296UD502B1N
	10K	Vertical	CT2265-ND	1.51	1.26	1.05	.84	296UD103B1N
	25K	Vertical	CT2266-ND	1.51	1.26	1.05	.84	296UD253B1N
	50K	Vertical	CT2267-ND	1.51	1.26	1.05	.84	296UD503B1N
	100K	Vertical	CT2268-ND	1.51	1.26	1.05	.84	296UD104B1N
	250K	Vertical	CT2269-ND	1.51	1.26	1.05	.84	296UD254B1N
	500K	Vertical	CT2270-ND	1.51	1.26	1.05	.84	296UD504B1N
1MEG	Vertical	CT2271-ND	1.51	1.26	1.05	.84	296UD105B1N	
2	500	Horizontal	CT2250-ND	1.51	1.26	1.05	.84	296XD501B1N
	1K	Horizontal	CT2251-ND	1.51	1.26	1.05	.84	296XD102B1N
	2.5K	Horizontal	CT2252-ND	1.51	1.26	1.05	.84	296XD252B1N
	5K	Horizontal	CT2253-ND	1.51	1.26	1.05	.84	296XD502B1N
	10K	Horizontal	CT2254-ND	1.51	1.26	1.05	.84	296XD103B1N
	25K	Horizontal	CT2255-ND	1.51	1.26	1.05	.84	296XD253B1N
	50K	Horizontal	CT2256-ND	1.51	1.26	1.05	.84	296XD503B1N
	100K	Horizontal	CT2257-ND	1.51	1.26	1.05	.84	296XD104B1N
	250K	Horizontal	CT2258-ND	1.51	1.26	1.05	.84	296XD254B1N
	500K	Horizontal	CT2259-ND	1.51	1.26	1.05	.84	296XD504B1N
1MEG	Horizontal	CT2260-ND	1.51	1.26	1.05	.84	296XD105B1N	

RoHS Compliant

More Product Available Online: [www.digkey.com](http://www.digkey.com)

