

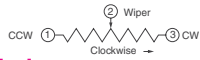

Trimmer Potentiometers

SERIES 3214 — Surface Mount 4mm Square/Multi-Turn Cermet/Industrial/Sealed



Features: • Sealed to withstand board wash processing • Pick and place centering design, with flush adjustment • Patent #5047746 advanced drive/wiper mechanism **Characteristics:** • **Resistance Tolerance:** ±10% standard • **Absolute Minimum Resistance:** 1% or 2.0Ω (whichever is greater) • **Contact Resistance Variation:** 3% or 3Ω maximum • **Resolution:** Essentially Infinite • **Insulation Resistance:** 500VDC, 100MΩ minimum • **Dielectric Strength:** Sea Level: 600VAC (1 minute) • **Adjustment Angle:** 5 turns nominal • **Power Rating (300V max.):** 85°C = 0.25W, 150°C = 0W • **Temperature Range:** -65°C - 150°C • **Temperature Coefficient:** ±100ppm/°C • **Humidity:** MIL-STD 202 Method 106, TRS ±2%, IR 10MΩ • **Load Life (@ 85°C Rated Power 1000 Hours):** TRS 3Ω or 3% (whichever is greater) • **Vibration:** 20G TRS ±1%, VRS ±1% • **Shock:** 100G TRS ±1%, VRS ±1% • **Rotational Cycling:** 200 cycles, TRS 3Ω or 3% (whichever is greater) • **Thermal Shock:** 5 cycles, TRS ±2%, VRS ±1% • **Mechanical Stop:** Wiper idles • **Torque:** 180g-cm maximum • **Weight:** Approximately 0.01 oz. • **Marking:** Manufacturer's code, resistance code and date code • **Solderability:** Per MIL-STD-202, Method 208 • **Wiper:** Set at 50% nominal • **Flammability:** UL 94V-0

Dim. in mm

3214G NEW!

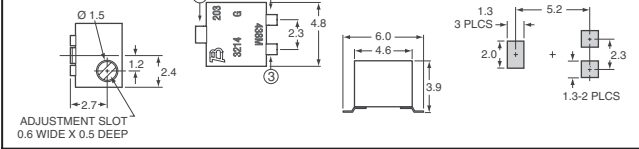

3214J

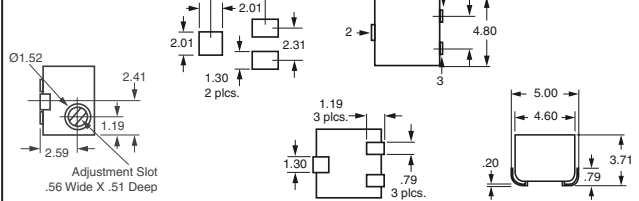

3214W

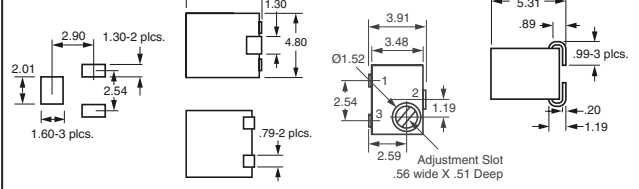

3214X NEW!

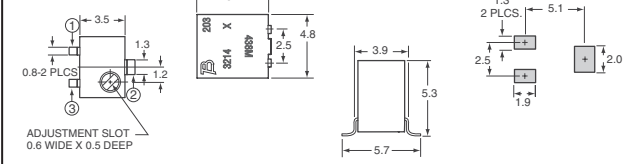

| Res. (Ω) | Digi-Key Part No. | Digi-Key Part No. | Digi-Key Part No. | Digi-Key Part No. |
|----------|--------------------|--------------------|--------------------|--------------------|
| 10 | 3214G-1-100E□□-ND‡ | 3214J-1-100E□□-ND‡ | 3214W-1-100E□□-ND‡ | 3214X-1-100E□□-ND‡ |
| 20 | 3214G-1-200E□□-ND‡ | 3214J-1-200E□□-ND‡ | — | 3214X-1-200E□□-ND‡ |
| 50 | 3214G-1-500E□□-ND‡ | 3214J-1-500E□□-ND‡ | 3214W-1-500E□□-ND‡ | 3214X-1-500E□□-ND‡ |
| 100 | 3214G-1-101E□□-ND‡ | 3214J-1-101E□□-ND‡ | 3214W-1-101E□□-ND‡ | 3214X-1-101E□□-ND‡ |
| 200 | 3214G-1-201E□□-ND‡ | 3214J-1-201E□□-ND‡ | 3214W-1-201E□□-ND‡ | 3214X-1-201E□□-ND‡ |
| 500 | 3214G-1-501E□□-ND‡ | 3214J-1-501E□□-ND‡ | 3214W-1-501E□□-ND‡ | 3214X-1-501E□□-ND‡ |
| 1K | 3214G-1-102E□□-ND‡ | 3214J-1-102E□□-ND‡ | 3214W-1-102E□□-ND‡ | 3214X-1-102E□□-ND‡ |
| 2K | 3214G-1-202E□□-ND‡ | 3214J-1-202E□□-ND‡ | 3214W-1-202E□□-ND‡ | 3214X-1-202E□□-ND‡ |
| 5K | 3214G-1-502E□□-ND‡ | 3214J-1-502E□□-ND‡ | 3214W-1-502E□□-ND‡ | 3214X-1-502E□□-ND‡ |
| 10K | 3214G-1-103E□□-ND‡ | 3214J-1-103E□□-ND‡ | 3214W-1-103E□□-ND‡ | 3214X-1-103E□□-ND‡ |
| 20K | 3214G-1-203E□□-ND‡ | 3214J-1-203E□□-ND‡ | 3214W-1-203E□□-ND‡ | 3214X-1-203E□□-ND‡ |
| 50K | 3214G-1-503E□□-ND‡ | 3214J-1-503E□□-ND‡ | 3214W-1-503E□□-ND‡ | 3214X-1-503E□□-ND‡ |
| 100K | 3214G-1-104E□□-ND‡ | 3214J-1-104E□□-ND‡ | 3214W-1-104E□□-ND‡ | 3214X-1-104E□□-ND‡ |
| 200K | 3214G-1-204E□□-ND‡ | 3214J-1-204E□□-ND‡ | 3214W-1-204E□□-ND‡ | 3214X-1-204E□□-ND‡ |
| 500K | 3214G-1-504E□□-ND‡ | 3214J-1-504E□□-ND‡ | 3214W-1-504E□□-ND‡ | 3214X-1-504E□□-ND‡ |
| 1M | 3214G-1-105E□□-ND‡ | 3214J-1-105E□□-ND‡ | 3214W-1-105E□□-ND‡ | 3214X-1-105E□□-ND‡ |
| 2M | 3214G-1-205E□□-ND‡ | 3214J-1-205E□□-ND‡ | 3214W-1-205E□□-ND‡ | 3214X-1-205E□□-ND‡ |

| Series | Part No. | Cut Tape Pricing | | | Part No. | Tape and Reel Pricing | | |
|--------|-------------|------------------|-------|--------|-------------|-----------------------|--------|--------|
| | | 1 | 10 | 100 | | 200 | 250 | 400 |
| 3214G | Add "CT"-ND | 2.76 | 23.00 | 211.60 | Add "TR"-ND | — | — | 750.00 |
| 3214J | Add "CT"-ND | 3.22 | 27.60 | 239.20 | Add "TR"-ND | — | — | 750.00 |
| 3214W | Add "CT"-ND | 3.22 | 27.60 | 239.20 | Add "TR"-ND | — | 414.00 | 750.00 |
| 3214X | Add "CT"-ND | 2.76 | 23.00 | 211.60 | Add "TR"-ND | 331.20 | — | 600.00 |

‡ NEW!

SERIES 3224 — SMT 4mm Multi-Turn (11) Cermet

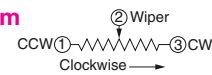

Characteristics:

Resistance Tolerance: ±10% standard • **Absolute Minimum Resistance:** 1% or 2Ω (whichever is greater) • **Contact Resistance Variation:** 1% or 3Ω maximum • **Resolution:** Essentially Infinite • **Insulation Resistance:** 500VDC, 100MΩ minimum • **Dielectric Strength:** Sea Level: 600VAC (1 minute) • **Adjustment Angle:** 11 turns nominal • **Power Rating (300V maximum):** 85°C = 0.25W, 150°C = 0W • **Temperature Range:** -65°C - 150°C • **Temperature Coefficient:** ±100ppm/°C • **Humidity:** MIL-STD 202 Method 106, TRS ±2%, IR 10MΩ • **Vibration:** 20G TRS ±1%, VRS ±1% • **Shock:** 100G TRS ±1%, VRS ±1% • **Load Life (@ 85°C Rated Power 1000 Hours):** TRS 3Ω or 3% (whichever is greater) • **Rotational Cycling:** 200 cycles, TRS 3Ω or 3% (whichever is greater) • **Thermal Shock:** 5 cycles, TRS ±2%, VRS ±1% • **Mechanical Stop:** Wiper idles • **Torque:** 180g-cm maximum • **Weight:** Approximately 0.01 oz. • **Marking:** Manufacturer's code, resistance code and date code

Dim. in mm

3224G — Side Adjust NEW!

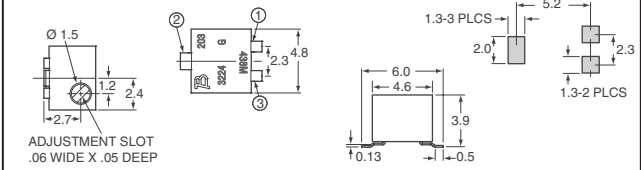

3224J — Side Adjust

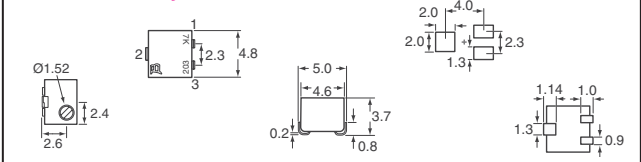

3224W — Top Adjust

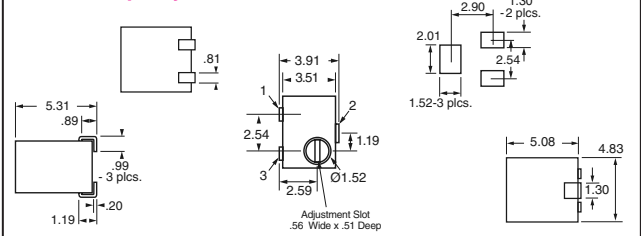

3224X — Top Adjust NEW!

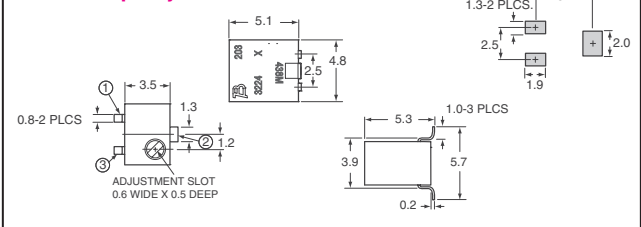

| Res. (Ω) | Digi-Key Part No. | Digi-Key Part No. | Digi-Key Part No. | Digi-Key Part No. |
|----------|--------------------|--------------------|--------------------|--------------------|
| 10 | 3224G-1-100E□□-ND‡ | 3224J-1-100E□□-ND‡ | 3224W-1-101E□□-ND‡ | 3224X-1-100E□□-ND‡ |
| 20 | 3224G-1-200E□□-ND‡ | 3224J-1-200E□□-ND‡ | 3224W-1-201E□□-ND‡ | 3224X-1-200E□□-ND‡ |
| 50 | 3224G-1-500E□□-ND‡ | 3224J-1-500E□□-ND‡ | 3224W-1-501E□□-ND‡ | 3224X-1-500E□□-ND‡ |
| 100 | 3224G-1-101E□□-ND‡ | 3224J-1-101E□□-ND‡ | 3224W-1-501E□□-ND‡ | 3224X-1-101E□□-ND‡ |
| 200 | 3224G-1-201E□□-ND‡ | 3224J-1-201E□□-ND‡ | 3224W-1-102E□□-ND‡ | 3224X-1-201E□□-ND‡ |
| 500 | 3224G-1-501E□□-ND‡ | 3224J-1-501E□□-ND‡ | 3224W-1-102E□□-ND‡ | 3224X-1-501E□□-ND‡ |
| 1K | 3224G-1-102E□□-ND‡ | 3224J-1-102E□□-ND‡ | 3224W-1-202E□□-ND‡ | 3224X-1-102E□□-ND‡ |
| 2K | 3224G-1-202E□□-ND‡ | 3224J-1-202E□□-ND‡ | 3224W-1-202E□□-ND‡ | 3224X-1-202E□□-ND‡ |
| 5K | 3224G-1-502E□□-ND‡ | 3224J-1-502E□□-ND‡ | 3224W-1-502E□□-ND‡ | 3224X-1-502E□□-ND‡ |
| 10K | 3224G-1-103E□□-ND‡ | 3224J-1-103E□□-ND‡ | 3224W-1-103E□□-ND‡ | 3224X-1-103E□□-ND‡ |
| 20K | 3224G-1-203E□□-ND‡ | 3224J-1-203E□□-ND‡ | 3224W-1-203E□□-ND‡ | 3224X-1-203E□□-ND‡ |
| 50K | 3224G-1-503E□□-ND‡ | 3224J-1-503E□□-ND‡ | 3224W-1-503E□□-ND‡ | 3224X-1-503E□□-ND‡ |
| 100K | 3224G-1-104E□□-ND‡ | 3224J-1-104E□□-ND‡ | 3224W-1-104E□□-ND‡ | 3224X-1-104E□□-ND‡ |
| 200K | 3224G-1-204E□□-ND‡ | 3224J-1-204E□□-ND‡ | 3224W-1-204E□□-ND‡ | 3224X-1-204E□□-ND‡ |
| 500K | 3224G-1-504E□□-ND‡ | 3224J-1-504E□□-ND‡ | 3224W-1-504E□□-ND‡ | 3224X-1-504E□□-ND‡ |
| 1M | 3224G-1-105E□□-ND‡ | 3224J-1-105E□□-ND‡ | 3224W-1-105E□□-ND‡ | 3224X-1-105E□□-ND‡ |
| 2M | 3224G-1-205E□□-ND‡ | 3224J-1-205E□□-ND‡ | 3224W-1-205E□□-ND‡ | 3224X-1-205E□□-ND‡ |

| Series | Part No. | Cut Tape Pricing | | | Part No. | Tape and Reel Pricing | | |
|--------|-------------|------------------|-------|--------|-------------|-----------------------|--------|---------|
| | | 1 | 10 | 100 | | 200 | 250 | 400 |
| 3224G | Add "CT"-ND | 4.47 | 37.25 | 342.70 | Add "TR"-ND | — | — | 1214.50 |
| 3224J | Add "CT"-ND | 5.22 | 44.70 | 387.40 | Add "TR"-ND | — | — | 1214.50 |
| 3224W | Add "CT"-ND | 5.22 | 44.70 | 387.40 | Add "TR"-ND | — | 670.50 | 1214.50 |
| 3224X | Add "CT"-ND | 4.47 | 37.25 | 342.70 | Add "TR"-ND | 536.40 | — | 971.60 |

‡ NEW!

Digi-Reel® Most SMT cutdown parts are available on a Digi-Reel®. For Digi-Reel part number, change 1-ND to 6-ND or CT-ND to DKR-ND. See Digi-Key® Services on page 2 for additional information.

More Product Available Online: www.digikey.com

1888 (T083)

Toll-Free: 1-800-344-4539 • Phone 218-681-6674 • Fax: 218-681-3380