

TAIYO YUDEN

Wound Chip Power Inductors



CB Series

The CB Series wound chip inductors can be used for small DC/DC converters and are suited for choke uses.

Applications: • DSC/DVC/HDD • LCD • Portable telephones • Game equipment • Various audio visual equipment • Various communication equipment

Size	Dimensions - Inch (mm)			
	L	W	T	e
0603	0.063±0.2 (1.6±0.2)	0.031±0.008 (0.8±0.2)	0.031±0.008 (0.8±0.2)	0.015±0.006 (0.4±0.15)
0805 (CBC)	0.079±0.008 (2.0±0.2)	0.049±0.008 (1.25±0.2)	0.049±0.008 (1.25±0.2)	0.020±0.008 (0.5±0.2)
0805 (CBL)	0.079±0.008 (2.0±0.2)	0.049±0.008 (1.25±0.2)	0.035±0.004 (0.9±0.1)	0.020±0.008 (0.5±0.2)
0806	0.79±0.008 (2.0±0.2)	0.063±0.008 (1.6±0.2)	0.063±0.008 (1.6±0.2)	0.020±0.008 (0.5±0.2)
1007	0.098±0.008 (2.5±0.2)	0.071±0.008 (1.8±0.2)	0.071±0.008 (1.8±0.2)	0.020±0.008 (0.5±0.2)
1210	0.126±0.008 (3.2±0.2)	0.098±0.008 (2.5±0.2)	0.098±0.008 (2.5±0.2)	0.024±0.012 (0.6±0.3)

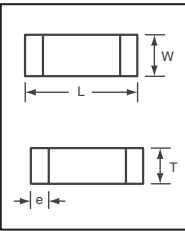

Size	Inductance (µH)	Tolerance	DC Resistance (Ω)	Max. Rated Current (mA)	Digi-Key Part No.	Cut Tape Pricing			Tape & Reel [‡]		Taiyo Yuden Part No.
						10	50	100	Qty.	Pricing	
0603	1.0	20%	0.09	290	587-1717-1-ND	2.60	11.70	20.80	3,000	91.00/M	CBMF1608T1R0M
	2.2	20%	0.17	190	587-1718-1-ND	2.60	11.70	20.80	3,000	91.00/M	CBMF1608T2R2M
	4.7	20%	0.24	145	587-1719-1-ND	2.60	11.70	20.80	3,000	91.00/M	CBMF1608T4R7M
	10	10%	0.36	115	587-1720-1-ND	2.60	11.70	20.80	3,000	91.00/M	CBMF1608T100K
	22	10%	1.0	70	587-1721-1-ND	2.60	11.70	20.80	3,000	91.00/M	CBMF1608T220K
0805	1.0	20%	0.19	700	587-1600-1-ND	2.60	11.70	20.80	3,000	91.00/M	CBG2012T1R0M
	2.2	20%	0.33	530	587-1601-1-ND	2.60	11.70	20.80	3,000	91.00/M	CBG2012T2R2M
	4.7	20%	0.50	360	587-1602-1-ND	2.60	11.70	20.80	3,000	91.00/M	CBG2012T4R7M
	10	20%	1.2	240	587-1603-1-ND	2.60	11.70	20.80	3,000	91.00/M	CBG2012T100M
	22	20%	3.7	170	587-1604-1-ND	2.60	11.70	20.80	3,000	91.00/M	CBG2012T220M
0806	1.0	20%	0.15	620	587-1629-1-ND	2.75	12.38	22.00	4,000	96.00/M	CBG2012T1R0M
	2.2	20%	0.39	440	587-1630-1-ND	2.75	12.38	22.00	4,000	96.00/M	CBG2012T2R2M
	4.7	20%	0.66	275	587-1631-1-ND	2.75	12.38	22.00	4,000	96.00/M	CBG2012T4R7M
	10	20%	1.0	205	587-1632-1-ND	2.75	12.38	22.00	4,000	96.00/M	CBG2012T100M
	22	20%	2.1	150	587-1633-1-ND	2.75	12.38	22.00	4,000	96.00/M	CBG2012T220M
1007	1.0	20%	0.20	1100	587-1608-1-ND	2.45	11.03	19.60	2,000	86.00/M	CBG2016T1R0M
	2.2	20%	0.20	720	587-1610-1-ND	2.45	11.03	19.60	2,000	86.00/M	CBG2016T2R2M
	4.7	20%	0.37	530	587-1612-1-ND	2.45	11.03	19.60	2,000	86.00/M	CBG2016T4R7M
	10	20%	0.82	350	587-1606-1-ND	2.45	11.03	19.60	2,000	86.00/M	CBG2016T100M
	22	20%	1.8	240	587-1609-1-ND	2.45	11.03	19.60	2,000	86.00/M	CBG2016T220M
1210	1.0	20%	0.055	1440	587-1622-1-ND	3.50	15.75	28.00	1,000	123.00	CBG325T1R0MR
	2.2	20%	0.08	1130	587-1623-1-ND	3.50	15.75	28.00	1,000	123.00	CBG325T2R2MR
	4.7	20%	0.10	1010	587-1624-1-ND	3.50	15.75	28.00	1,000	123.00	CBG325T4R7MR
	10	20%	0.133	900	587-1625-1-ND	3.50	15.75	28.00	1,000	123.00	CBG325T100MR
	22	20%	0.27	620	587-1626-1-ND	3.50	15.75	28.00	1,000	123.00	CBG325T220MR

‡ For Tape and Reel part number, change 1-ND to 2-ND.

§ 587-1796-ND (TAIYO-CBCCOIL-V1) 5 each of values denoted (145 total pieces)..... \$67.50

BR Series

The best efficiency design is achieved by adopting bottom-surface electrode structure. Small and low-profile wound chip inductors are suited for module design which needs high electric current like DC/DC converters. **Applications:** • Small DC/DC converters in cell phones • HDD, DVC, DSC, PDA, LCD displays

Type	Dimensions - Inch (mm)			
	L	W	H - Maximum	e
BRCL1608	0.063±0.008 (1.6±0.2)	0.031±0.008 (0.8±0.2)	0.031±0.008 (0.8±0.2)	0.016±0.006 (0.4±0.15)
BRL2012	0.078±0.008 (2.0±0.2)	0.049±0.008 (1.25±0.2)	0.040 (1.0)	0.020±0.008 (0.5±0.2)
BRL2518	0.098±0.008 (2.5±0.2)	0.071±0.008 (1.8±0.2)	0.048 (1.2)	0.020±0.008 (0.5±0.2)

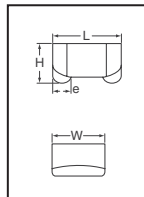

Inductance (µH)	Tolerance	DC Resistance (Ω)	Max. Rated Current (mA)	Digi-Key Part No.	Cut Tape Pricing			Tape & Reel [‡]		Taiyo Yuden Part No.
					10	50	100	Qty.	Pricing	
NEW! BRCL1608 Type NEW!										
0.2	20%	0.078	980	587-2056-1-ND	3.60	16.20	28.80	3,000	126.00/M	BRCL1608T20M
0.35	20%	0.104	810	587-2057-1-ND	3.60	16.20	28.80	3,000	126.00/M	BRCL1608T35M
0.45	20%	0.117	800	587-2058-1-ND	3.60	16.20	28.80	3,000	126.00/M	BRCL1608T45M
0.56	20%	0.1235	760	587-2059-1-ND	3.60	16.20	28.80	3,000	126.00/M	BRCL1608T56M
0.77	20%	0.143	660	587-2060-1-ND	3.60	16.20	28.80	3,000	126.00/M	BRCL1608T77M
1.0	20%	0.234	520	587-2061-1-ND	3.60	16.20	28.80	3,000	126.00/M	BRCL1608T1R0M
2.2	20%	0.715	280	587-2062-1-ND	3.60	16.20	28.80	3,000	126.00/M	BRCL1608T2R2M
NEW! BRL2012 Type NEW!										
1.0	20%	0.1755	850	587-2063-1-ND	3.15	14.18	25.20	3,000	110.00/M	BRL2012T1R0M
2.2	20%	0.39	550	587-2064-1-ND	3.15	14.18	25.20	3,000	110.00/M	BRL2012T2R2M

Inductance (µH)	Tolerance	DC Resistance (Ω)	Max. Rated Current (mA)	Digi-Key Part No.	Cut Tape Pricing			Tape & Reel [‡]		Taiyo Yuden Part No.
					10	50	100	Qty.	Pricing	
4.7	20%	0.715	400	587-2065-1-ND	3.15	14.18	25.20	3,000	110.00/M	BRL2012T4R7M
10	20%	1.105	330	587-2066-1-ND	3.15	14.18	25.20	3,000	110.00/M	BRL2012T100M
22	20%	1.69	270	587-2067-1-ND	3.15	14.18	25.20	3,000	110.00/M	BRL2012T220M
47	20%	4.55	160	587-2068-1-ND	3.15	14.18	25.20	3,000	110.00/M	BRL2012T470M
100	20%	10.01	85	587-2069-1-ND	3.15	14.18	25.20	3,000	110.00/M	BRL2012T101M

BRL2518 Type

1.0	20%	0.080	1000	587-1952-1-ND	3.55	15.98	28.40	3,000	124.00/M	BRL2518T1R0M
1.5	20%	0.100	920	587-1953-1-ND	3.55	15.98	28.40	3,000	124.00/M	BRL2518T1R5M
2.2	20%	0.135	850	587-1954-1-ND	3.55	15.98	28.40	3,000	124.00/M	BRL2518T2R2M
3.3	20%	0.300	580	587-1955-1-ND	3.55	15.98	28.40	3,000	124.00/M	BRL2518T3R3M
4.7	20%	0.400	470	587-1956-1-ND	3.55	15.98	28.40	3,000	124.00/M	BRL2518T4R7M

‡ For Tape and Reel part number, change the 1-ND to 2-ND.

LB Series

The LBMF Series wound chip inductor covers customers' wide range module design by wide-line-up shape, standard, low RDC, and high electric current series. The LBM2016 Series High Q and narrow tolerance are achieved by adopting bottom-surface electrode structure. Wound chip inductors are suited for module design of signal line uses. The LBC Series has super high Idc and low RDC characteristics. The LBR Series features super low RDC and high Idc characteristics.

Applications: • DSC/DVC/HDD • LCD • Portable telephones • Game equipment • Various audio visual equipment • Various communication equipment

Type	Dimensions - Inch (mm)			
	L	W	T	e
LBMF1608	0.063±0.008 (1.6±0.2)	0.031±0.008 (0.8±0.2)	0.031±0.008 (0.8±0.2)	0.016±0.006 (0.4±0.15)
LBM2016	0.08±0.008 (2.0±0.2)	0.063±0.008 (1.6±0.2)	0.063±0.008 (1.6±0.2)	0.02±0.004 (0.5±0.2)
LBC2518	0.098±0.008 (2.5±0.2)	0.071±0.008 (1.8±0.2)	0.071±0.008 (1.8±0.2)	0.020±0.008 (0.5±0.2)
LBR2012	0.079±0.008 (2.0±0.2)	0.049±0.008 (1.25±0.2)	0.049±0.008 (1.25±0.2)	0.020±0.008 (0.5±0.2)
LB3218	0.128±0.008 (3.2±0.2)	0.072±0.008 (1.8±0.2)	0.072±0.008 (1.8±0.2)	0.024±0.008 (0.6±0.2)

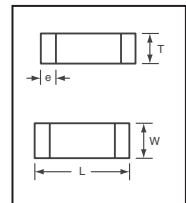

Inductance (µH)	Tolerance	DC Resistance (Ω)	Max. Rated Current (mA)	Digi-Key Part No.	Cut Tape Pricing			Tape & Reel [‡]		Taiyo Yuden Part No.
					10	50	100	Qty.	Pricing	
LBMF1608 Type										
1.0	20%	0.09	230	587-1711-1-ND	2.45	11.03	19.60	3,000	86.00/M	LBMF1608T1R0M
2.2	20%	0.17	160	587-1712-1-ND	2.45	11.03	19.60	3,000	86.00/M	LBMF1608T2R2M
4.7	20%	0.24	110	587-1713-1-ND	2.45	11.03	19.60	3,000	86.00/M	LBMF1608T4R7M
10	10%	0.36	80	587-1714-1-ND	2.45	11.03	19.60	3,000	86.00/M	LBMF1608T100K
22	10%	1.0	50	587-1715-1-ND	2.45	11.03	19.60	3,000	86.00/M	LBMF1608T220K
47	10%	2.5	35	587-1716-1-ND	2.45	11.03	19.60	3,000	86.00/M	LBMF1608T470K

Inductance (µH)	Tolerance	DC Resistance (Ω)	Max. Rated Current (mA)	Digi-Key Part No.	Cut Tape Pricing			Tape & Reel [‡]		Taiyo Yuden Part No.
					10	50	100	Qty.	Pricing	
LBM2016 Type										
0.15	5%	0.15	570	587-1800-1-ND	1.95	8.78	15.60	2,000	68.00/M	LBM2016T1R5J
0.22	5%	0.20	520	587-1801-1-ND	1.95	8.78	15.60	2,000	68.00/M	LBM2016T2R2J
0.33	5%	0.21	490	587-1802-1-ND	1.95	8.78	15.60	2,000	68.00/M	LBM2016T3R3J
0.47	5%	0.26	430	587-1803-1-ND	1.95	8.78	15.60	2,000	68.00/M	LBM2016T4R7J
0.68	5%	0.32	400	587-1804-1-ND	1.95	8.78	15.60	2,000	68.00/M	LBM2016T6R8J
1.0	5%	0.38	385	587-1805-1-ND	1.95	8.78	15.60	2,000	68.00/M	LBM2016T1R0J
1.5	5%	0.47	350	587-1806-1-ND	1.95	8.78	15.60	2,000	68.00/M	LBM2016T1R5J
2.2	5%	0.54	340	587-1807-1-ND	1.95	8.78	15.60	2,000	68.00/M	LBM2016T2R2J
3.3	5%	0.68	290	587-1808-1-ND	1.95	8.78	15.60	2,000	68.00/M	LBM2016T3R

TAIYO YUDEN

Wound Chip Power Inductors (Cont.)

NP Series

Features:

- Small surface area • Low profile • Designed for high current applications where a surface mount component is required

Applications:

- Power supply circuits/DC-DC converters in a variety of applications where compact size is vital, such as digital camcorders, HDD and notebook PC's

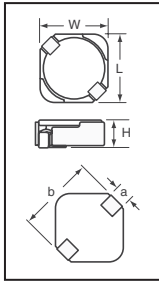

Type	Dimensions - Inch (mm)				
	L	W	H - Maximum	a	b
NP04SA	0.197±0.008 (5.0±0.2)	0.197±0.008 (5.0±0.2)	0.118 (3.0)	0.051±0.004 (1.3±0.1)	0.228±0.012 (5.8±0.3)
NP04SB/ NP04SZB	0.197±0.008 (5.0±0.2)	0.197±0.008 (5.0±0.2)	0.079 (2.0)	0.051±0.004 (1.3±0.1)	0.228±0.012 (5.8±0.3)

Inductance (µH)	Tolerance	DC Resistance (Ω)	Max. Rated Current (mA)	Digi-Key Part No.	Cut Tape Pricing			Tape & Reel†		Taiyo Yuden Part No.
					10	50	100	Qty.	Pricing	
NP04SA Type										
10	20%	0.054	0.90	587-1672-1-ND	5.50	24.75	44.00	2,000	193.00/M	NP04SA100M
22	20%	0.09	0.53	587-1673-1-ND	5.50	24.75	44.00	2,000	193.00/M	NP04SA220M
NP04SB Type										
4.7	30%	0.033	1.2	587-1674-1-ND	5.50	24.75	44.00	3,000	193.00/M	NP04SB4R7N
10	20%	0.054	0.90	587-1675-1-ND	5.50	24.75	44.00	3,000	193.00/M	NP04SB100M
22	20%	0.12	0.51	587-1676-1-ND	5.50	24.75	44.00	3,000	193.00/M	NP04SB220M
47	20%	0.27	0.38	587-1677-1-ND	4.50	20.25	36.00	3,000	158.00/M	NP04SB470M
NP04SZB Type										
1.0	30%	0.021	4.0	587-1678-1-ND	5.50	24.75	44.00	3,000	193.00/M	NP04SZB1R0N
2.2	30%	0.03	2.7	587-1679-1-ND	5.50	24.75	44.00	3,000	193.00/M	NP04SZB2R2N
4.7	30%	0.075	1.8	587-1680-1-ND	5.50	24.75	44.00	3,000	193.00/M	NP04SZB4R7N
10	20%	0.1	1.3	587-1681-1-ND	5.50	24.75	44.00	3,000	193.00/M	NP04SZB100M
22	20%	0.21	0.77	587-1682-1-ND	5.50	24.75	44.00	3,000	193.00/M	NP04SZB220M

† For Tape and Reel part number, change the 1-ND to 2-ND.

NR Series

- Features:** • Small and low profile • Corresponds to high current • Simple and original magnetic shield structure • Structure is strong against shock
Applications: • Small DC/DC converters in cell phones • HDD, DVC, DSC, PDA, LCD displays

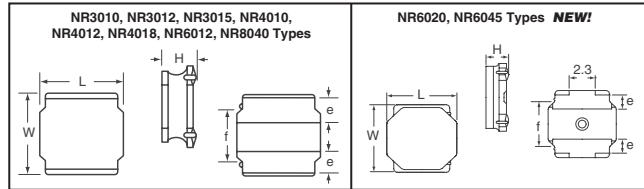

Type	Dimensions - Inch (mm)				
	L	W	H - Maximum	e	f
NR3010	0.118±0.004 (3.0±0.1)	0.118±0.004 (3.0±0.1)	0.039 (1.0)	0.035±0.008 (0.9±0.2)	0.075±0.008 (1.9±0.2)
NR3012	0.118±0.004 (3.0±0.1)	0.118±0.004 (3.0±0.1)	0.047 (1.2)	0.035±0.008 (0.9±0.2)	0.075±0.008 (1.9±0.2)
NR3015	0.118±0.004 (3.0±0.1)	0.118±0.004 (3.0±0.1)	0.059 (1.5)	0.035±0.008 (0.9±0.2)	0.075±0.008 (1.9±0.2)
NR4010	0.157±0.008 (4.0±0.2)	0.157±0.008 (4.0±0.2)	0.039 (1.0)	0.043±0.008 (1.1±0.2)	0.098±0.008 (2.5±0.2)
NR4012	0.157±0.008 (4.0±0.2)	0.157±0.008 (4.0±0.2)	0.047 (1.2)	0.043±0.008 (1.1±0.2)	0.098±0.008 (2.5±0.2)
NR4018	0.157±0.008 (4.0±0.2)	0.157±0.008 (4.0±0.2)	0.071 (1.8)	0.043±0.008 (1.1±0.2)	0.098±0.008 (2.5±0.2)
NR6012	0.236±0.008 (6.0±0.2)	0.236±0.008 (6.0±0.2)	0.047 (1.2)	0.039±0.008 (1.0±0.2)	0.189±0.008 (4.8±0.2)
NR6020	0.236±0.008 (6.0±0.2)	0.236±0.008 (6.0±0.2)	0.078 (2.0)	0.053±0.008 (1.35±0.2)	0.157±0.008 (4.0±0.2)
NR6045	0.236±0.008 (6.0±0.2)	0.236±0.008 (6.0±0.2)	0.177 (4.5)	0.053±0.008 (1.35±0.2)	0.157±0.008 (4.0±0.2)
NR8040	0.315±0.008 (8.0±0.2)	0.315±0.008 (8.0±0.2)	0.165 (4.2)† 0.157 (4.0)‡	0.063±0.012 (1.6±0.3)	0.220±0.012 (5.6±0.3)

† 0.9µH - 6.8µH ‡ 10µH - 100µH

Inductance (µH)	Tolerance	DC Resistance (Ω)	Max. Rated Current (mA)	Digi-Key Part No.	Cut Tape Pricing			Tape & Reel†		Taiyo Yuden Part No.
					10	50	100	Qty.	Pricing	
NR3010 Type										
1.0	30%	0.065	1300	587-1636-1-ND	6.80	30.60	54.40	2,000	238.00/M	NR3010T1R0N
2.2	20%	0.095	1100	587-1638-1-ND	6.80	30.60	54.40	2,000	238.00/M	NR3010T2R2M
4.7	20%	0.19	750	587-1640-1-ND	6.80	30.60	54.40	2,000	238.00/M	NR3010T4R7M
10	20%	0.45	500	587-1635-1-ND	6.80	30.60	54.40	2,000	238.00/M	NR3010T100M
22	20%	1.03	350	587-1637-1-ND	6.80	30.60	54.40	2,000	238.00/M	NR3010T220M
47	20%	2.05	220	587-1639-1-ND	6.80	30.60	54.40	2,000	238.00/M	NR3010T470M
NR3012 Type										
1.0	30%	0.05	1500	587-1641-1-ND	5.50	24.75	44.00	2,000	193.00/M	NR3012T1R0N
2.2	20%	0.08	1100	587-1642-1-ND	5.50	24.75	44.00	2,000	193.00/M	NR3012T2R2M
4.7	20%	0.13	770	587-1643-1-ND	5.50	24.75	44.00	2,000	193.00/M	NR3012T4R7M
10	20%	0.29	540	587-1644-1-ND	5.50	24.75	44.00	2,000	193.00/M	NR3012T100M
22	20%	0.63	375	587-1645-1-ND	5.50	24.75	44.00	2,000	193.00/M	NR3012T220M
47	20%	1.45	250	587-1646-1-ND	5.50	24.75	44.00	2,000	193.00/M	NR3012T470M

Digi-Reel® Most SMT cutdown parts are available on a Digi-Reel®. For Digi-Reel part number, change 1-ND to 6-ND or CT-ND to DKR-ND. See Digi-Key® Services on page 2 for additional information.

More Product Available Online: www.digikey.com

1466 (T083)

Toll-Free: 1-800-344-4539 • Phone 218-681-6674 • Fax: 218-681-3380

Inductance (µH)	Tolerance	DC Resistance (Ω)	Max. Rated Current (mA)	Digi-Key Part No.	Cut Tape Pricing			Tape & Reel†		Taiyo Yuden Part No.
					10	50	100	Qty.	Pricing	
NR3015 Type										
1.0	30%	0.03	2100	587-1647-1-ND	4.95	22.28	39.60	2,000	173.00/M	NR3015T1R0N
2.2	20%	0.06	1480	587-1648-1-ND	4.95	22.28	39.60	2,000	173.00/M	NR3015T2R2M
4.7	20%	0.12	1020	587-1649-1-ND	4.95	22.28	39.60	2,000	173.00/M	NR3015T4R7M
10	20%	0.23	700	587-1650-1-ND	4.95	22.28	39.60	2,000	173.00/M	NR3015T100M
22	20%	0.52	470	587-1651-1-ND	4.95	22.28	39.60	2,000	173.00/M	NR3015T220M
47	20%	1.34	320	587-1652-1-ND	4.95	22.28	39.60	2,000	173.00/M	NR3015T470M
NR4010 Type										
4.7	20%	0.21	900	587-1658-1-ND	6.20	27.90	49.60	5,000	217.00/M	NR4010T4R7M
10	20%	0.38	560	587-1653-1-ND	6.20	27.90	49.60	5,000	217.00/M	NR4010T100M
47	20%	1.81	240	587-1657-1-ND	6.20	27.90	49.60	5,000	217.00/M	NR4010T470M
NR4012 Type										
2.2	20%	0.09	1200	587-1661-1-ND	5.30	23.85	42.40	4,500	186.00/M	NR4012T2R2M
4.7	20%	0.14	960	587-1663-1-ND	5.30	23.85	42.40	4,500	186.00/M	NR4012T4R7M
10	20%	0.24	740	587-1659-1-ND	5.30	23.85	42.40	4,500	186.00/M	NR4012T100M
22	20%	0.48	510	587-1660-1-ND	5.30	23.85	42.40	4,500	186.00/M	NR4012T220M
47	20%	1.0	350	587-1662-1-ND	5.30	23.85	42.40	4,500	186.00/M	NR4012T470M
NR4018 Type										
1.0	30%	0.03	1830	587-1666-1-ND	4.45	20.03	35.60	3,500	156.00/M	NR4018T1R0N
2.2	20%	0.06	1440	587-1669-1-ND	4.45	20.03	35.60	3,500	156.00/M	NR4018T2R2M
4.7	20%	0.09	1200	587-1671-1-ND	4.45	20.03	35.60	3,500	156.00/M	NR4018T4R7M
10	20%	0.18	840	587-1664-1-ND	4.45	20.03	35.60	3,500	156.00/M	NR4018T100M
22	20%	0.36	590	587-1667-1-ND	4.45	20.03	35.60	3,500	156.00/M	NR4018T220M
47	20%	0.65	420	587-1670-1-ND	4.45	20.03	35.60	3,500	156.00/M	NR4018T470M
100	20%	1.5	270	587-1665-1-ND	4.45	20.03	35.60	3,500	156.00/M	NR4018T101M
220	20%	4.0	170	587-1668-1-ND	4.45	20.03	35.60	3,500	156.00/M	NR4018T212M
NR6012 Type										
2.5	30%	0.108	1730	587-2024-1-ND§	5.95	26.78	47.60	1,000	208.00	NR6012T2R5NE
3.0	20%	0.092	2000	587-1703-1-ND	5.95	26.78	47.60	1,000	208.00	NR6012T3R0M
4.0	30%	0.126	1570	587-2025-1-ND§	5.95	26.78	47.60	1,000	208.00	NR6012T4R0NE
4.0	20%	0.107	1800	587-1704-1-ND	5.95	26.78	47.60	—	—	NR6012T4R3M
5.3	20%	0.132	1400	587-2026-1-ND§	5.95	26.78	47.60	1,000	208.00	NR6012T5R3MNE
6.8	20%	0.198	1180	587-2027-1-ND§	5.95	26.78	47.60	1,000	208.00	NR6012T6R8MNE
10	20%	0.282	1000	587-2028-1-ND§	5.95	26.78	47.60	1,000	208.00	NR6012T100MNE
22	20%	0.636	630	587-2029-1-ND§	5.95	26.78	47.60	1,000	208.00	NR6012T220MNE
47	20%	1.26	460	587-2030-1-ND§	5.95	26.78	47.60	1,000	208.00	NR6012T470MNE
100	20%	2.616	320	587-2031-1-ND§	5.95	26.78	47.60	1,000	208.00	NR6012T101MNE
NEW! NR6020 Type NEW!										
0.8	30%	0.026	3800	587-2070-1-ND	5.25	23.63	42.00	2,500	184.00/M	NR6020T0R8N
2.2	30%	0.0442	2700	587-2071-1-ND	5.25	23.63	42.00	2,500	184.00/M	NR6020T2R2N
4.7	30%	0.0754	2000	587-2072-1-ND	5.25	23.63	42.00	2,500	184.00/M	NR6020T4R7N
10	20%	0.1625	1400	587-2073-1-ND	5.25	23.63	42.00	2,500	184.00/M	NR6020T100M
NEW! NR6045 Type NEW!										
1.0	30%	0.0182	4200	587-2074-1-ND	4.75	21.38	38.00	1,500	166.00/M	NR6045T1R0N
1.3	30%	0.0208	4000	587-2075-1-ND	4.75	21.38	38.00	1,500	166.00/M	NR6045T1R3N
1.8	30%	0.0234	3700	587-2076-1-ND	4.75	21.38	38.00	1,500	166.00/M	NR6045T1R8N
2.3	30%									