

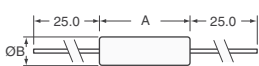

RWM Series – Enamelled Wirewound Power Resistors

3 and 7 Watt



Series	Dimensions (mm) ±1	
	A	øB
RWM0410	12	5.5
RWM0622	18	6.5

Features:

- High dissipation • High reliability level: Fire proof, excellent endurance, conformal vitreous enamel, great mechanical strength, good environmental protection, and all welded construction • Low ohmic values. The performance of this series of professional resistors fully meets the requirements of the following specifications: NF C 83-210-001, CECC 40201-001 and BS-CECC 40201-002

Characteristics	
Temperature Coefficient	75ppm/°C Typical
Maximum Dissipation @ 70°C	RWM0410: 2.6W; RWM0622: 6W
Limiting Element Voltage	RWM0410: 120V; RWM0622: 350V
Resistance Tolerance	±5%

RWM04 Series Resistance Value Chart									
.10	.33	1.5	3.9	15	47	120	330	820	3.3K
.12	.39	1.8	4.7	22	56	150	390	1.0K	3.9K
.15	.47	2.2	6.8	27	68	180	470	1.2K	4.7K
.22	1.0	2.7	8.2	33	82	220	560	1.5K	10K
.27	1.2	3.3	10	39	100	270	680	2.2K	

RWM06 Series Resistance Value Chart									
.10	1.0	6.8	33	120	470	2.2K	6.8K		
.15	1.8	10	47	150	560	2.7K	10K		
.22	2.2	15	56	220	680	3.3K	15K		
.33	3.3	22	68	330	1.0K	4.7K	18K		
.47	4.7	27	100	390	1.5K	5.6K			

Description	Power Rating (W) @ 25°C	Value Range (Ω)	Digi-Key Part No.†	Cut Tape Pricing			Digi-Key Part No.†	Tape and Reel Pricing		Vishay Part No.
				1	10	50		1,000	1,000	
RWM0410	3	.10 - .47	RWMA-(Value)CT-ND	.84	7.57	31.11	RWMA-(Value)TR-ND	227.43	RWM0410xxxxJR15E1	
	3	1.0 - 2.7K	RWMA-(Value)CT-ND	1.07	7.60	28.67	RWMA-(Value)TR-ND	197.00	RWM0410xxxxJR15E1	
	3	3.3K - 4.7K	RWMA-(Value)CT-ND	.82	7.53	32.40	RWMA-(Value)TR-ND	277.88	RWM0410xxxxJR15E1	
	3	10K	RWMA-10KCT-ND	1.03	9.51	RWMA-10KTR-ND	351.55	RWM0410xxxxJR15E1		
RWM0622	7	.10 - .47, 15K, 18K	RWMB-(Value)CT-ND	1.09	10.06	43.32	RWMB-(Value)TB-ND‡	371.71	RWM0622xxxxJA15E1	
	7	1.0 - 10K	RWMB-(Value)CT-ND	.97	8.69	35.71	RWMB-(Value)TB-ND‡	260.54	RWM0622xxxxJA15E1	

† For complete part number, substitute value from Resistance Value Chart for (Value). ‡ Tape and Box

Heat Sink Mountable Thick Film Power Resistors



RTO 20F Series Resistance Value Chart				RTO 50F Series Resistance Value Chart			
.010	.47	47	4.7K	.050	.50	10	
.015	1.0	100	10K	.068	1.0	100	
.046	2.2	220	100K	.10	2.0	1.0K	
.068	4.7	470	1.0M	.20	5.0	10K	
.10	10	1.0K					
.20	22	2.2K					

LTO 30F Series Resistance Value Chart				LTO 50F Series Resistance Value Chart			
.010	.068	4.7	47	.010	.10	5.0	1.0K
.015	.10	5.0	100	.022	.47	10	10K
.022	.47	10	1.0K	.047	1.0	22	
.047	1.0	15	10K	.050	2.2	47	
.050	2.2	22		.068	4.7	100	

LTO 100F Series Resistance Value Chart				D2TO 35C Series Resistance Value Chart				
.015	.10	15		.010	.050	1.00	10.0	100
.022	1.0	100		.015	.068	2.20	15.0	1.00K
.047	4.7	1.0K		.022	.100	4.70	22.0	
.050	10	10K		.047	.470	5.00	47.0	

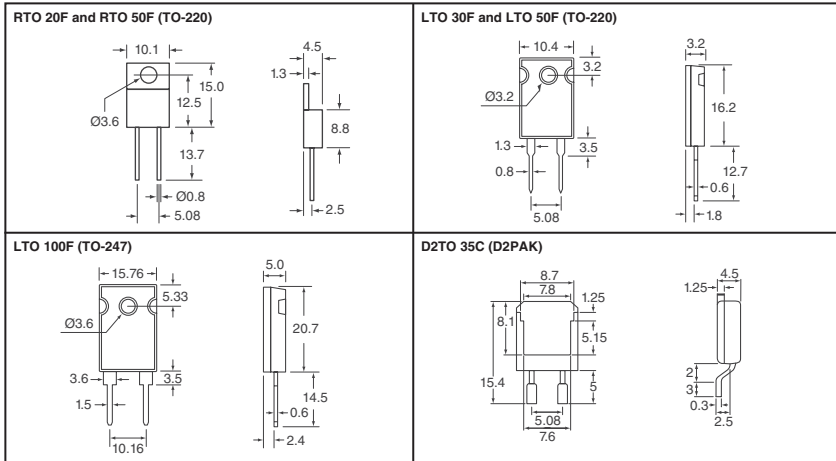

Electrical Specifications				
Series	Resistance Tolerance	Limiting Element Volt.	Dielectric Strength MIL STD 202	Insulation Resistance
RTO 20 RTO 50	±5%	250V 300V	2000VRMS, 1 minute, 10mA max. (Between terminal and heat sink)	≥10 ⁶ MΩ
LTO 30 LTO 50 LTO 100	±5%	250V 250V 375V	1500VRMS, 1 minute, 10mA max. (Between terminal and heat sink)	≥10 ⁴ MΩ
D2TO 35C	±1%	250V	2000VRMS, 1 minute, 10mA max. (Between terminals and board)	≥10 ⁶ MΩ

Description	Nominal Power Rating (W) @ 25°C‡	Value Range (Ω)	Digi-Key Part No.†	Pricing			Vishay Part No.
				1	10	50	
RTO 20F	20	.010 - .046	RT20J-(Value)-ND	6.45	60.54	248.89	RT020FxxxxxJTE3
	20	.068 - .10	RT20J-(Value)-ND	5.38	50.47	207.48	RT020FxxxxxJTE3
	20	20 - 1.0M	RT20J-(Value)-ND	4.86	43.92	186.91	RT020FxxxxxJTE3
RTO 50F	50	.050 - .068	RT50J-(Value)-ND	6.93	64.94	266.96	RT050FxxxxxJTE1
	50	.10 - 5.0	RT50J-(Value)-ND	6.29	59.04	242.74	RT050FxxxxxJTE1
	50	10 - 10K	RT50J-(Value)-ND	5.25	49.19	202.23	RT050FxxxxxJTE1
LTO 30F	30	.010 - .022	LT30J-(Value)-ND	4.96	46.56	191.41	LTO30FxxxxxJTE3
	30	.047 - .10	LT30J-(Value)-ND	4.48	40.54	172.49	LTO30FxxxxxJTE3
	30	.47 - 10K	LT30J-(Value)-ND	3.73	33.76	143.66	LTO30FxxxxxJTE3
LTO 50F	50	.010 - .022	LT50J-(Value)-ND	6.05	56.74	233.26	LTO50FxxxxxJTE3
	50	.047 - .10	LT50J-(Value)-ND	5.05	47.30	194.44	LTO50FxxxxxJTE3
	50	.47 - 10K	LT50J-(Value)-ND	4.56	41.15	175.13	LTO50FxxxxxJTE3
LTO 100F	100	.015 - .022	LT100J-(Value)-ND	9.71	88.28	342.09	LTO100FxxxxxJTE3
	100	.047 - .10	LT100J-(Value)-ND	8.47	79.46	326.67	LTO100FxxxxxJTE3
	100	.050	LT100J-(Value)-ND	9.32	87.39	359.26	LTO100FxxxxxJTE3
D2TO 35C	35	1.0 - 10K	LT100J-(Value)-ND	7.06	66.20	272.15	LTO100FxxxxxJTE3
	35	.010 - .022	D2TO-(Value)A-ND	11.96	108.67	421.09	D2TO35CxxxxxFTe3
	35	.047, .068 - .100	D2TO-(Value)A-ND	9.96	90.59	351.02	D2TO35CxxxxxFTe3
	35	.050	D2TO-.050A-ND	10.96	99.64	386.09	D2TO35CxxxxxFTe3
	35	.470 - 4.70, 10.0 - 1.00K	D2TO-(Value)A-ND	9.06	84.88	348.96	D2TO35CxxxxxFTe3
	35	5.00	D2TO-5.00A-ND	9.13	82.98	321.55	D2TO35CxxxxxFTe3

† For complete part number, substitute value from Resistance Value Chart for (Value). ‡ Heat sink mounted

LPS Series Power Resistors for Heat Sink Mounting

Features: • Full rated power @ 85°C • Non-Inductive • Easy mounting • Low thermal radiation of the case
Specifications: • Limiting Element Voltage: 5kV • Insulation Resistance: ≥10⁴MΩ • Inductance: ≤0.1μH



300W Resistance Value Chart			600W Resistance Value Chart			800W Resistance Value Chart		
1.0	10.0	100	1.0	10	100	1.0	10	100
4.7	47.0	470	4.7	47	470	4.7	47	470

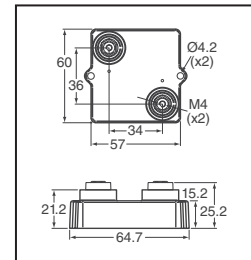

Power Rating (W) @ 85°C	Value Range (Ω)	Digi-Key Part No.†	Pricing			Vishay Part No.
			1	10	50	
300	1.0 - 470	LPS-(Value)A-ND	40.05	354.72	1544.76	LPS0300HxxxxJB
600	1.0 - 470	LPS-(Value)B-ND	59.33	525.50	2288.49	LPS0600HxxxxJB
800	1.0 - 470	LPS-(Value)C-ND	87.18	817.32	3541.72	LPS0800HxxxxJB

† For complete part number, substitute value from Resistance Value Chart for (Value).

2022 (EU2011-EN) **Free shipping on orders over €65!** All prices in euro and include duties.