

CMOS/TTL 振荡器 (接上页)

系列	频率 (MHz)	Digi-Key 零件编号	单价			Epson 零件编号
			1	10	50	
半尺寸 - 符合 RoHS 规范要求						
带输出启用的 SG-531P CMOS/TTL	1.544000	SER1216-ND	3.43	2.94	2.26	SG-531P 1.5440MC:ROHS
	1.843200	SER1201-ND	3.43	2.94	2.26	SG-531P 1.8432MC:ROHS
	2.457600	SER1202-ND	3.43	2.94	2.26	SG-531P 2.4576MC:ROHS
	3.276800	SER1221-ND	3.43	2.94	2.26	SG-531P 3.2768MC:ROHS
	3.579545	SER1222-ND	3.43	2.94	2.26	SG-531P 3.579545MC:ROHS
	3.686400	SER1223-ND	3.43	2.94	2.26	SG-531P 3.6864MC:ROHS
	4.000000	SER1203-ND	3.43	2.94	2.26	SG-531P 4.0000MC:ROHS
	4.096000	SER1224-ND	3.43	2.94	2.26	SG-531P 4.0960MC:ROHS
	4.915200	SER1204-ND	3.43	2.94	2.26	SG-531P 4.9152MC:ROHS
	7.372800	SER1227-ND	3.43	2.94	2.26	SG-531P 7.3728MC:ROHS
	8.000000	SER1207-ND	3.43	2.94	2.26	SG-531P 8.0000MC:ROHS
	8.192000	SER1228-ND	3.43	2.94	2.26	SG-531P 8.1920MC:ROHS
	10.000000	SER1208-ND	3.43	2.94	2.26	SG-531P 10.0000MC:ROHS
	11.059200	SER1232-ND	3.43	2.94	2.26	SG-531P 11.0592MC:ROHS
	12.288000	SER1233-ND	3.43	2.94	2.26	SG-531P 12.2880MC:ROHS
	14.745600	SER1234-ND	3.43	2.94	2.26	SG-531P 14.7456MC:ROHS
	18.432000	SER1238-ND	3.43	2.94	2.26	SG-531P 18.4320MC:ROHS
	19.660800	SER1240-ND	3.43	2.94	2.26	SG-531P 19.6608MC:ROHS
	22.118400	SER1242-ND	3.43	2.94	2.26	SG-531P 22.1184MC:ROHS
	24.000000	SER1213-ND	3.43	2.94	2.26	SG-531P 24.0000MC:ROHS
带输出启用的 SG-531PH CMOS	32.000000	SER1111-ND	3.43	2.94	2.26	SG-531PH 32.0000MC:ROHS
	33.000000	SER1114-ND	3.43	2.94	2.26	SG-531PH 33.0000MC:ROHS
	48.000000	SER1122-ND	3.43	2.94	2.26	SG-531PH 48.0000MC:ROHS
	66.000000	SER1128-ND	3.61	3.09	2.37	SG-531PH 66.0000MC:ROHS
带输出启用的 SG-531PTJ TTL	27.000000	SER1817-ND	3.43	2.94	2.26	SG-531PTJ 27.0000MC:ROHS
	28.636360	SER1820-ND	3.43	2.94	2.26	SG-531PTJ 28.63636MC:ROHS
	29.491000	SER1821-ND	3.43	2.94	2.26	SG-531PTJ 29.4910MC:ROHS
	33.000000	SER1826-ND	3.43	2.94	2.26	SG-531PTJ 33.0000MC:ROHS
全尺寸 - 符合 RoHS 规范要求						
带输出启用的 SG-51P CMOS/TTL	1.843200	SER1701-ND	3.43	2.94	2.26	SG-51P 1.8432MC:ROHS
	2.000000	SER1717-ND	3.43	2.94	2.26	SG-51P 2.0000MC:ROHS
	4.000000	SER1703-ND	3.43	2.94	2.26	SG-51P 4.0000MC:ROHS
	6.000000	SER1706-ND	3.43	2.94	2.26	SG-51P 6.0000MC:ROHS
	7.372800	SER1727-ND	3.43	2.94	2.26	SG-51P 7.3728MC:ROHS
	8.000000	SER1707-ND	3.43	2.94	2.26	SG-51P 8.0000MC:ROHS
	10.000000	SER1708-ND	3.43	2.94	2.26	SG-51P 10.0000MC:ROHS
	12.000000	SER1709-ND	3.43	2.94	2.26	SG-51P 12.0000MC:ROHS
	12.288000	SER1733-ND	3.43	2.94	2.26	SG-51P 12.2880MC:ROHS
	14.745600	SER1734-ND	3.43	2.94	2.26	SG-51P 14.7456MC:ROHS
	16.000000	SER1711-ND	3.43	2.94	2.26	SG-51P 16.0000MC:ROHS
	18.432000	SER1738-ND	3.43	2.94	2.26	SG-51P 18.4320MC:ROHS
	20.000000	SER1712-ND	3.43	2.94	2.26	SG-51P 20.0000MC:ROHS
	24.576000	SER1743-ND	3.43	2.94	2.26	SG-51P 24.5760MC:ROHS
带输出启用的 SG-51PTJ TTL	32.000000	SER1811-ND	3.43	2.94	2.26	SG-51PTJ 32.0000MC:ROHS

A462-ND Aries Electronics Inc. 全尺寸 4 引脚振荡器插口 ..... 58/1 12.08/25 39.12/100  
 A463-ND Aries Electronics Inc. 半尺寸 4 引脚振荡器插口 ..... 58/1 12.08/25 39.12/100

石英晶体 - C型、圆柱形

技术规格:  
 • 标称频率: 32.768 kHz • 工作温度: -10°C ~ 60°C • 驱动电平: 最大 1.0μW • 频率公差 (标准): ±20ppm  
 • 串联电阻: C-001R=最大 35kΩ (标准 18kΩ); C-002RX 和 C-004R=最大 50kΩ (标准 30kΩ); C-005R=最大 50kΩ (标准 37kΩ)

型号	最大 L1	最小 L2	最大 D1	D2	B
C-001R	8.0	9.0	ø3.1	ø0.3	1.1
C-002RX	6.0	4.0	ø2.0	ø0.2	0.7
C-004R	5.0	4.0	ø1.5	ø0.18	0.5
C-005R	4.6	4.0	ø1.2	ø0.15	0.3

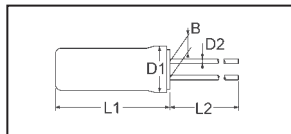

负载电容 (pF)	Digi-Key 零件编号	单价			Epson 零件编号
		1	10	50	
12.5	SE3201-ND	.27	.23	.16	C-001R 32.7680K-A
12.5	SE3203-ND	1.38	1.15	.82	C-004R 32.7680K-A
9	SE3204-ND	5.64	4.70	3.33	C-005R 32.7680K-AC
符合 RoHS 规范要求					
12.5	SER3201-ND	.32	.27	.21	C-001R 32.7680K-A:PBFFREE
12.5	SER3202-ND	.32	.27	.21	C-002RX 32.7680K-A:PBFFREE
6	SER3205-ND	.32	.27	.21	C-002RX 32.7680K-E:PBFFREE
12.5	SER3203-ND	1.61	1.38	1.06	C-004R 32.7680K-A:PBFFREE
9	SER3204-ND	6.58	5.64	4.33	C-005R 32.7680K-AC:PBFFREE

石英晶体 - C-2 型、圆柱形

技术规格:  
 • 工作温度: -10°C ~ 60°C  
 • 驱动电平: 最大 1.0μW  
 • 晶体负载电容/公差: 全部零件均具有 11pF 负载电容, ±100ppm. 例外: C-2 32.560KH-AG, 7pF, ±190 ppm; C-2 38.000KA-P 12.5pF, ±20ppm  
 • 超过 20KHz、低于 99KHz 的串联电阻: 35kΩ ~ 15kΩ  
 • 超过 100KHz、低于 200KHz 的串联电阻: 12kΩ ~ 8kΩ

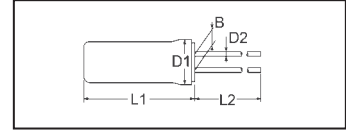

型号	最大 L1	最小 L2	最大 D1	D2	B
C-2 型	6.0	4.0	ø2.0	ø0.2	0.7

频率 (kHz)	Digi-Key 零件编号	单价			Epson 零件编号
		1	10	50	
20.0000	SE3301-ND	1.23	1.03	.73	C-2 20.0000K-P
25.6000	SE3302-ND	1.23	1.03	.73	C-2 25.6000K-P
26.6670	SE3303-ND	1.23	1.03	.73	C-2 26.6670K-P
30.0000	SE3305-ND	1.23	1.03	.73	C-2 30.0000K-P
31.2500	SE3308-ND	1.23	1.03	.73	C-2 31.2500K-P
31.5000	SE3309-ND	1.23	1.03	.73	C-2 31.5000K-P
32.0000	SE3310-ND	1.23	1.03	.73	C-2 32.0000K-P
32.5600	SE3311-ND	1.23	1.03	.73	C-2 32.5600KH-AG
32.9190	SE3312-ND	1.23	1.03	.73	C-2 32.9190KC-P
36.0000	SE3313-ND	1.23	1.03	.73	C-2 36.0000K-P
38.0000	SE3314-ND	1.35	1.13	.73	C-2 38.0000KA-P
38.4000	SE3315-ND	1.23	1.03	.73	C-2 38.4000K-P
40.0000	SE3316-ND	1.23	1.03	.73	C-2 40.0000K-P
46.6084	SE3317-ND	1.23	1.03	.73	C-2 46.6084KC-P
50.0000	SE3318-ND	1.23	1.03	.73	C-2 50.0000K-P
60.0000	SE3320-ND	1.23	1.03	.73	C-2 60.0000K-P
60.0020	SE3321-ND	1.23	1.03	.73	C-2 60.0020KC-P
65.5350	SE3322-ND	1.23	1.03	.73	C-2 65.5350K-P
75.0000	SE3323-ND	1.23	1.03	.73	C-2 75.0000K-P
76.8000	SE3324-ND	1.23	1.03	.73	C-2 76.8000K-P
83.0000	SE3330-ND	1.47	1.23	.87	C-2 83.0000K-P
96.0000	SE3331-ND	1.47	1.23	.87	C-2 96.0000K-P
100.0000	SE3333-ND	1.47	1.23	.87	C-2 100.0000K-P
111.0000	SE3334-ND	1.47	1.23	.87	C-2 111.0000K-P
120.8475	SE3336-ND	1.47	1.23	.87	C-2 120.8475K-P
131.0720	SE3337-ND	1.77	1.48	1.04	C-2 131.0720K-P
149.4750	SE3338-ND	1.77	1.48	1.04	C-2 149.4750K-P
符合 RoHS 规范要求					
20.0000	SER3301-ND	1.44	1.23	.95	C-2 20.0000K-P:PBFFREE
25.6000	SER3302-ND	1.44	1.23	.95	C-2 25.6000K-P:PBFFREE
26.6670	SER3303-ND	1.44	1.23	.95	C-2 26.6670K-P:PBFFREE
28.0000	SER3304-ND	1.44	1.23	.95	C-2 28.0000K-P:PBFFREE
30.0000	SER3305-ND	1.44	1.23	.95	C-2 30.0000K-P:PBFFREE
31.2500	SER3308-ND	1.44	1.23	.95	C-2 31.2500K-P:PBFFREE
32.0000	SER3310-ND	1.44	1.23	.95	C-2 32.0000K-P:PBFFREE
36.0000	SER3313-ND	1.44	1.23	.95	C-2 36.0000K-P:PBFFREE
38.0000	SER3314-ND	1.58	1.35	1.04	C-2 38.0000KA-P:PBFFREE
38.4000	SER3315-ND	1.44	1.23	.95	C-2 38.4000K-P:PBFFREE
40.0000	SER3316-ND	1.44	1.23	.95	C-2 40.0000K-P:PBFFREE
60.0000	SER3320-ND	1.44	1.23	.95	C-2 60.0000K-P:PBFFREE
65.5350	SER3322-ND	1.44	1.23	.95	C-2 65.5350K-P:PBFFREE
75.0000	SER3323-ND	1.44	1.23	.95	C-2 75.0000K-P:PBFFREE
76.8000	SER3324-ND	1.44	1.23	.95	C-2 76.8000K-P:PBFFREE
83.0000	SER3330-ND	1.72	1.47	1.13	C-2 83.0000K-P:PBFFREE
96.0000	SER3331-ND	1.72	1.47	1.13	C-2 96.0000K-P:PBFFREE
100.0000	SER3333-ND	1.72	1.47	1.13	C-2 100.0000K-P:PBFFREE
120.0000	SER3335-ND	1.72	1.47	1.13	C-2 120.0000K-P:PBFFREE
131.0720	SER3337-ND	2.07	1.77	1.36	C-2 131.0720K-P:PBFFREE
149.4750	SER3338-ND	2.07	1.77	1.36	C-2 149.4750K-P:PBFFREE

石英晶体 - CA-301 型、圆柱形

技术规格:  
 • 工作温度: -20°C ~ 70°C • 驱动电平: 最大 2mW • 推荐电平: 标准 10μW ~ 100μW • 频率公差 (标准): ±30ppm • 负载电容: 18pF

频率 MHz	串联电阻		模式
	大于	小于	
4.0	5.5	最大 150Ω	基频
5.5	6.0	最大 100Ω	
6.0	10.0	最大 80Ω	
10.0	12.0	最大 60Ω	
12.0	16.0	最大 50Ω	
16.0	30.0	最大 40Ω	
30.0	36.0	最大 100Ω	三次泛音
36.0	64.0	最大 80Ω	

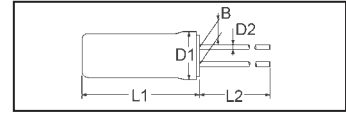

型号	最大 L1	最小 L2	最大 D1	D2	B
小于 5.5MHz	9.3	9.5	ø3.1	ø0.3	1.1
大于 5.5MHz	8.9	9.5	ø3.1	ø0.3	1.1

频率 (MHz)	Digi-Key 零件编号	单价			Epson 零件编号
		1	10	50	
4.000000	SE3404-ND	2.13	1.78	1.26	CA-301 4.0000M-C
4.194304	SE3405-ND	2.13	1.78	1.26	CA-301 4.194304M-C
4.433619	SE3406-ND	2.13	1.78	1.26	CA-301 4.433619M-C
5.500000	SE3408-ND	.96	.80	.56	CA-301 5.5000M-C
6.000000	SE3409-ND	.96	.80	.56	CA-301 6.000M-C

(转下页)

全部产品均以美元计价。 免费电话: 10800-1527031 (China Telecom - 中国电讯) — 10800-8527031 (CNCG - 中国网通)

digikey.com.cn — 电话: (852) 3104 0500 — 传真: (852) 3104 0686

(CN082-09) 1503

频率 (MHz)	Digi-Key 零件编号	单价		Epson 零件编号
		1	50	
6.144000	SE3410-ND	.96	.56	CA-301 6.1440M-C
6.757000	SE3411-ND	.96	.56	CA-301 6.7570M-C
7.200000	SE3412-ND	.96	.56	CA-301 7.200M-C
7.372800	SE3413-ND	.96	.56	CA-301 7.372M-C
8.000000	SE3414-ND	.96	.56	CA-301 8.000M-C
8.388608	SE3415-ND	.96	.56	CA-301 8.388M-C
8.432000	SE3416-ND	.96	.56	CA-301 8.432M-C
9.600000	SE3418-ND	.96	.56	CA-301 9.600M-C
9.830400	SE3419-ND	.96	.56	CA-301 9.830M-C
10.000000	SE3420-ND	.96	.56	CA-301 10.000M-C
10.240000	SE3421-ND	.96	.56	CA-301 10.240M-C
10.624400	SE3422-ND	.96	.56	CA-301 10.6244M-C
11.059200	SE3423-ND	.96	.56	CA-301 11.0592M-C
12.000000	SE3424-ND	.96	.56	CA-301 12.000M-C
12.096000	SE3425-ND	.96	.56	CA-301 12.096M-C
12.288000	SE3426-ND	.96	.56	CA-301 12.288M-C
13.500000	SE3427-ND	.96	.56	CA-301 13.500M-C
14.000000	SE3428-ND	.96	.56	CA-301 14.000M-C
14.500000	SE3430-ND	.96	.56	CA-301 14.500M-C
14.745600	SE3431-ND	.96	.56	CA-301 14.7456M-C
15.000000	SE3432-ND	.96	.56	CA-301 15.000M-C
16.000000	SE3433-ND	.96	.56	CA-301 16.000M-C
18.000000	SE3435-ND	.96	.56	CA-301 18.000M-C
18.432000	SE3436-ND	.96	.56	CA-301 18.432M-C
19.660800	SE3437-ND	.96	.56	CA-301 19.6608M-C
20.000000	SE3438-ND	.96	.56	CA-301 20.000M-C
22.118400	SE3439-ND	.96	.56	CA-301 22.1184M-C
24.000000	SE3440-ND	.96	.56	CA-301 24.000M-C
25.000000	SE3441-ND	.96	.56	CA-301 25.000M-C
25.175000	SE3442-ND	.96	.56	CA-301 25.175M-C
27.000000	SE3443-ND	.96	.56	CA-301 27.000M-C;(FUND)
28.000000	SE3444-ND	.96	.56	CA-301 28.000M-C;(FUND)
28.322000	SE3445-ND	.96	.56	CA-301 28.322M-C;(FUND)
32.000000	SE3446-ND	.96	.56	CA-301 32.000M-C
32.768000	SE3447-ND	.96	.56	CA-301 32.768M-C
33.000000	SE3448-ND	.96	.56	CA-301 33.000M-C
33.333000	SE3449-ND	.96	.56	CA-301 33.333M-C
36.000000	SE3450-ND	.96	.56	CA-301 36.000M-C
40.000000	SE3451-ND	.96	.56	CA-301 40.000M-C
46.000000	SE3453-ND	.96	.56	CA-301 46.000M-C

频率 (MHz)	Digi-Key 零件编号	单价		Epson 零件编号
		1	50	
49.860000	SE3454-ND	.96	.56	CA-301 49.8600M-C
50.000000	SE3455-ND	.96	.56	CA-301 50.000M-C
55.000000	SE3456-ND	.96	.56	CA-301 55.000M-C
60.000000	SE3457-ND	1.11	.64	CA-301 60.000M-C
符合 RoHS 规范要求				
4.000000	SER3404-ND	2.49	1.64	CA-301 4.000M-C:PBFFREE
4.194304	SER3405-ND	2.49	1.64	CA-301 4.194304M-C:PBFFREE
4.915200	SER3407-ND	2.49	1.64	CA-301 4.9152M-C:PBFFREE
5.500000	SER3408-ND	1.12	.74	CA-301 5.500M-C:PBFFREE
6.000000	SER3409-ND	1.12	.74	CA-301 6.000M-C:PBFFREE
6.144000	SER3410-ND	1.12	.74	CA-301 6.1440M-C:PBFFREE
7.200000	SER3412-ND	1.12	.74	CA-301 7.200M-C:PBFFREE
7.372800	SER3413-ND	1.12	.74	CA-301 7.372M-C:PBFFREE
8.000000	SER3414-ND	1.12	.74	CA-301 8.000M-C:PBFFREE
8.388608	SER3415-ND	1.12	.74	CA-301 8.388M-C:PBFFREE
8.432000	SER3416-ND	1.12	.74	CA-301 8.432M-C:PBFFREE
9.600000	SER3418-ND	1.12	.74	CA-301 9.600M-C:PBFFREE
9.830000	SER3419-ND	1.12	.74	CA-301 9.830M-C:PBFFREE
10.000000	SER3420-ND	1.12	.74	CA-301 10.000M-C:PBFFREE
10.240000	SER3421-ND	1.12	.74	CA-301 10.240M-C:PBFFREE
11.059200	SER3423-ND	1.12	.74	CA-301 11.0592M-C:PBFFREE
12.000000	SER3424-ND	1.12	.74	CA-301 12.000M-C:PBFFREE
12.288000	SER3426-ND	1.12	.74	CA-301 12.288M-C:PBFFREE
14.318180	SER3429-ND	1.12	.74	CA-301 14.31818M-C:PBFFREE
14.745600	SER3431-ND	1.12	.74	CA-301 14.7456M-C:PBFFREE
16.000000	SER3433-ND	1.12	.74	CA-301 16.000M-C:PBFFREE
18.000000	SER3435-ND	1.12	.74	CA-301 18.000M-C:PBFFREE
18.432000	SER3436-ND	1.12	.74	CA-301 18.432M-C:PBFFREE
19.660800	SER3437-ND	1.12	.74	CA-301 19.6608M-C:PBFFREE
20.000000	SER3438-ND	1.12	.74	CA-301 20.000M-C:PBFFREE
22.118400	SER3439-ND	1.12	.74	CA-301 22.1184M-C:PBFFREE
24.000000	SER3440-ND	1.12	.74	CA-301 24.000M-C:PBFFREE
25.000000	SER3441-ND	1.12	.74	CA-301 25.000M-C:PBFFREE
27.000000	SER3443-ND	1.12	.74	CA-301 27.000M-C:(FUND):PBFFREE
33.000000	SER3448-ND	1.12	.74	CA-301 33.000M-C:PBFFREE
40.000000	SER3451-ND	1.12	.74	CA-301 40.000M-C:PBFFREE

D

MA-306 系列晶体

技术规格:

- 存储温度: -55°C ~ 100°C, 拆封后无包装存储 • 工作温度: -20°C ~ 70°C
- 最大驱动电平: 2mW • 推荐驱动电平: 10μW ~ 100μW • 频率公差 (标准): ±50ppm • 频率温度特性 (标准): ±30ppm, -20°C ~ 70°C, DL=100μW • 负载电容: 18pF • 串联电阻: 最大 60Ω, -20°C ~ 70°C, DL=100μW • 并联电容: 最大 5pF • 老化: 最大 ±5ppm/年

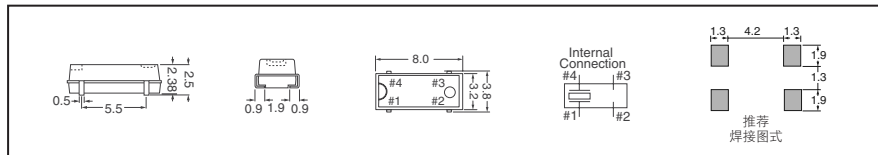

频率 (MHz)	Digi-Key 零件编号	剪切带 单价		Digi-Key 零件编号	带卷 价格 1,000	Epson 零件编号
		1	50			
18.00000	SE2701CT-ND	2.14	1.83	SE2701TR-ND	1020.00	MA-306 18.000M-C0
18.43200	SE2702CT-ND	2.14	1.83	SE2702TR-ND	1020.00	MA-306 18.4320M-C0
19.66080	SE2704CT-ND	2.14	1.83	SE2704TR-ND	1020.00	MA-306 19.6608M-C0
22.11840	SE2707CT-ND	2.14	1.83	SE2707TR-ND	1020.00	MA-306 22.1184M-C0
24.00000	SE2708CT-ND	2.14	1.83	SE2708TR-ND	1020.00	MA-306 24.000M-C0
24.57600	SE2709CT-ND	2.14	1.83	SE2709TR-ND	1020.00	MA-306 24.5760M-C0
25.00000	SE2710CT-ND	2.14	1.83	SE2710TR-ND	1020.00	MA-306 25.000M-C0
25.17500	SE2711CT-ND	2.14	1.83	SE2711TR-ND	1020.00	MA-306 25.1750M-C0
27.00000	SE2712CT-ND	2.14	1.83	SE2712TR-ND	1020.00	MA-306 27.000M-C0
28.00000	SE2713CT-ND	2.14	1.83	SE2713TR-ND	1020.00	MA-306 28.000M-C0
28.63636	SE2715CT-ND	2.14	1.83	SE2715TR-ND	1020.00	MA-306 28.63636M-C0
29.49120	SE2716CT-ND	2.14	1.83	SE2716TR-ND	1020.00	MA-306 29.4912M-C0
32.00000	SE2718CT-ND	2.14	1.83	SE2718TR-ND	1020.00	MA-306 32.000M-C0
40.00000	SE2725CT-ND	2.14	1.83	SE2725TR-ND	1020.00	MA-306 40.000M-C0
符合 RoHS 规范要求						
18.00000	SER2701CT-ND	2.14	1.83	SER2701TR-ND	885.00	MA-306 18.000M-C0:ROHS
18.43200	SER2702CT-ND	2.14	1.83	SER2702TR-ND	885.00	MA-306 18.4320M-C0:ROHS
19.66080	SER2704CT-ND	2.14	1.83	SER2704TR-ND	885.00	MA-306 19.6608M-C0:ROHS
20.00000	SER2705CT-ND	2.14	1.83	SER2705TR-ND	885.00	MA-306 20.000M-C0:ROHS
22.11840	SER2707CT-ND	2.14	1.83	SER2707TR-ND	885.00	MA-306 22.1184M-C0:ROHS
24.00000	SER2708CT-ND	2.14	1.83	SER2708TR-ND	885.00	MA-306 24.000M-C0:ROHS
24.57600	SER2709CT-ND	2.14	1.83	SER2709TR-ND	885.00	MA-306 24.5760M-C0:ROHS
25.00000	SER2710CT-ND	2.14	1.83	SER2710TR-ND	885.00	MA-306 25.000M-C0:ROHS
25.17500	SER2711CT-ND	2.14	1.83	SER2711TR-ND	885.00	MA-306 25.1750M-C0:ROHS
27.00000	SER2712CT-ND	2.14	1.83	SER2712TR-ND	885.00	MA-306 27.000M-C0:ROHS
28.00000	SER2713CT-ND	2.14	1.83	SER2713TR-ND	885.00	MA-306 28.000M-C0:ROHS
29.49120	SER2716CT-ND	2.14	1.83	SER2716TR-ND	885.00	MA-306 29.4912M-C0:ROHS
32.00000	SER2718CT-ND	2.14	1.83	SER2718TR-ND	885.00	MA-306 32.000M-C0:ROHS
40.00000	SER2725CT-ND	2.14	1.83	SER2725TR-ND	885.00	MA-306 40.000M-C0:ROHS

全部产品均以美元计价。 免费电话: 10800-1527031 (China Telecom - 中国电讯) — 10800-8527031 (CNCG - 中国网通)

# EPSON TOYOCOM 表面贴装石英晶体产品

特点：• 耐回流温度为 260°C，持续 20 秒 • 适用于当前的高密度表面贴装板

包装	FC-135	FC-255	MA-505	MA-506	MC-146	MC-156	MC-306	MC-405	MC-406
工作温度	-40°C ~ 85°C	-40°C ~ 85°C	-20°C ~ 70°C	-20°C ~ 70°C	-40°C ~ 85°C	-40°C ~ 85°C	-40°C ~ 85°C	-40°C ~ 85°C	-40°C ~ 85°C
最大驱动电平	0.5μW	0.5μW	10μW ~ 100μW	10μW ~ 100μW	1.0μW	1.0μW	1.0μW	1.0μW	1.0μW
频率公差	在 25°C 时为 ±20ppm	在 25°C 时为 ±20ppm	在 25°C 时为 ±50ppm	在 25°C 时为 ±50ppm	在 25°C 时为 ±20ppm	在 25°C 时为 ±20ppm	在 25°C 时为 ±20ppm	在 25°C 时为 ±20ppm	在 25°C 时为 ±20ppm
负载电容	12.5pF	12.5pF	18pF	18pF	9pF	12.5pF	A=12.5pF; E=6pF	12.5pF	12.5pF
串联电阻	最大 70KΩ	最大 65KΩ	—	—	最大 65KΩ	最大 65KΩ	最大 50KΩ	最大 50KΩ	最大 50KΩ
并联电容	标准 1.3pF	标准 1.3pF	最大 5pF	最大 5pF	0.8pF	—	最大 0.9pF	标准 0.85pF	0.85pF



图	系列	频率	Digi-Key 零件编号	剪切带 单价			Digi-Key 零件编号	带卷		Epson 零件编号
				1	10	50		数量	价格	
1	MA-505	4.00000 MHz	SE2518CT-ND	2.80	2.40	2.00	SE2518TR-ND	1,000	1330.00	MA-505 4.0000M-C0
		4.09600 MHz	SE2519CT-ND	2.80	2.40	2.00	SE2519TR-ND	1,000	1330.00	MA-505 4.0960M-C0
		4.91520 MHz	SE2520CT-ND	2.80	2.40	2.00	SE2520TR-ND	1,000	1330.00	MA-505 4.9152M-C0
		6.00000 MHz	SE2501CT-ND	1.12	.96	.80	SE2501TR-ND	1,000	530.00	MA-505 6.0000M-C0
		7.37280 MHz	SE2503CT-ND	1.12	.96	.80	SE2503TR-ND	1,000	530.00	MA-505 7.3728M-C0
		8.00000 MHz	SE2504CT-ND	1.12	.96	.80	SE2504TR-ND	1,000	530.00	MA-505 8.0000M-C0
		9.83000 MHz	SE2524CT-ND	1.12	.96	.80	SE2524TR-ND	1,000	530.00	MA-505 9.8300M-C0
		10.00000 MHz	SE2505CT-ND	1.12	.96	.80	SE2505TR-ND	1,000	530.00	MA-505 10.0000M-C0
		10.24000 MHz	SE2525CT-ND	1.12	.96	.80	SE2525TR-ND	1,000	530.00	MA-505 10.2400M-C0
		11.05920 MHz	SE2506CT-ND	1.12	.96	.80	SE2506TR-ND	1,000	530.00	MA-505 11.0592M-C0
		12.00000 MHz	SE2507CT-ND	1.12	.96	.80	SE2507TR-ND	1,000	530.00	MA-505 12.0000M-C0
		14.31800 MHz	SE2528CT-ND	1.12	.96	.80	SE2528TR-ND	1,000	530.00	MA-505 14.3180M-C0
		14.74560 MHz	SE2529CT-ND	1.12	.96	.80	SE2529TR-ND	1,000	530.00	MA-505 14.7456M-C0
		16.00000 MHz	SE2508CT-ND	1.12	.96	.80	SE2508TR-ND	1,000	530.00	MA-505 16.0000M-C0
		18.43200 MHz	SE2533CT-ND	1.12	.96	.80	SE2533TR-ND	1,000	530.00	MA-505 18.4320M-C0
		19.66000 MHz	SE2535CT-ND	1.12	.96	.80	SE2535TR-ND	1,000	530.00	MA-505 19.6600M-C0
		20.00000 MHz	SE2509CT-ND	1.12	.96	.80	SE2509TR-ND	1,000	530.00	MA-505 20.0000M-C0
		24.00000 MHz	SE2510CT-ND	1.12	.96	.80	SE2510TR-ND	1,000	530.00	MA-505 24.0000M-C0
		24.57600 MHz	SE2538CT-ND	1.12	.96	.80	SE2538TR-ND	1,000	530.00	MA-505 24.5760M-C0
		25.00000 MHz	SE2539CT-ND	1.12	.96	.80	SE2539TR-ND	1,000	530.00	MA-505 25.0000M-C0
	29.49120 MHz	SE2543CT-ND	1.12	.96	.80	SE2543TR-ND	1,000	530.00	MA-505 29.4912M-C0;(30T)	
	30.00000 MHz	SE2544CT-ND	1.12	.96	.80	SE2544TR-ND	1,000	530.00	MA-505 30.0000M-C0	
	32.76800 MHz	SE2546CT-ND	1.12	.96	.80	SE2546TR-ND	1,000	530.00	MA-505 32.7680M-C0	
	33.33300 MHz	SE2514CT-ND	1.12	.96	.80	SE2514TR-ND	1,000	530.00	MA-505 33.3330M-C0	
	36.00000 MHz	SE2548CT-ND	1.12	.96	.80	SE2548TR-ND	1,000	530.00	MA-505 36.0000M-C0	
	40.00000 MHz	SE2515CT-ND	1.12	.96	.80	SE2515TR-ND	1,000	530.00	MA-505 40.0000M-C0	
	MA-506	4.00000 MHz	SE2618CT-ND	2.80	2.40	2.00	SE2618TR-ND	1,000	1330.00	MA-506 4.0000M-C0
		4.09600 MHz	SE2619CT-ND	2.80	2.40	2.00	SE2619TR-ND	1,000	1330.00	MA-506 4.0960M-C0
		4.91520 MHz	SE2620CT-ND	2.80	2.40	2.00	SE2620TR-ND	1,000	1330.00	MA-506 4.9152M-C0
		6.00000 MHz	SE2601CT-ND	1.12	.96	.80	SE2601TR-ND	1,000	530.00	MA-506 6.0000M-C0
		6.14400 MHz	SE2602CT-ND	1.12	.96	.80	SE2602TR-ND	1,000	530.00	MA-506 6.1440M-C0
		7.37280 MHz	SE2603CT-ND	1.12	.96	.80	SE2603TR-ND	1,000	530.00	MA-506 7.3728M-C0
		8.00000 MHz	SE2604CT-ND	1.12	.96	.80	SE2604TR-ND	1,000	530.00	MA-506 8.0000M-C0
		9.83000 MHz	SE2624CT-ND	1.12	.96	.80	SE2624TR-ND	1,000	530.00	MA-506 9.8300M-C0
		10.00000 MHz	SE2605CT-ND	1.12	.96	.80	SE2605TR-ND	1,000	530.00	MA-506 10.0000M-C0
		10.24000 MHz	SE2625CT-ND	1.12	.96	.80	SE2625TR-ND	1,000	530.00	MA-506 10.2400M-C0
		11.00000 MHz	SE2626CT-ND	1.12	.96	.80	SE2626TR-ND	1,000	530.00	MA-506 11.0000M-C0
		11.05920 MHz	SE2606CT-ND	1.12	.96	.80	SE2606TR-ND	1,000	530.00	MA-506 11.0592M-C0
		12.00000 MHz	SE2607CT-ND	1.12	.96	.80	SE2607TR-ND	1,000	530.00	MA-506 12.0000M-C0
		12.28800 MHz	SE2627CT-ND	1.12	.96	.80	SE2627TR-ND	1,000	530.00	MA-506 12.2880M-C0
14.74560 MHz		SE2629CT-ND	1.12	.96	.80	SE2629TR-ND	1,000	530.00	MA-506 14.7456M-C0	

(转下页)

全部产品均以美元计价。 免费电话：10800-1527031 (China Telecom - 中国电讯) — 10800-8527031 (CNCG - 中国网通)

digikkey.com.cn — 电话：(852) 3104 0500 — 传真：(852) 3104 0686

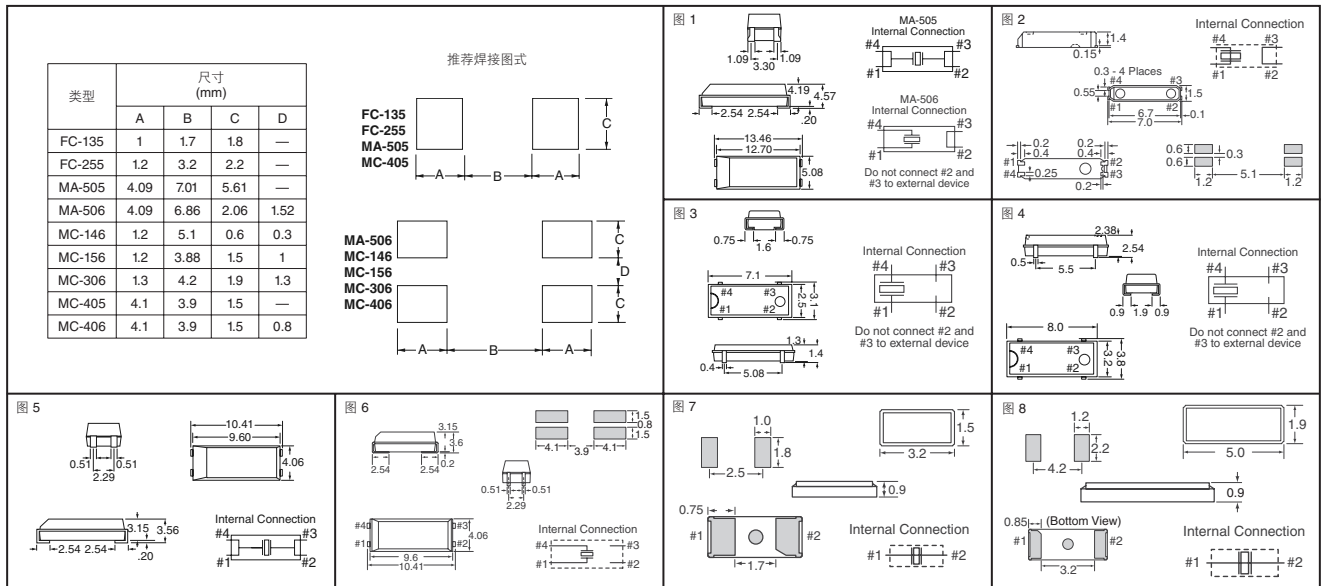
(CN082-09) 1505

D

图	系列	频率	Digi-Key 零件编号	剪切带 单价			Digi-Key 零件编号	带卷		Epson 零件编号
				1	50	100		数量	价格	
1	MA-506	15.00000 MHz	SE2630CT-ND	1.12	.96	.80	SE2630TR-ND	1,000	530.00	MA-506 15.0000M-C0
		16.00000 MHz	SE2608CT-ND	1.12	.96	.80	SE2608TR-ND	1,000	530.00	MA-506 16.0000M-C0
		16.25700 MHz	SE2631CT-ND	1.12	.96	.80	SE2631TR-ND	1,000	530.00	MA-506 16.2570M-C0
		18.00000 MHz	SE2632CT-ND	1.12	.96	.80	SE2632TR-ND	1,000	530.00	MA-506 18.0000M-C0
		18.43200 MHz	SE2633CT-ND	1.12	.96	.80	SE2633TR-ND	1,000	530.00	MA-506 18.4320M-C0
		19.66080 MHz	SE2635CT-ND	1.12	.96	.80	SE2635TR-ND	1,000	530.00	MA-506 19.6608M-C0
		20.00000 MHz	SE2609CT-ND	1.12	.96	.80	SE2609TR-ND	1,000	530.00	MA-506 20.0000M-C0
		20.48000 MHz	SE2636CT-ND	1.12	.96	.80	SE2636TR-ND	1,000	530.00	MA-506 20.4800M-C0
		22.11840 MHz	SE2637CT-ND	1.12	.96	.80	SE2637TR-ND	1,000	530.00	MA-506 22.1184M-C0
		24.00000 MHz	SE2610CT-ND	1.12	.96	.80	SE2610TR-ND	1,000	530.00	MA-506 24.0000M-C0
		24.57600 MHz	SE2638CT-ND	1.12	.96	.80	SE2638TR-ND	1,000	530.00	MA-506 24.5760M-C0
		25.00000 MHz	SE2639CT-ND	1.12	.96	.80	SE2639TR-ND	1,000	530.00	MA-506 25.0000M-C0
		27.00000 MHz	SE2641CT-ND	1.12	.96	.80	SE2641TR-ND	1,000	530.00	MA-506 27.0000M-C0;(FUND)
		28.63600 MHz	SE2642CT-ND	1.12	.96	.80	SE2642TR-ND	1,000	530.00	MA-506 28.6360M-C0;(30T)
		33.00000 MHz	SE2647CT-ND	1.12	.96	.80	SE2647TR-ND	1,000	530.00	MA-506 33.0000M-C0
		40.00000 MHz	SE2615CT-ND	1.12	.96	.80	SE2615TR-ND	1,000	530.00	MA-506 40.0000M-C0
		48.00000 MHz	SE2651CT-ND	1.12	.96	.80	SE2651TR-ND	1,000	530.00	MA-506 48.0000M-C0
		50.00000 MHz	SE2616CT-ND	1.12	.96	.80	SE2616TR-ND	1,000	530.00	MA-506 50.0000M-C0
		64.00000 MHz	SE2653CT-ND	1.23	1.05	.88	SE2653TR-ND	1,000	530.00	MA-506 64.0000M-C0
		2	MC-146	32.76800 kHz	SE2416CT-ND	1.40	1.20	1.00	SE2416TR-ND	250
3	MC-156	32.76800 kHz	SE2412CT-ND	1.30	1.11	.93	SE2412TR-ND	1,000	620.00	MC-156 32.7680KA-A0
4	MC-306	32.76800 kHz	SE2407CT-ND	.95	.81	.68	SE2407TR-ND	1,000	450.00	MC-306 32.7680K-A0
			SE2417CT-ND	.95	.81	.68	SE2417TR-ND	250	112.50	MC-306 32.768K-E3
5	MC-405	32.76800 kHz	SE2405CT-ND	.95	.81	.68	SE2405TR-ND	1,000	450.00	MC-405 32.7680K-A0
6	MC-406	32.76800 kHz	SE2418CT-ND	.95	.81	.68	SE2418TR-ND	250	112.50	MC-406 32.768K-A3
符合 RoHS 规范要求										
7	FC-135	32.76800 kHz	SE2413CT-ND	2.98	2.55	2.13	SE2413TR-ND	250	355.00	FC-135 32.7680KA-A3
8	FC-255	32.76800 kHz	SE2415CT-ND	1.86	1.59	1.33	SE2415TR-ND	250	220.00	FC-255 32.7680K-A3
1	MA-505	4.00000 MHz	SER2518CT-ND	2.80	2.40	2.00	SER2518TR-ND	1,000	1140.00	MA-505 4.0000M-C0:ROHS
		4.09600 MHz	SER2519CT-ND	2.80	2.40	2.00	SER2519TR-ND	1,000	1140.00	MA-505 4.0960M-C0:ROHS
		4.91520 MHz	SER2520CT-ND	2.80	2.40	2.00	SER2520TR-ND	1,000	1140.00	MA-505 4.9152M-C0:ROHS
		6.00000 MHz	SER2501CT-ND	1.12	.96	.80	SER2501TR-ND	1,000	480.00	MA-505 6.0000M-C0:ROHS
		7.37280 MHz	SER2503CT-ND	1.12	.96	.80	SER2503TR-ND	1,000	480.00	MA-505 7.3728M-C0:ROHS
		8.00000 MHz	SER2504CT-ND	1.12	.96	.80	SER2504TR-ND	1,000	480.00	MA-505 8.0000M-C0:ROHS
		9.83040 MHz	SER2524CT-ND	1.12	.96	.80	SER2524TR-ND	1,000	480.00	MA-505 9.8304M-C0:ROHS
		10.00000 MHz	SER2505CT-ND	1.12	.96	.80	SER2505TR-ND	1,000	480.00	MA-505 10.0000M-C0:ROHS
		11.05920 MHz	SER2506CT-ND	1.12	.96	.80	SER2506TR-ND	1,000	480.00	MA-505 11.0592M-C0:ROHS
		12.00000 MHz	SER2507CT-ND	1.12	.96	.80	SER2507TR-ND	1,000	480.00	MA-505 12.0000M-C0:ROHS
		14.31800 MHz	SER2528CT-ND	1.12	.96	.80	SER2528TR-ND	1,000	480.00	MA-505 14.3180M-C0:ROHS
		14.74560 MHz	SER2529CT-ND	1.12	.96	.80	SER2529TR-ND	1,000	480.00	MA-505 14.7456M-C0:ROHS
		16.00000 MHz	SER2508CT-ND	1.12	.96	.80	SER2508TR-ND	1,000	480.00	MA-505 16.0000M-C0:ROHS
		18.43200 MHz	SER2533CT-ND	1.12	.96	.80	SER2533TR-ND	1,000	480.00	MA-505 18.4320M-C0:ROHS
		19.66000 MHz	SER2535CT-ND	1.12	.96	.80	SER2535TR-ND	1,000	480.00	MA-505 19.6600M-C0:ROHS
		20.00000 MHz	SER2509CT-ND	1.12	.96	.80	SER2509TR-ND	1,000	480.00	MA-505 20.0000M-C0:ROHS
		24.00000 MHz	SER2510CT-ND	1.12	.96	.80	SER2510TR-ND	1,000	480.00	MA-505 24.0000M-C0:ROHS
		24.57600 MHz	SER2538CT-ND	1.12	.96	.80	SER2538TR-ND	1,000	480.00	MA-505 24.5760M-C0:ROHS
		25.00000 MHz	SER2539CT-ND	1.12	.96	.80	SER2539TR-ND	1,000	480.00	MA-505 25.0000M-C0:ROHS
		29.49120 MHz	SER2543CT-ND	1.12	.96	.80	SER2543TR-ND	1,000	480.00	MA-505 29.4912M-C0;(30T):ROHS
	30.00000 MHz	SER2544CT-ND	1.12	.96	.80	SER2544TR-ND	1,000	480.00	MA-505 30.0000M-C0:ROHS	
	40.00000 MHz	SER2515CT-ND	1.12	.96	.80	SER2515TR-ND	1,000	480.00	MA-505 40.0000M-C0:ROHS	
	MA-506	4.00000 MHz	SER2618CT-ND	2.80	2.40	2.00	SER2618TR-ND	1,000	1140.00	MA-506 4.0000M-C0:ROHS
		4.09600 MHz	SER2619CT-ND	2.80	2.40	2.00	SER2619TR-ND	1,000	1140.00	MA-506 4.0960M-C0:ROHS
		4.91520 MHz	SER2620CT-ND	2.80	2.40	2.00	SER2620TR-ND	1,000	1140.00	MA-506 4.9152M-C0:ROHS
		6.00000 MHz	SER2601CT-ND	1.12	.96	.80	SER2601TR-ND	1,000	480.00	MA-506 6.0000M-C0:ROHS
		6.14400 MHz	SER2602CT-ND	1.12	.96	.80	SER2602TR-ND	1,000	480.00	MA-506 6.1440M-C0:ROHS
		7.37280 MHz	SER2603CT-ND	1.12	.96	.80	SER2603TR-ND	1,000	480.00	MA-506 7.3728M-C0:ROHS
		8.00000 MHz	SER2604CT-ND	1.12	.96	.80	SER2604TR-ND	1,000	480.00	MA-506 8.0000M-C0:ROHS
		9.83000 MHz	SER2624CT-ND	1.12	.96	.80	SER2624TR-ND	1,000	480.00	MA-506 9.8300M-C0:ROHS
		10.00000 MHz	SER2605CT-ND	1.12	.96	.80	SER2605TR-ND	1,000	480.00	MA-506 10.0000M-C0:ROHS
		11.05920 MHz	SER2606CT-ND	1.12	.96	.80	SER2606TR-ND	1,000	480.00	MA-506 11.0592M-C0:ROHS
		12.00000 MHz	SER2607CT-ND	1.12	.96	.80	SER2607TR-ND	1,000	480.00	MA-506 12.0000M-C0:ROHS
		12.28800 MHz	SER2627CT-ND	1.12	.96	.80	SER2627TR-ND	1,000	480.00	MA-506 12.2880M-C0:ROHS
		14.31818 MHz	SER2628CT-ND	1.12	.96	.80	SER2628TR-ND	1,000	480.00	MA-506 14.31818M-C0:ROHS
		14.74560 MHz	SER2629CT-ND	1.12	.96	.80	SER2629TR-ND	1,000	480.00	MA-506 14.7456M-C0:ROHS
		16.00000 MHz	SER2608CT-ND	1.12	.96	.80	SER2608TR-ND	1,000	480.00	MA-506 16.0000M-C0:ROHS
		18.00000 MHz	SER2632CT-ND	1.12	.96	.80	SER2632TR-ND	1,000	480.00	MA-506 18.0000M-C0:ROHS
		18.43200 MHz	SER2633CT-ND	1.12	.96	.80	SER2633TR-ND	1,000	480.00	MA-506 18.4320M-C0:ROHS
		20.00000 MHz	SER2609CT-ND	1.12	.96	.80	SER2609TR-ND	1,000	480.00	MA-506 20.0000M-C0:ROHS
22.11840 MHz		SER2637CT-ND	1.12	.96	.80	SER2637TR-ND	1,000	480.00	MA-506 22.1184M-C0:ROHS	
24.00000 MHz		SER2610CT-ND	1.12	.96	.80	SER2610TR-ND	1,000	480.00	MA-506 24.0000M-C0:ROHS	
24.57600 MHz	SER2638CT-ND	1.12	.96	.80	SER2638TR-ND	1,000	480.00	MA-506 24.5760M-C0:ROHS		
25.00000 MHz	SER2639CT-ND	1.12	.96	.80	SER2639TR-ND	1,000	480.00	MA-506 25.0000M-C0:ROHS		
27.00000 MHz	SER2641CT-ND	1.12	.96	.80	SER2641TR-ND	1,000	480.00	MA-506 27.0000M-C0;(FUND):ROHS		
28.63600 MHz	SER2642CT-ND	1.12	.96	.80	SER2642TR-ND	1,000	480.00	MA-506 28.6360M-C0;(30T):ROHS		
32.76800 MHz	SER2646CT-ND	1.12	.96	.80	SER2646TR-ND	1,000	460.00	MA-506 32.7680M-C0:ROHS		
48.00000 MHz	SER2651CT-ND	1.12	.96	.80	SER2651TR-ND	1,000	480.00	MA-506 48.0000M-C0:ROHS		
64.00000 MHz	SER2653CT-ND	1.23	1.05	.88	SER2653TR-ND	1,000	525.00	MA-506 64.0000M-C0:ROHS		
2	MC-146	32.76800 kHz	SER2416CT-ND	1.40	1.20	1.00	SER2416TR-ND	250	163.00	MC-146 32.768KA-AC3:ROHS
3	MC-156	32.76800 kHz	SER2412CT-ND	1.30	1.11	.93	SER2412TR-ND	1,000	537.00	MC-156 32.7680KA-A0:ROHS
4	MC-306	32.76800 kHz	SER2407CT-ND	.95	.81	.68	SER2407TR-ND	1,000	413.00	MC-306 32.7680K-A0:ROHS
		32.76800 kHz	SER2417CT-ND	.95	.81	.68	SER2417TR-ND	250	116.75	MC-306 32.768K-E3:ROHS
6	MC-406	32.76800 kHz	SER2405CT-ND	.95	.81	.68	SER2405TR-ND	1,000	413.00	MC-406 32.7680K-A0:ROHS
		32.76800 kHz	SER2418CT-ND	.95	.81	.68	SER2418TR-ND	250	116.75	MC-406 32.768K-A3:ROHS

全部产品均以美元计价。 免费电话: 10800-1527031 (China Telecom - 中国电讯) — 10800-8527031 (CNCG - 中国网通)